



GUARDIAN Electric Manufacturing

ISO 9001 / AS9100 Certified Company

Woodstock, IL 60098 Ph. (815)334-3600 Fax (815)337-0377

Or visit us at our website www.guardian-electric.com

Model 28HD DC Frame Solenoid

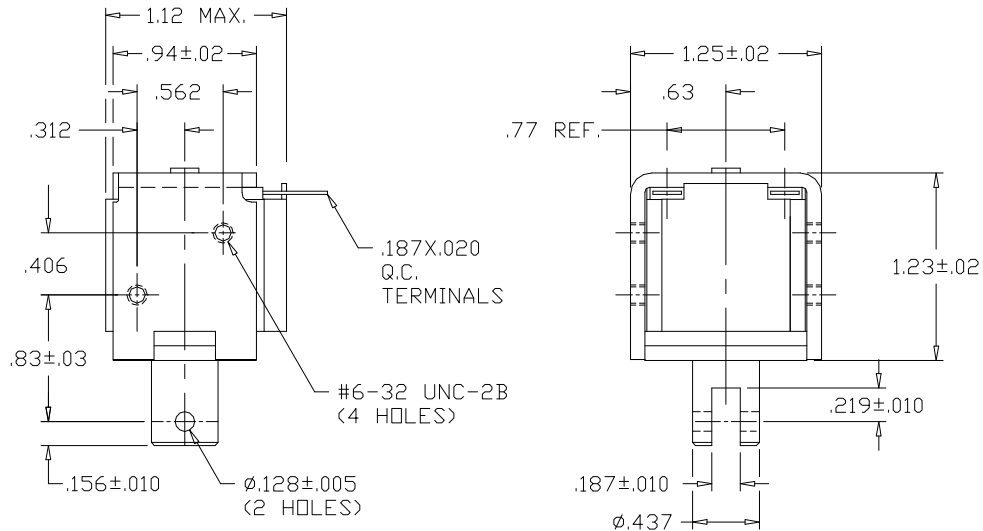

Solenoid shown energized and fully seated.

Spring kits are available (consult factory).

Total Weight: 4.7 oz.

Plunger Weight: .9 oz.

Model No.	Part No.	Duty Cycle	Voltage	Resistance (Ω)	Power (W)	Current (mA)
28HD-I-12D	A420-065963-00	Intermittent	12VDC	12.2	12.4	984
28HD-C-12D	A420-065962-00	Continuous	12VDC	30.1	5	399
28HD-I-24D	A420-065965-00	Intermittent	24VDC	49	12.3	490
28HD-C-24D	A420-065964-00	Continuous	24VDC	119	5.1	202

When ordering, please refer to Part No., as listed above.

Consult factory for custom configurations.

Stroke (in.)	Pull Force (oz.)								Holding Force (oz.)
	0.050	0.125	0.250	0.375	0.500	0.625	0.750	1.000	
Continuous Duty	30	12	6	4	1	n/a	n/a	n/a	130
Intermittent Duty	75	30	12	8	5	n/a	n/a	n/a	159

UL Recognition

Recognized under the  Component Recognition Program of **Underwriters Laboratories, Inc.**

Continuous Duty

100% 'On' Time

Intermittent Duty

25% 'On' Time, (100 Seconds 'On' Max. Followed By 300 Seconds 'Off' Min.)

RoHS

These parts comply with **RoHS** Directive 2002/95/EC