



3 FLANGE P C B MOUNTED POWER TRANSFORMERS

FEATURES

- 130°C Insulation System
- 2,500V RMS Hi-pot
- Dual Secondaries for Parallel or Series Connection
- Split Bobbin Construction with Center Flange Barrier Provides High Isolation, Low Leakage & Low Capacitance

FILE#
110331



130B



115 and 115/230V 50/60 Hz Primary Types

Part Number		Thordarson Inc. Single 115V	Thordarson Inc. Dual 115V/230V	VA Size	Secondary RMS Ratings	
Thordarson Meissner Single 115V	Dual 115V/230V				Series	Parallel
MIM321	MIM320	3FS-210-T3	FD-210-T	1.1	10V CT @ 10MA	5V @ 220MA
MIM323	MIM322	3FS-212-T3	FD-212-T	1.1	12.6V CT @ 90MA	6.3V @ 180MA
MIM325	MIM324	3FS-216-T3	FD-216-T	1.1	16V CT @ 70MA	8V @ 140MA
MIM327	MIM326	3FS-220-T3	FD-220-T	1.1	20V CT @ 55MA	10V @ 110MA
MIM329	MIM328	3FS-224-T3	FD-224-T	1.1	24V CT @ 45MA	12V @ 90MA
MIM331	MIM330	3FS-228-T3	FD-228-T	1.1	28V CT @ 40MA	14V @ 80MA
MIM333	MIM332	3FS-236-T3	FD-236-T	1.1	36V CT @ 30MA	18V @ 60MA
MIM335	MIM334	3FS-248-T3	FD-248-T	1.1	48V CT @ 23MA	24V @ 46MA
MIM337	MIM336	3FS-256-T3	FD-256-T	1.1	56V CT @ 20MA	28V @ 40MA
MIM339	MIM338	3FS-2120-T	3FD-2120-T	1.1	120V CT @ 10MA	60V @ 20MA
MIM421	MIM420	3FS-310-T3	FD-310-T	2.4	10V CT @ 250MA	5V @ 500MA
MIM423	MIM422	3FS-312-T3	FD-312-T	2.4	12.6V CT @ 200MA	6.3V @ 400MA
MIM425	MIM424	3FS-316-T3	FD-316-T	2.4	16V CT @ 150MA	8V @ 300MA
MIM427	MIM426	3FS-320-T3	FD-320-T	2.4	20V CT @ 120MA	10V @ 240MA
MIM429	MIM428	3FS-324-T3	FD-324-T	2.4	24V CT @ 100MA	12V @ 200MA
MIM431	MIM430	3FS-328-T3	FD-328-T	2.4	28V CT @ 85MA	14V @ 170MA
MIM433	MIM432	3FS-336-T3	FD-336-T	2.4	36V CT @ 65MA	18V @ 130MA
MIM435	MIM434	3FS-348-T3	FD-348-T	2.4	48V CT @ 50MA	24V @ 100MA
MIM437	MIM436	3FS-356-T3	FD-356-T	2.4	56V CT @ 45MA	28V @ 90MA
MIM439	MIM438	3FS-3120-T	3FD-3120-T	2.4	120V CT @ 20MA	60V @ 40MA
MIM521	MIM520	3FS-410-T3	FD-410-T	6	10V CT @ 600MA	5V @ 1.2A
MIM523	MIM522	3FS-412-T3	FD-412-T	6	12.6V CT @ 500MA	6.3V @ 1.0A
MIM525	MIM524	3FS-416-T3	FD-416-T	6	16V CT @ 400MA	8V @ 800MA
MIM527	MIM526	3FS-420-T3	FD-420-T	6	20V CT @ 300MA	10V @ 600MA
MIM529	MIM528	3FS-424-T3	FD-424-T	6	24V CT @ 250MA	12V @ 500MA
MIM531	MIM530	3FS-428-T3	FD-428-T	6	28V CT @ 200MA	14V @ 400MA
MIM533	MIM532	3FS-436-T3	FD-436-T	6	36V CT @ 170MA	18V @ 340MA
MIM535	MIM534	3FS-448-T3	FD-448-T	6	48V CT @ 125MA	24V @ 250MA
MIM537	MIM536	3FS-456-T3	FD-456-T	6	56V CT @ 110MA	28V @ 220MA
MIM539	MIM538	3FS-4120-T	3FD-4120-T	6	120V CT @ 50MA	60V @ 100MA
MIM621	MIM620	3FS-510-T3	FD-510-T	12	10V CT @ 1.2A	5V @ 2.4A
MIM623	MIM622	3FS-512-T3	FD-512-T	12	12.6V CT @ 1.0A	6.3V @ 2.0A
MIM625	MIM624	3FS-516-T3	FD-516-T	12	16V CT @ 800MA	8V @ 1.6A
MIM627	MIM626	3FS-520-T3	FD-520-T	12	20V CT @ 600MA	10V @ 1.2A
MIM629	MIM628	3FS-524-T3	FD-524-T	12	24V CT @ 500MA	12V @ 1.0A
MIM631	MIM630	3FS-528-T3	FD-528-T	12	28V CT @ 420MA	14V @ 840MA
MIM633	MIM632	3FS-536-T3	FD-536-T	12	36V CT @ 350MA	18V @ 700MA
MIM635	MIM634	3FS-548-T3	FD-548-T	12	48V CT @ 250MA	24V @ 500MA
MIM637	MIM636	3FS-556-T3	FD-556-T	12	56V CT @ 220MA	28V @ 440MA
MIM639	MIM638	3FS-5120-T	3FD-5120-T	12	120V CT @ 100MA	60V @ 200MA
MIM720	MIM721	N-A	N-A	20	10V CT @ 2.0A	5V @ 4.0A
MIM722	MIM723	N-A	N-A	20	12.6V CT @ 1.6A	6.3V @ 3.2A
MIM724	MIM725	N-A	N-A	20	16V CT @ 1.25A	8V @ 2.5A
MIM726	MIM727	N-A	N-A	20	20V CT @ 1.0A	10V @ 2.0A
MIM728	MIM729	N-A	N-A	20	24V CT @ 800MA	12V @ 1.6A
MIM730	MIM731	N-A	N-A	20	28V CT @ 700MA	14V @ 1.4A
MIM732	MIM733	N-A	N-A	20	36V CT @ 550MA	18V @ 1.1A
MIM734	MIM735	N-A	N-A	20	48V CT @ 400MA	24V @ 800MA
MIM736	MIM737	N-A	N-A	20	56V CT @ 350MA	28V @ 700MA
MIM738	MIM739	N-A	N-A	20	120V CT @ 160MA	60V @ 320MA
MIM820	MIM821	N-A	N-A	36	10V CT @ 3.6A	5V @ 7.20A
MIM822	MIM823	N-A	N-A	36	12.6V CT @ 2.85A	6.3V @ 5.7A
MIM824	MIM825	N-A	N-A	36	16V CT @ 2.25A	8V @ 4.5A
MIM826	MIM827	N-A	N-A	36	20V CT @ 1.8A	10V @ 3.6A
MIM828	MIM829	N-A	N-A	36	24V CT @ 1.5A	12V @ 3.0A
MIM830	MIM831	N-A	N-A	36	28V CT @ 1.3A	14V @ 2.6A
MIM832	MIM833	N-A	N-A	36	36V CT @ 1.0A	18V @ 2.0A
MIM834	MIM835	N-A	N-A	36	48V CT @ 750MA	24V @ 1.5A
MIM836	MIM837	N-A	N-A	36	56V CT @ 650MA	28V @ 1.3A
MIM838	MIM839	N-A	N-A	36	120V CT @ 300MA	60V @ 600MA

Dimensions in inches(mm)

MIM P/N Size	VA Size	Case			MTG MW	A	B	C	WT. lbs.
		H	L	W					
3XX	1.1	.938	1.375	1.125	—	1.200	.250	.250	.17
4XX	2.4	1.188	1.375	1.125	—	1.200	.250	.250	.25
5XX	6	1.313	1.625	1.312	1.062	1.280	.350	.350	.44
6XX	12	1.438	1.875	1.562	1.250	1.410	.300	.400	.70
7XX	20	1.438	2.250	1.875	1.500	1.600	.300	.400	.80
8XX	36	1.563	2.625	2.187	#	1.850	.400	.400	1.10

4 MTG holes 5/32 on 2-3/16 x 1-3/4 centers

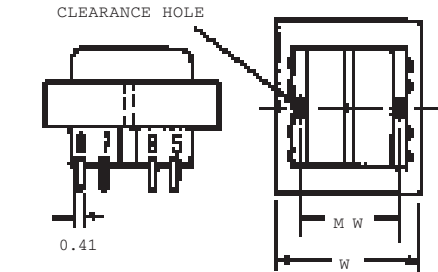
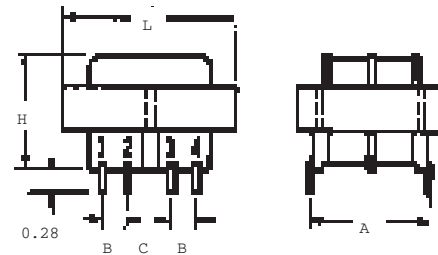

For Single Primary

For Dual Primary

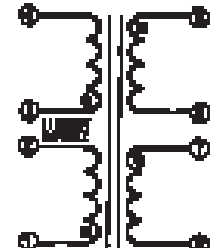
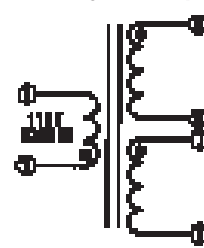

Basic 6 Pin
Single 115V

Basic 8 Pin
Dual 115/230V

■ Polarity

Dual Primary Transformers are designed for both primaries to be in series or parallel. Do not use as individual windings.

