









# Veeder-Root brand **EHM** Series



## Features and Benefits

-  Models in popular **Round and Rectangular packaging**.
-  Attractive **5mm, 6-digit LCD display** with hourglass operation indicator.
-  High reliability **non-volatile memory**.
-  Precise... **±0.1% accuracy**.
-  Broad voltage range, **9 to 32VDC operation**. Reverse-polarity and over-voltage protection.
-  Wide operating and storage **temperature range**.
-  Washdown safe, **sealed front panel**.

## SPECIFICATIONS

**Accuracy:** ±0.1%  
**Display:** 6-digit LCD, 5 mm high  
**Timing Indication:** Hourglass Icon  
**Operating Power (+V):** 9-32VDC @ 5mA max.  
**Non-Volatile Memory:** Exclusive Error Detection/Error Correction algorithm provides power off memory of data retention accuracy of less than ±0.1%.  
**Range & Resolution:** 99999.9 hours @ 0.1 hour resolution  
**Timing Activation Input:** Hourmeter runs during presence of 9-32VDC; will also provide operating voltage if none is applied to "+V" terminal  
**Termination:** Blade terminals; 1/4" on round case; 3/16" on rectangular case  
**EMC EMC Susceptibility:**  
 EN61000-4-2 for industrial environments  
 EN50082-1 for commercial and light industrial environments.  
 ISO13766:2006  
 SAE113  
**EMC Emissions**  
 EN50081-1 for light industrial environments  
 EN50081-2 for industrial environments  
 ISO7637-2  
 SAE113  
**Operating temperature:** -40°C to +85°C (LCD response may lag when below -20°C)  
**Storage Temperature** -40C to +85C (LCD freezes with permanent damage below -40C)  
**Humidity:** 5% to 90% RH non-condensing  
**Safety:** Low Voltage Directive Safety Requirements EN61010-1  
**Vibration:** SAE J 1378 20g  
**Mechanical Shock:** SAE J 1378 55g  
**Environmental Sealing:** NEMA4X

**Ideal for applications where equipment running time must be registered for maintenance and commercial purposes. Such as:**

- **Gas & Diesel Powered Generators, Air Compressors**
- **Construction and Mining Vehicles (Bulldozers, Backhoes, Cranes, etc)**
- **Off-Road Vehicles**
- **Specialty Vehicles**
- **On-Road Trucks**

**1000's of applications where its necessary to track equipment operating time**

## CONNECTIONS

Terminal	Description
+V	+ (9-32 VDC)
-V	- (GND)
S	Start Input + (9-32VDC)  Note: For two wire operation, connect +9-32VDC to "S" and - (GND) to "-V"

## MOUNTING DETAILS

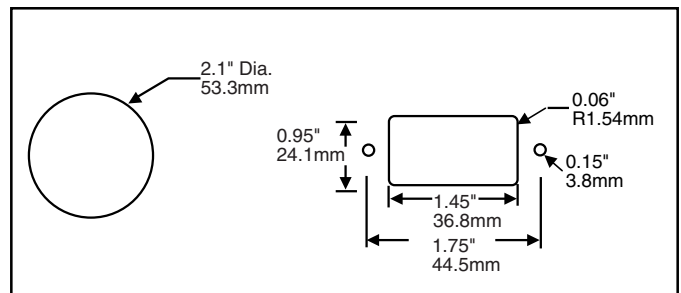



# Veeder-Root brand **EHM Series**

## DIMENSIONS

### EHM-100112

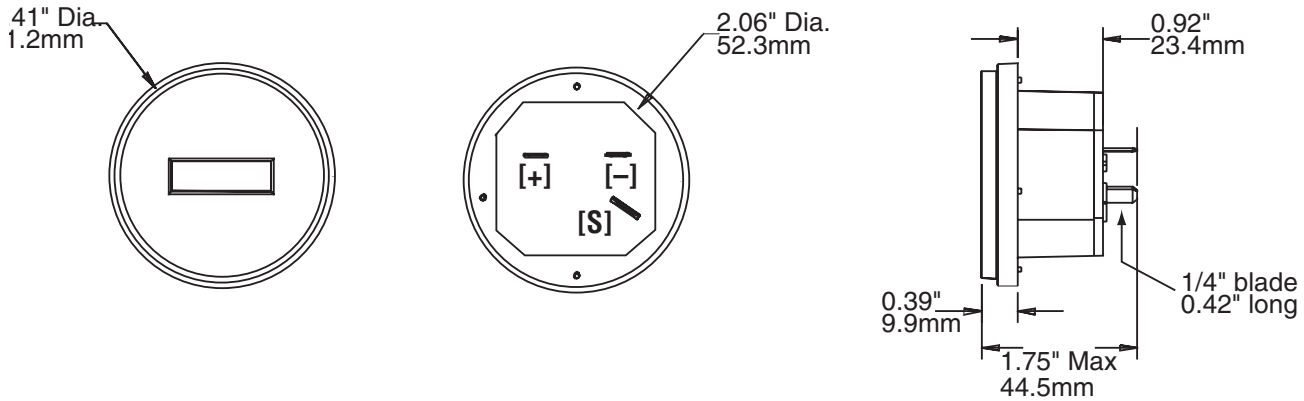

### EHM-200112

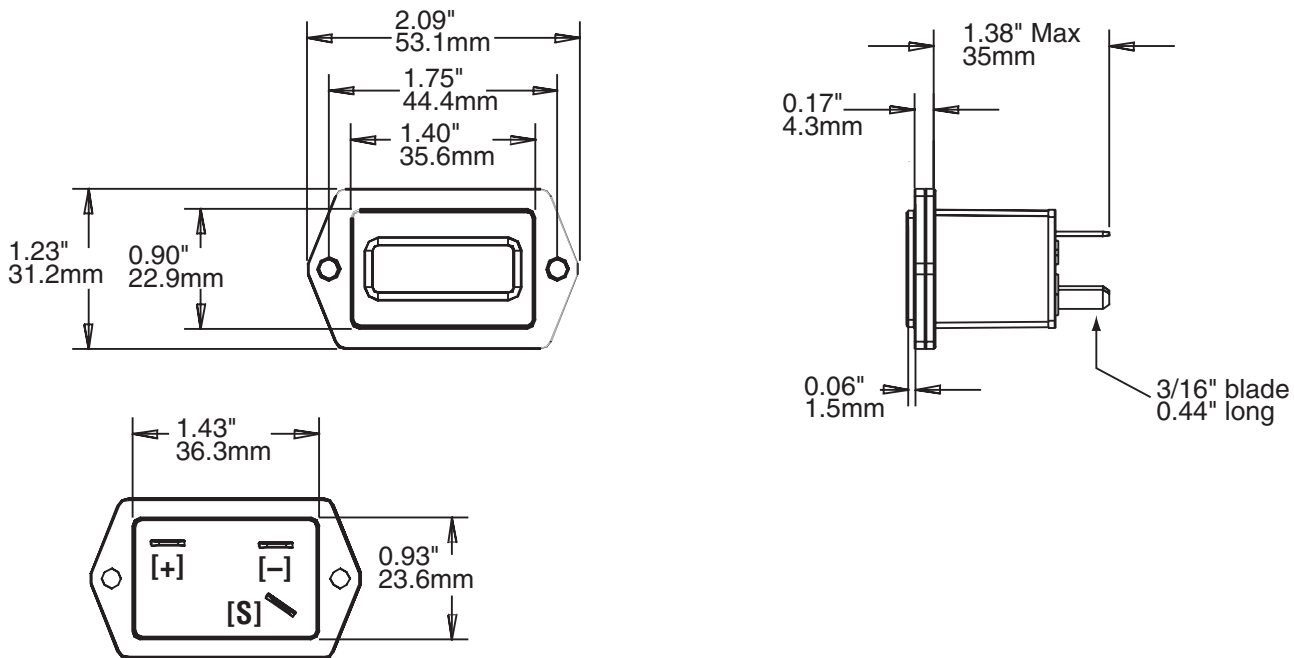

## ORDERING INFORMATION

Description	Part Number
Round Hour Meter 9-32VDC	<b>EHM-100112</b>
Rectangular Hour Meter 9-32VDC	<b>EHM-200112</b>