

SHC1026 -- Cord Connectors



Machined
Aluminum

Hubbell offers a full line of machined aluminum cord connectors in N.P.T. hub sizes 1/4" through 1" and cast aluminum 1" to 3". They provide durable performance and a clean attractive look without adding unwanted weight.

Product Specifications

Product Type	Cord Connectors
Material/Style	Aluminum
Cord Diameter Range	.50"- .63" (12.7-15.9)
Cord Connector Body Style	Straight Male
Form Size	F3
HUB Size	1/2"
Color Code	Brown
Effective Operating Temperature	-30°F to +225°F (34°C to +107°C)
Recommended Knockout Hole Size	.86"- .91" (21.8-23.0)
Flammability	Hubbell nylon cord connectors have a UL 94-V2 rating.
Hazardous Locations	Hubbell cord connectors are suitable for use in hazardous locations per Class I Div. 2, Class II Div. 1 & 2, Class III Div. 1 & 2 N.E.C. Reference 501-4(b), 502-4(a), 502-4(b), 503-3(a), and 503-3(b).
Dimension A	1.38" (35.1) Dia.
Dimension B	1.50" (38.1) Ref.
Dimension C	.55" (14.0)
Dimension D	.64" (16.3) Throat Dia.
Dimension E A/C	1.40" (35.6)

Dimension E A/F	1.25" (31.7)
Certifications	UL Listed in accordance with Standard 514B, CSA Certified, United States Coast Guard Approval, Title 46-Part 111.
M Drawings	Click here for M-Drawing
Catalog Page	Click here for catalog page T76
Catalog Section	Click here for Section-T
UPC Number	78358520026
Weight in LBs	0.22

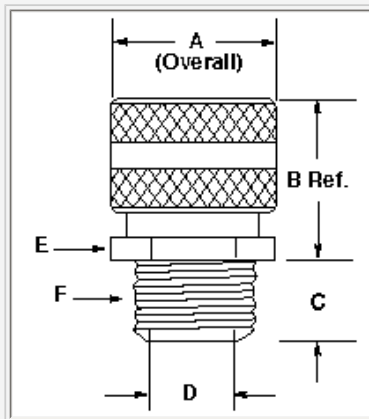

Cord Connectors

Straight Male

Form Size 1-3

Machined
AluminumMachined
Zinc-Plated Steel

UL Listed to Type 4, 4X, 12 and Type 13

IP66*
SUITABILITY

N.P.T. Hub Size	Cord Dia. Inches (mm)	Form Size	Color Code	Machined Aluminum	Machined Zinc-Plated Steel	Stainless Steel	Nylon Gray	Black
1/4"	.06"-.13" (1.6-3.2)	F1	Green	•	•	•	SHC1001CR	•
	.13"-.19" (3.2-4.7)		Orange	SHC1002	•	•	SHC1002CR	•
	.19"-.25" (4.7-6.3)		Red	SHC1003	•	SHC1003SS	SHC1003CR	•
	.25"-.31" (6.3-7.9)		Black	SHC1004	•	SHC1004SS	SHC1004CR	•
	.31"-.38" (7.9-9.5)		White	SHC1005**	•	•	SHC1005CR	SHC2005CR
	.38"-.44" (9.5-11)		Blue	•	•	•	SHC1006CR	•
3/8"	.06"-.13" (1.6-3.2)	F1	Green	SHC1007	•	•	•	•
	.13"-.19" (3.2-4.7)		Orange	SHC1008	SHC1008ZP	•	SHC1008CR	SHC2008CR
	.19"-.25" (4.7-6.3)		Red	SHC1009	•	SHC1009SS	SHC1009CR	•
	.25"-.31" (6.3-7.9)		Black	SHC1010	SHC1010ZP	•	SHC1010CR	SHC2010CR
	.31"-.38" (7.9-9.5)		White	SHC1011	•	SHC1011SS	SHC1011CR	SHC2011CR
	.38"-.44" (9.5-11.0)		Blue	SHC1012	SHC1012ZP	SHC1012SS	SHC1012CR	SHC2012CR
1/2"	.19"-.25" (4.7-6.3)	F1	Red	SHC1015	•	•	•	•
	.25"-.31" (6.3-7.9)		Black	SHC1016	•	•	•	•
	.31"-.38" (7.9-9.5)		White	SHC1017	•	•	•	•
	.38"-.44" (9.5-11.0)		Blue	SHC1018	•	•	•	•
1/2"	.06"-.13" (1.6-3.2)	F2	Green	SHC1019	•	•	SHC1019CR	•
	.13"-.19" (3.2-4.7)		Orange	SHC1020	SHC1020ZP	SHC1020SS	SHC1020CR	•
	.19"-.25" (4.7-6.3)		Red	SHC1021	SHC1021ZP	SHC1021SS	SHC1021CR	SHC2021CR
	.25"-.38" (6.3-9.7)		White	SHC1022	SHC1022ZP	SHC1022SS	SHC1022CR	SHC2022CR
	.38"-.50" (9.7-12.7)		Blue	SHC1023	SHC1023ZP	SHC1023SS	SHC1023CR	SHC2023CR
	.50"-.62" (12.7-15.9)		Brown	SHC1024	SHC1024ZP	SHC1024SS	SHC1024CR**	SHC2024CR**
1/2"	.38"-.50" (9.7-12.7)	F3	Blue	SHC1025	•	•	•	•
	.50"-.63" (12.7-15.9)		Brown	SHC1026	•	•	•	•
	.63"-.75" (15.9-19.0)		Yellow	SHC1027**	SHC1027ZP**	•	•	•
	.75"-.88" (19.0-22.2)		Orchid	SHC1028**	SHC1028ZP**	•	•	•

Note: See pages T-87 to T-98 for additional technical data and dimensional drawings.

*IP66 Suitability when used with optional metal clad O-ring shown on page T-83.

**Cable jacket may have to be stripped to pass through connector body.