

Product Number: 3117-2-00-21-00-00-08-0

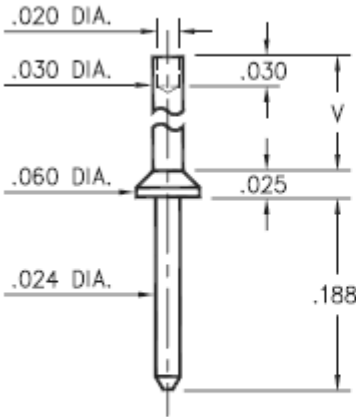

Basic Part Number	Board Thickness	Length V
3117-1	.031	.047
3117-2	.062	.078
3117-3	.094	.110
3117-4	.125	.141

Description:

3117 - Swage Terminal Pin

Packaging:

Packaged in Bulk

3117-X-00-XX-00-00-08-0
Swage mount in .035 hole

Mill-Max Part Number	Shell Plating	Contact Plating	RoHS Compliant
3117-2-00-21-00-00-08-0	20 μ" Gold over Nickel	00	

SHELL MATERIAL:

BRASS ALLOY (UNS C36000) per ASTM B 16

Properties of BRASS ALLOY:

- Chemical composition: Cu 61.5%, Zn 35.4%, Pb 3.1%†
- Hardness as machined: 80-90 Rockwell B
- Density: .307 lbs/in³
- Electrical conductivity: 26% IACS*
- Melting point: 900°C/885°C (liquidus/solidus)

†(3 to 4% lead is used to permit "free machining" and is permitted by EC Directive 2002/95Annex 6; so all pin materials are RoHS compliant)

*International Annealed Copper Standard, i.e. as a % of pure copper.

3117

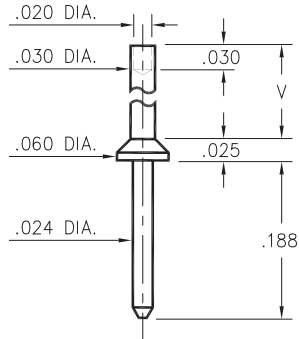

Basic Part Number	Board Thickness	Length V
3117-1	.031	.047
3117-2	.062	.078
3117-3	.094	.110
3117-4	.125	.141

3117-X-00-XX-00-00-08-0
Swage mount in .035 hole

3114/3115

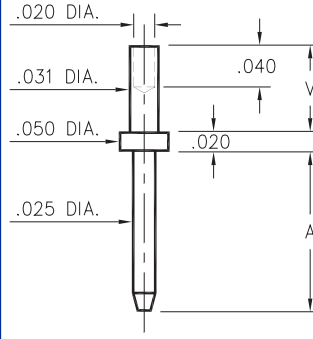

Basic Part Number	Board Thickness	Length A	Length V
3114-1	.031	.150	.051
3114-2	.062	.150	.082
3115-1	.031	.300	.051
3115-2	.062	.300	.082

311X-X-00-XX-00-00-08-0
Swage mount in .035 mounting hole

3112

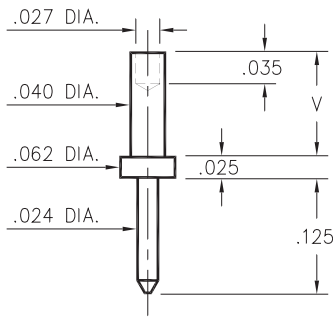

Basic Part Number	Board Thickness	Length V
3112-1	.031	.051
3112-2	.062	.082
3112-3	.094	.113

3112-X-00-XX-00-00-08-0
Swage mount in .043 hole

3118/3119

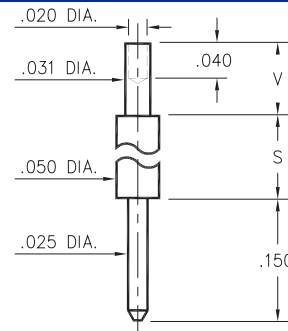

Basic Part Number	Board Thickness	Length S	Length V
3118-1	.031	.170	.051
3118-2	.062	.170	.082
3119-1	.031	.420	.051
3119-2	.062	.420	.082

311X-X-00-XX-00-00-08-0
Swage mount in .035 hole

3139

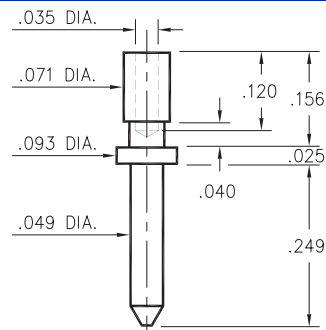

3139-0-00-XX-00-00-08-0
Wire Termination

3602

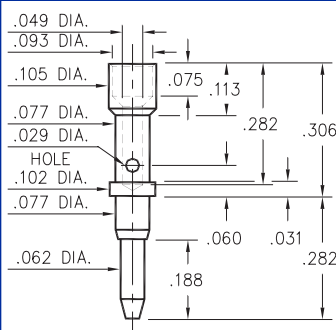

3602-0-07-XX-00-00-08-0
Annealed
#20 Crimp barrel

3131

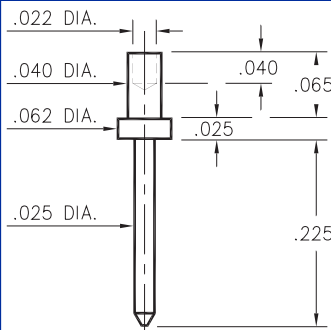

3131-1-00-XX-00-00-08-0
Swage mount in .043 hole

0912

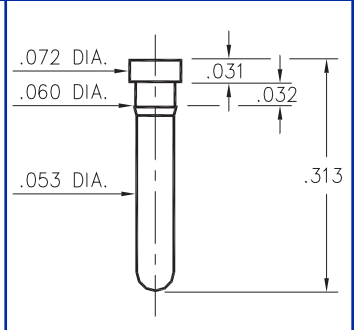

0912-0-00-XX-00-00-03-0
Press-fit in .057 mounting hole

SPECIFICATIONS

PIN MATERIAL:
Brass Alloy 360, 1/2 Hard
(Except Swage pins which are annealed)

DIMENSION IN INCHES
TOLERANCES ON:
LENGTHS: ±.005
DIAMETERS: ±.002
ANGLES: ± 2°

ORDER CODE: XXXX - X - 0X - XX - 00 - 00 - 0X - 0

BASIC PART #



SPECIFY PIN FINISH:

- 01 200μ" TIN/LEAD OVER NICKEL
- 80 200μ" TIN OVER NICKEL
- 15 10μ" GOLD OVER NICKEL
- 21 20μ" GOLD OVER NICKEL
- 34 50μ" GOLD OVER NICKEL