

DC - 3 WIRE-STANDARD



**M8 Stainless Steel (SS), M12 Brass, Nickel Plated (BN),
Cylindrical, Threaded, 10-30V DC, 250mA,
LED for Output Energized**



- IEC (529) IP67 (NEMA 1, 3, 4, 6, 12, 13) Protection
- Short Circuit Protection
- Overload Protection
- Reverse Polarity Protection
- Wire Break Resistance
- Transient Voltage Protection
- Temperature Range: -25 to 70°C (-13 to 158°F)

M8 Flush Mount

M12 Flush Mount

| Sensing Distance | | 1.5mm (0.06 in.) | | 2mm (.08 in.) | |
|-----------------------------------|--|-------------------|--------------------|------------------|-------------------|
| Cable or Connector Style Cat. No. | | Cable | 65 | Cable | 65 |
| PNP | Normally Open  | AIS08F1.5AP024-2M | AIS08F1.5AP024-Q65 | AIS12F02AP024-2M | AIS12F02AP024-Q65 |
| | Complementary NO/NC*  | | | AIS12F02UP024-2M | AIS12F02UP024-Q65 |
| NPN | Normally Open  | AIS08F1.5AN024-2M | AIS08F1.5AN024-Q65 | AIS12F02AN024-2M | AIS12F02AN024-Q65 |
| | Complementary NO/NC*  | | | AIS12F02UN024-2M | AIS12F02UN024-Q65 |
| Ripple Voltage | | ≤ 10% | | ≤ 10% | |
| Voltage Range | | 10-30V | | 10-30V | |
| No-Load Current | | ≤ 11 mA | | ≤ 15mA | |
| Max. Load Current | | 250 mA | | 250 mA | |
| Voltage Drop Across Sensor | | ≤ 1.3V | | ≤ 2.5V | |
| Max. Leakage Current | | ≤ 1 µA | | 1µA | |
| Switching Frequency | | 2000 Hz | | 1000 Hz | |
| Hysteresis | | ≤ 0.15mm | | ≤ 0.2mm | |
| Temperature Drift | | ≤ ±3µm/K | | ±4µm/K | |
| Repeatability | | ≤ 0.05mm | | ≤ 0.1mm | |

Fixed Cable

PVC 2m (6ft. 6in.). For other cable lengths and/or PUR cable, please consult Altech. M8 is supplied with stainless steel locknuts and M12 is supplied with brass, nickel plated locknuts.

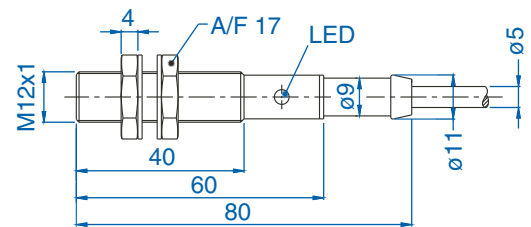
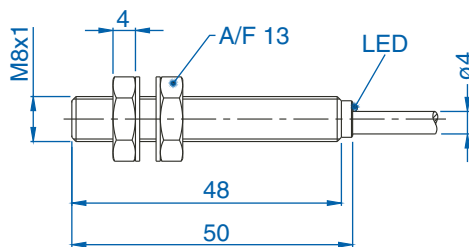

65 Style Connector

4-pin, Micro style, 12mm (.47 in.). M8 is supplied with stainless steel locknuts and M12 is supplied with brass, nickel plated locknuts.

