

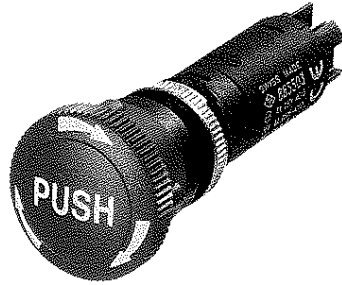

IP66/IP67

Panel cut-out 16.2 mm



- mushroom cap Ø 24 mm
- positive opening operation
- light action, suitable for smaller equipment
- faston terminals 2.8 x 0.5 mm
- weight: 13.8 g

	mushroom cap with printing	mushroom cap without printing
1NC+1NO	880 003 000	880 103 000
2NC	880 004 000	880 104 000

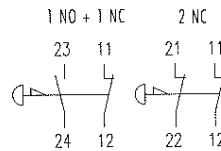
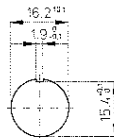
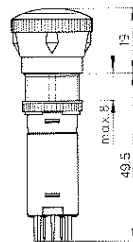

Subject to change without notice

Actuating force	Approx. 6 N pushbutton switches Approx. 32 N emergency stop switches Approx. 25 N mushroom switches												
Fixation	Pushbutton switches: central, with metal fixation nut; flat bezel fixation also with mounting frame Key and rotary switches / emergency stop switches / mushroom switches: central, with metal fixation nut Mushroom switches with key reset: central, with anti-rotation device and metal fixation nut												
Protective system	Generally: IP66/IP67, exception: mushroom switch IP40 with key reset												
Bezel material	Thermoplast or nickel plated brass												
Lens material	Thermoplast (polycarbonate in different colours) engravable												
Illumination	T 1 1/4 Bi-Pin lamps max. 60V 0.7W Please respect the safety regulations when using the indicator light.												
Ambient temperature	-25° upto +55°C Heat congestion should be avoided												
Life expectancy mechanical operating cycles	<table border="0"> <tr> <td>Pushbutton switches:</td> <td>Key, rotary and mushroom switches:</td> <td>Emergency stop:</td> <td>Mushroom switch with key:</td> </tr> <tr> <td>1'000'000</td> <td>50'000</td> <td>30'000</td> <td>25'000</td> </tr> </table>	Pushbutton switches:	Key, rotary and mushroom switches:	Emergency stop:	Mushroom switch with key:	1'000'000	50'000	30'000	25'000				
Pushbutton switches:	Key, rotary and mushroom switches:	Emergency stop:	Mushroom switch with key:										
1'000'000	50'000	30'000	25'000										
Contact block 6A	factory fitted onto the switch												
Casing material	Thermoplast												
Terminal material	Silver nickel, 0.4 µm gold plated												
Contact resistance	< 30 mOhm												
Number of contacts	<table border="0"> <tr> <td>Pushbutton, key and rotary switches:</td> <td>Emergency stop switches and mushroom switches:</td> </tr> <tr> <td>1NC + 1NO</td> <td>1NC + 1NO</td> </tr> <tr> <td>2NC</td> <td>2NC</td> </tr> <tr> <td>2NO</td> <td></td> </tr> </table> <p>circuits independent of each other circuits independent of each other</p>	Pushbutton, key and rotary switches:	Emergency stop switches and mushroom switches:	1NC + 1NO	1NC + 1NO	2NC	2NC	2NO					
Pushbutton, key and rotary switches:	Emergency stop switches and mushroom switches:												
1NC + 1NO	1NC + 1NO												
2NC	2NC												
2NO													
Terminals	Faston terminals 2.8x0.5 mm for faston plugs according to DIN 46247 Please respect the installation regulations!												
Switching mechanism	<table border="0"> <tr> <td>Pushbutton, key and rotary switches: self cleaning snap-action contacts bounce time < 1 msec</td> <td>Emergency stop and mushroom switches: self cleaning contacts with positive opening operation, bounce time < 1 msec</td> </tr> </table>	Pushbutton, key and rotary switches: self cleaning snap-action contacts bounce time < 1 msec	Emergency stop and mushroom switches: self cleaning contacts with positive opening operation, bounce time < 1 msec										
Pushbutton, key and rotary switches: self cleaning snap-action contacts bounce time < 1 msec	Emergency stop and mushroom switches: self cleaning contacts with positive opening operation, bounce time < 1 msec												
Contact gap	> 3 mm												
Switching capacity	6A, 230V AC, utilization category AC-15 according to IEC 947-5-1, recommended miniature breaker type C 6A												
Life expectancy electrical	<table border="0"> <tr> <td>20'000 operating cycles</td> <td>50'000 operating cycles</td> <td>100'000 operating cycles</td> <td>300'000 operating cycles</td> </tr> <tr> <td>-</td> <td>6A 250V AC12</td> <td>-</td> <td>2.5A 250V AC12</td> </tr> <tr> <td>10A 24V DC13</td> <td>5A 24V DC13</td> <td>5A 12V DC13</td> <td>-</td> </tr> </table>	20'000 operating cycles	50'000 operating cycles	100'000 operating cycles	300'000 operating cycles	-	6A 250V AC12	-	2.5A 250V AC12	10A 24V DC13	5A 24V DC13	5A 12V DC13	-
20'000 operating cycles	50'000 operating cycles	100'000 operating cycles	300'000 operating cycles										
-	6A 250V AC12	-	2.5A 250V AC12										
10A 24V DC13	5A 24V DC13	5A 12V DC13	-										