

## Brilliance by design

### High Flux LED Model 600

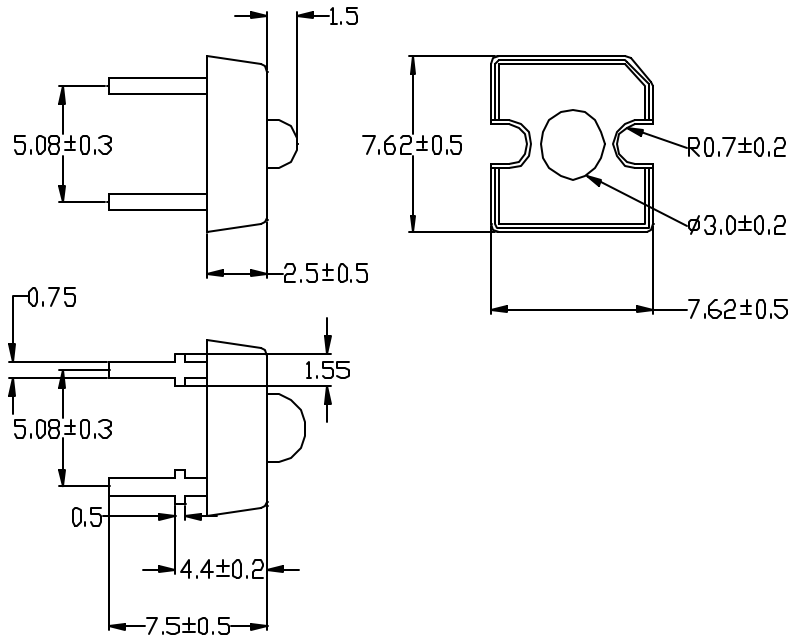

Reverse Voltage:	5 Volt
Reverse Current (Vr=5V):	10A
Operating Temperature Range:	-40° C - +80° C
Storage Temperature Range:	-40° C - +100° C
Lead Soldering Temperature:	260° C for
(1.6mm(1/16inch) from body)	5 seconds

Ta=25° C

Part No.	Chip		Wave Length	Lens Color	View Angle (deg)	Electro-Optical Characteristics				
	Raw	Emitted				Vf (V)		If mA	Iv (mIm)	
	Material	Color				Typ.	Max.		Min	Typ.
SL600WCE	GaN	Pure White	-	Water Clear	70	3.6	4.0	20	250	500
SL600RCE	AlGaInP	Super Red	639	Water Clear	70	2.31	2.9	70	500	1310
SL600ACE	AlGaInP	Super Amber	621	Water Clear	70	2.31	2.9	70	500	1310
SL600YCE	AlGaInP	Super Yellow	591	Water Clear	70	2.31	2.9	70	500	1310
SL600GCE	GaN	Super Green	525	Water Clear	70	3.6	4.0	20	250	400
SL600BCE	GaN	Super Blue	475	Water Clear	60	3.6	4.0	20	250	400