

Part Number **HSR-V10K** Contact Form A Switch Configuration SPST Rev. F
10,000 VDC Breakdown Voltage

Features	Advantages
<ul style="list-style-type: none"> • Hermetically sealed contacts • Tungsten contacts in vacuum environment • Leaded glass currently exempted from RoHS requirements • Voltage breakdown determined with maximum of 2 μA leakage current 	<ul style="list-style-type: none"> • Extended operations in extreme environments • Not ESD sensitive • High voltage holdoff and switching ability • Suitable for high/inductive current loads • Voltage holdoff increases at upper end of pull-in range

Electrical Specifications

Power		Watts - maximum	50
Voltage	Switching	VDC - maximum	7500
	Breakdown	VDC - minimum	10000
Current	Switching	Amp - maximum	3
	Carry	Amp - maximum	4.0
Resistance	Initial Contact Resistance	Ohm - maximum	0.10
	Insulation Resistance	Ohm - minimum	1 E11
Capacitance	Contact	pF - typical	1.0
Temperature	Operating	$^{\circ}$ C	-60 to +125
	Storage	$^{\circ}$ C	-100 to +200

Magnetic Specifications

Pull - In Range		Ampere Turns	100-150
Test Coil		NARM RS-421-A	Coil III

Physical/Operational Specifications

Capsule Volume	Excluding Leads	CC - nominal	1.22
Contact Material			Tungsten
Operate Time	Including Bounce	mSeconds - maximum	3.20
Release Time	Including Bounce	mSeconds - maximum	1.50

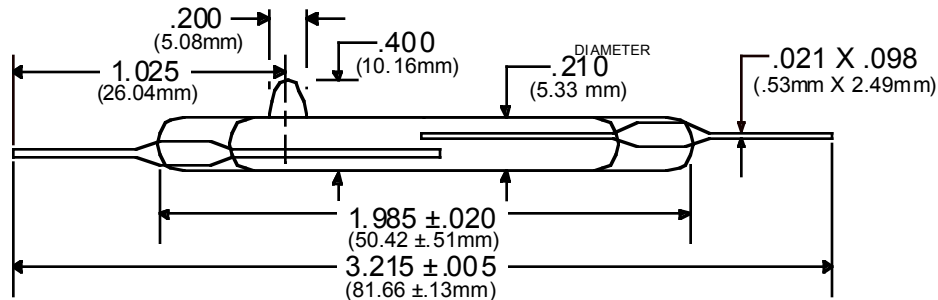
Notes:

- (1) Specifications are not constant across entire magnetic range.
- (2) Customer must exercise care in handling, mounting, lead forming, and cutting to prevent damage to glass capsule and/or switch sensitivity.
- (3) For information or custom configurations about performance, mounting options or packaging, contact our Sales department.
- (4) Information contained hereon is for informational purposes only and should not be deemed as accurate for a specific application. Consult factory for specific application information and/or latest revision.