

## SHC1018 -- Cord Connectors



Machined  
Aluminum

Hubbell offers a full line of machined aluminum cord connectors in N.P.T. hub sizes 1/4" through 1" and cast aluminum 1" to 3". They provide durable performance and a clean attractive look without adding unwanted weight.

### Product Specifications

<b>Product Type</b>	Cord Connectors
<b>Material/Style</b>	Aluminum
<b>Cord Diameter Range</b>	.38" - .44" (9.5-11.0)
<b>Cord Connector Body Style</b>	Straight Male
<b>Form Size</b>	F1
<b>HUB Size</b>	1/2"
<b>Color Code</b>	Blue
<b>Effective Operating Temperature</b>	-30°F to +225°F (34°C to +107°C)
<b>Recommended Knockout Hole Size</b>	.86" - .91" (21.8-23.0)
<b>Flammability</b>	Hubbell nylon cord connectors have a UL 94-V2 rating.
<b>Hazardous Locations</b>	Hubbell cord connectors are suitable for use in hazardous locations per Class I Div. 2, Class II Div. 1 & 2, Class III Div. 1 & 2 N.E.C. Reference 501-4(b), 502-4(a), 502-4(b), 503-3(a), and 503-3(b).
<b>Dimension A</b>	.88" (22.4) Dia.
<b>Dimension B</b>	.90" (22.9) Ref.
<b>Dimension C</b>	.46" (11.7)
<b>Dimension D</b>	.44" (11.2) Throat Dia.
<b>Dimension E A/C</b>	1.00" (25.4)

<b>Dimension E A/F</b>	.88" (22.4)
<b>Certifications</b>	UL Listed in accordance with Standard 514B, CSA Certified, United States Coast Guard Approval, Title 46-Part 111.
<b>M Drawings</b>	<a href="#">Click here for M-Drawing</a>
<b>Catalog Page</b>	<a href="#">Click here for catalog page T76</a>
<b>Catalog Section</b>	<a href="#">Click here for Section-T</a>
<b>UPC Number</b>	78358520018
<b>Weight in LBs</b>	0.1

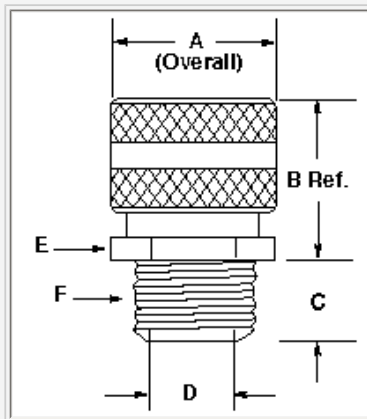

# Cord Connectors

## Straight Male

Form Size 1-3



**Machined  
Aluminum**



**Machined  
Zinc-Plated Steel**

UL Listed to Type 4, 4X, 12 and Type 13



**IP66\***  
SUITABILITY

N.P.T. Hub Size	Cord Dia. Inches (mm)	Form Size	Color Code	Machined Aluminum	Machined Zinc-Plated Steel	Stainless Steel	Nylon Gray	Black
1/4"	.06"-.13" (1.6-3.2)	F1	Green	•	•	•	SHC1001CR	•
	.13"-.19" (3.2-4.7)		Orange	SHC1002	•	•	SHC1002CR	•
	.19"-.25" (4.7-6.3)		Red	SHC1003	•	SHC1003SS	SHC1003CR	•
	.25"-.31" (6.3-7.9)		Black	SHC1004	•	SHC1004SS	SHC1004CR	•
	.31"-.38" (7.9-9.5)		White	SHC1005**	•	•	SHC1005CR	SHC2005CR
	.38"-.44" (9.5-11)		Blue	•	•	•	SHC1006CR	•
3/8"	.06"-.13" (1.6-3.2)	F1	Green	SHC1007	•	•	•	•
	.13"-.19" (3.2-4.7)		Orange	SHC1008	SHC1008ZP	•	SHC1008CR	SHC2008CR
	.19"-.25" (4.7-6.3)		Red	SHC1009	•	SHC1009SS	SHC1009CR	•
	.25"-.31" (6.3-7.9)		Black	SHC1010	SHC1010ZP	•	SHC1010CR	SHC2010CR
	.31"-.38" (7.9-9.5)		White	SHC1011	•	SHC1011SS	SHC1011CR	SHC2011CR
	.38"-.44" (9.5-11.0)		Blue	SHC1012	SHC1012ZP	SHC1012SS	SHC1012CR	SHC2012CR
1/2"	.19"-.25" (4.7-6.3)	F1	Red	SHC1015	•	•	•	•
	.25"-.31" (6.3-7.9)		Black	SHC1016	•	•	•	•
	.31"-.38" (7.9-9.5)		White	SHC1017	•	•	•	•
	.38"-.44" (9.5-11.0)		Blue	SHC1018	•	•	•	•
1/2"	.06"-.13" (1.6-3.2)	F2	Green	SHC1019	•	•	SHC1019CR	•
	.13"-.19" (3.2-4.7)		Orange	SHC1020	SHC1020ZP	SHC1020SS	SHC1020CR	•
	.19"-.25" (4.7-6.3)		Red	SHC1021	SHC1021ZP	SHC1021SS	SHC1021CR	SHC2021CR
	.25"-.38" (6.3-9.7)		White	SHC1022	SHC1022ZP	SHC1022SS	SHC1022CR	SHC2022CR
	.38"-.50" (9.7-12.7)		Blue	SHC1023	SHC1023ZP	SHC1023SS	SHC1023CR	SHC2023CR
	.50"-.62" (12.7-15.9)		Brown	SHC1024	SHC1024ZP	SHC1024SS	SHC1024CR**	SHC2024CR**
1/2"	.38"-.50" (9.7-12.7)	F3	Blue	SHC1025	•	•	•	•
	.50"-.63" (12.7-15.9)		Brown	SHC1026	•	•	•	•
	.63"-.75" (15.9-19.0)		Yellow	SHC1027**	SHC1027ZP**	•	•	•
	.75"-.88" (19.0-22.2)		Orchid	SHC1028**	SHC1028ZP**	•	•	•

Note: See pages T-87 to T-98 for additional technical data and dimensional drawings.

\*IP66 Suitability when used with optional metal clad O-ring shown on page T-83.

\*\*Cable jacket may have to be stripped to pass through connector body.