

Part Number **HSR-156W** Contact Form   A   Switch Configuration   SPST   Rev.   D  

**100 Watt Power Rated Switch**

Features	Advantages
<ul style="list-style-type: none"> <li>• Hermetically sealed contacts</li> <li>• Offset gap construction</li> <li>• Solid Tungsten contacts</li> <li>• Leaded glass currently exempted from RoHS requirements</li> </ul>	<ul style="list-style-type: none"> <li>• Not ESD sensitive</li> <li>• Outstanding performance in permanent magnet applications</li> <li>• Excellent performance with either inductive or capacitive loads</li> <li>• Capable of switching power loads between 3 and 100 watts</li> </ul>

**Electrical Specifications**

Power		Watts - maximum	100
Voltage	Switching	VDC - maximum	120
	Breakdown	VDC - minimum	700
Current	Switching	Amp - maximum	3
	Carry	Amp - maximum	5
Resistance	Initial Contact Resistance	Ohm - maximum	0.50
	Insulation Resistance	Ohm - minimum	1 E10
Capacitance	Contact	pF - typical	1.1
Temperature	Operating	°C	-40 to +125
	Storage	°C	-40 to +200

**Magnetic Specifications**

Pull - In Range		Ampere Turns	50-100
Test Coil		NARM RS-421-A	Coil III

**Physical/Operational Specifications**

Capsule Volume	Excluding Leads	CC - nominal	0.75
Contact Material			Tungsten Bar and Plate
Operate Time	Including Bounce	mSeconds - maximum	4.00
Release Time	Including Bounce	mSeconds - maximum	1.10

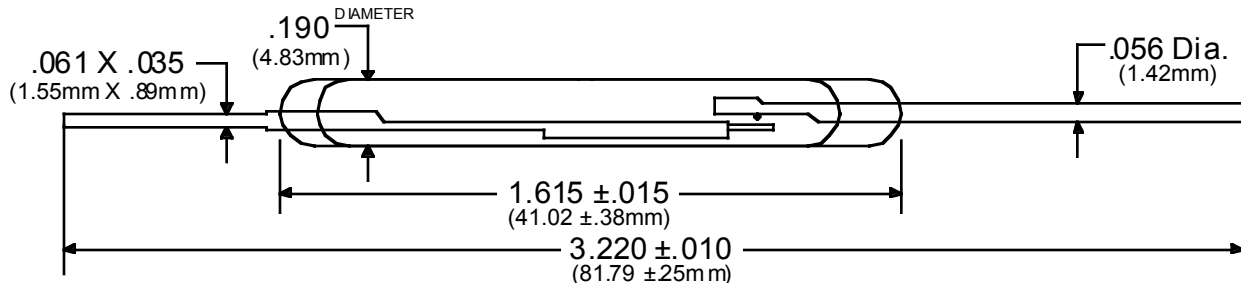

- Notes:
- (1) Specifications are not constant across entire magnetic range.
  - (2) Customer must exercise care in handling, mounting, lead forming, and cutting to prevent damage to glass capsule and/or switch sensitivity.
  - (3) For information or custom configurations about performance, mounting options or packaging, contact our Sales department.
  - (4) Information contained hereon is for informational purposes only and should not be deemed as accurate for a specific application. Consult factory for specific application information and/or latest revision.