

Dimensions: mm (In.)

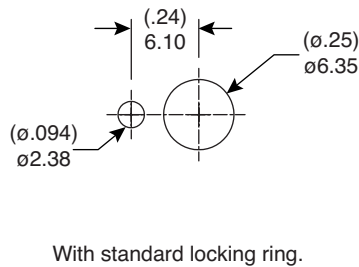

Panel Mounting

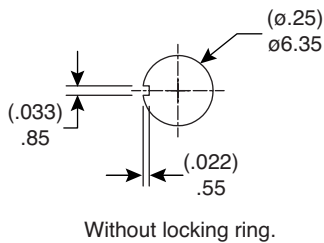
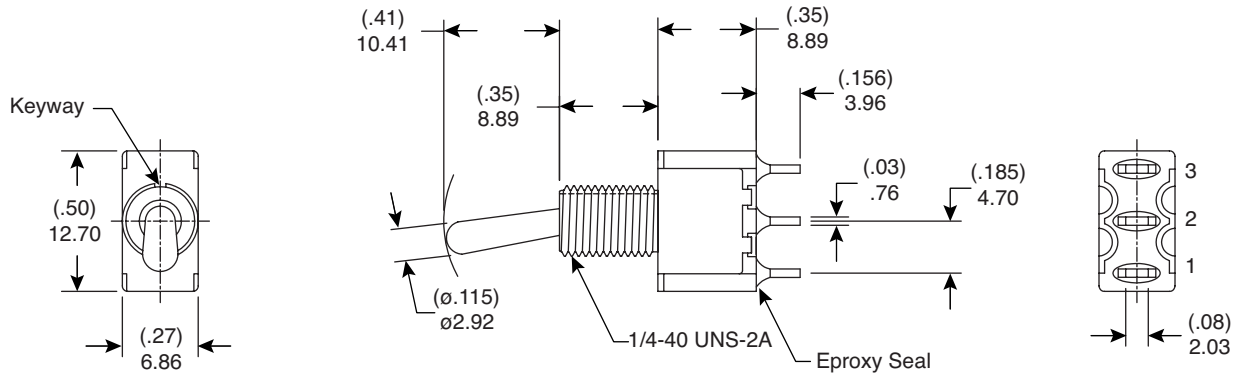
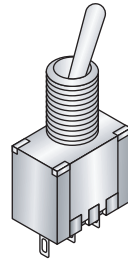
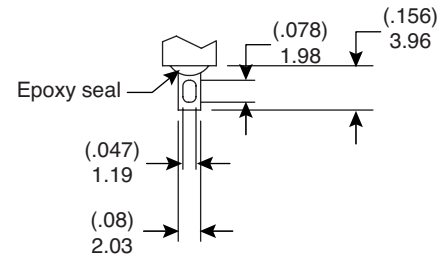

Solder Lug

**Electrical Specifications:**

- Rating: 2A / 250VAC, 5A / 120 VAC or 28 VDC
- Contact Resistance: 10mΩ max. initial @ 2-4VDC 100mA
- Insulation Resistance: 1,000MΩ min.
- Dielectric Strength: 1,000 V RMS@sea level

**Materials:**

- Case: Diallyl phthalate (DAP)(UL94V-0)
- Actuator: Brass, chrome plated
- Bushing: Brass, nickel plated
- Housing: Stainless Steel
- Terminal/Contact: Silver or gold plated

**Mechanical Specifications:**

- Mechanical Life: 40,000 make-and-break cycles
- Operating Temperature: -30°C to 85°C

Mountain Switch Part No.	Type	Circuit
20126SPST01	SPST	On-Off
20126SPDT02	SPDT	On-Off-(On)
20126SPDT03	SPDT	(On)-Off-(On)

Miniature Toggle Switches  
20126SPST01, 20126SPDT02, 20126SPDT03

