



Adjustable Range & Fixed-focus Reflective Photoelectric Sensor

The EQ-500 series of photoelectric sensors provides a long-range diffuse reflective solution that is suitable for applications where it is not feasible to get close to the sensing object. The sensor is impervious to changes in an object's angle, gloss, or even color, so you get an accurate detection every time. Built in an IP-67 rated enclosure, the EQ-500 series is also good for use in harsh environments. The sensing range is easily adjustable to a maximum of 2.5m (1m version also available). There are two main product types available:





Multi-Voltage Type

- Can be powered with 24-240VAC or 12-240VDC. This free ranging input allows for nearly any power source in the world to be used.
- 1 Form A relay output is used which is suitable for direct switching of a load up to 3A 250VAC (resistive) or 3A 30VDC (resistive).

DC-Voltage Type

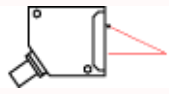
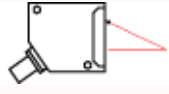
- Powered by 12-24 VDC
- NPN and PNP transistor outputs are used.
- Equipped with Background and Foreground suppression to eliminate the effects of unwanted objects and provides more stability in your sensing operation.

All models are also available with a built-in ON or OFF delay timer function.

Model Name	Model Pic	Type	Output Operation	Output Configuration	Emitting Element	Max. Range (mm)	Max. Range (in)
Sort ▲ ▼		Sort ▲ ▼	Sort ▲ ▼	Sort ▲ ▼	Sort ▲ ▼	Sort ▲ ▼	Sort ▲ ▼
EQ-501		Multi-voltage, Long Sensing, Adjustable Range	Light-ON/Dark-ON	Relay Contact 1a	Infrared LED	2500	98.4
EQ-501T		Multi-voltage, Long Sensing, Adjustable Range w/ Timer	Light-ON/Dark-ON	Relay Contact 1a	Infrared LED	2500	98.4
EQ-502		Multi-voltage, Long Sensing, Adjustable Range	Light-ON/Dark-ON	Relay Contact 1a	Infrared LED	1000	39.4
EQ-502T		Multi-voltage, Long Sensing, Adjustable Range w/Timer	Light-ON/Dark-ON	Relay Contact 1a	Infrared LED	1000	39.4
EQ-511		DC-voltage Long sensing Adjustable Range, BGS/FGS	Light-ON/Dark-ON	NPN/PNP	Infrared LED	2500	98.4

DIMENSIONS (Unit: mm in)

EQ-501(T) EQ-502(T)
EQ-511(T) EQ-512(T) Sensor

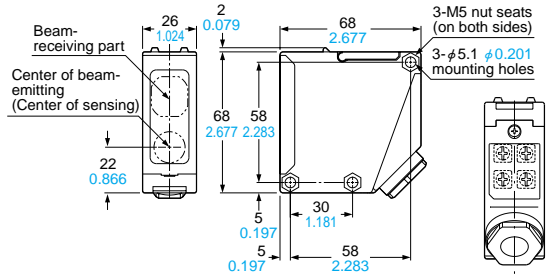
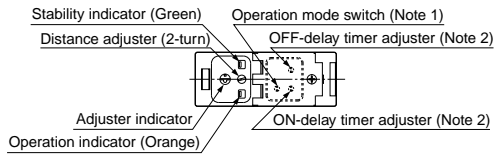

Notes: 1) The operation mode switch of the DC-voltage type is the DIP switch.
2) EQ-5□T does not incorporate those.

Assembly dimensions with sensor mounting bracket MS-EQ5-01 (Optional) (Foot angled mounting)

