

4

3

2

1

THIS DRAWING IS UNPUBLISHED. RELEASED FOR PUBLICATION. ALL RIGHTS RESERVED.

LOC	DIST	REVISIONS		DATE	BY	APP'D
P	LTR	DESCRIPTION				
AD	00			11MAR11	RK	HMR
A4		REVISED PER ECO-11-004587				

NOTES:

- ALL MATERIALS AND FINISHES SHALL COMPLY WITH EU DIRECTIVE 2002/95/EC OF 27JAN2003 (ROHS).
- EACH SWITCH WITH THREADED BUSHINGS SUPPLIED WITH THE FOLLOWING MOUNTING HARDWARE:
  - INTERNAL TOOTH LOCKWASHER
  - LOCATING RING
- G CONTACT OPTION CAN BE USED FOR SIGNAL OR POWER LEVEL SWITCHING. IF SWITCH IS USED AT LEVELS EXCEEDING .4VA @ 20V AC/DC, SWITCH IS RENDERED FOR POWER SWITCHING ONLY DUE TO ARC REMOVAL OF GOLD PLATING. RATING STAMPED ON FRAME IS 2A 250VAC, 5A 120VAC.

- △ DATE CODE AND COUNTRY OF ORIGIN MAY APPEAR ON EITHER SIDE OF SWITCH.  
 △ LENGTH OF TOGGLE REDUCED BY .020 WITH A, AV2, V30 OR V40 VERTICAL SUPPORT BRACKET OPTIONS.

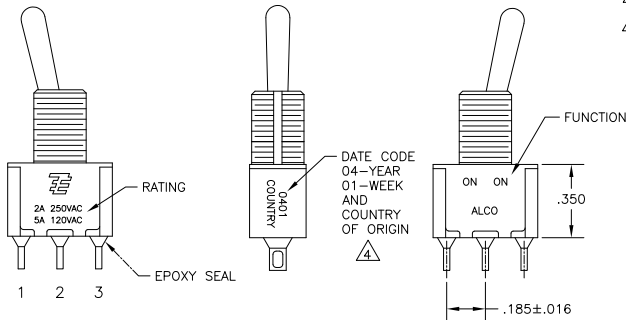
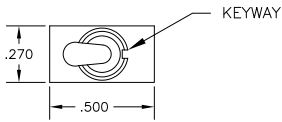

FUNCTION	1 2 3	1 2 3	1 2 3
03	ON	OFF	ON
05	(ON)	OFF	(ON)
07	ON	OFF	(ON)
TERMINALS CONNECTED	2-3	---	1-2

None: No mechanical position  
 Off: Mechanical position with no electrical connection  
 (On): Momentary action

RATING, B CONTACTS	.4VA MAX @20V MAX. AC OR DC
RATING, G CONTACTS—SEE NOTE 3	.4VA MAX @20V MAX. AC OR DC OR 5A @120 VAC OR 28 VDC (RESISTIVE)
RATING, Q CONTACTS	2A @250 VAC (RESISTIVE) 5A @120 VAC OR 28 VDC (RESISTIVE)
ELECTRICAL LIFE	6,000 CYCLES AT RATED LOAD
CONTACT RESISTANCE	10 MILLIOHMS MAX INITIAL @ 2-4VDC, 100ma
INSULATION RESISTANCE	1,000 MEGOHMS MIN
DIELECTRIC WITHSTANDING VOLTAGE	1,000 V RMS AT SEA LEVEL
OPERATING TEMPRATURE	-30C TO 85C

MODEL	FUNCTION	TOGGLE	BUSHING	TERMINAL	CONTACT	RoHS
A1	03	K	CW	A	B	04
	05	K1	D	AV2	G	
	07	L	D9	C	Q	
		L1	H	V30		
		L2	Y	V40		
		M	Y9	W		
		P3		W4		
		S		Z		
		T		Z3		
		T1				

EXAMPLE: A103SYCQ04

THIS DRAWING IS A CONTROLLED DOCUMENT.

DESIGNED BY: M. ZITTO	DATE: 10/14/03	TE Connectivity
CHECKED BY: M. ZITTO	DATE: 10/14/03	
APPROVED BY: M. ZITTO	DATE: 10/14/03	
PRODUCT SPEC: ---	APPLICATION SPEC: ---	SIZE: A2
WEIGHT: ---	REVISION: ---	CAGE CODE: 00779
MATERIAL: ---	FINISH: ---	DRAWING NO: 1825137
		RESTRICTED TO: ---
		CUSTOMER DRAWING

SCALE: 3:1 SHEET: 1 of 4 REV: A4

4

3

2

1

THIS DRAWING IS UNPUBLISHED. RELEASED FOR PUBLICATION. ALL RIGHTS RESERVED.

### TOGGLES

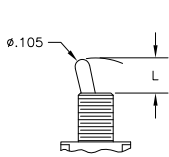

**M** SHORT

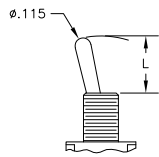

**S** STANDARD

DIM L	BUSHING TYPE	DIM L	BUSHING TYPE
.200	Y, H	.410	Y, H
.270	D, D9	.480	D, D9

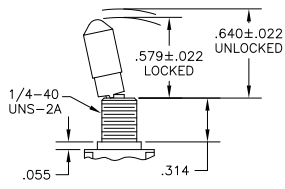

**K** NO BUSHING OPTION NEEDED

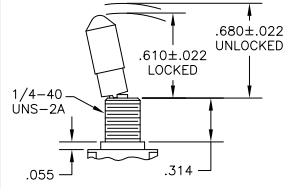

**K1** NO BUSHING OPTION NEEDED

REV	DATE	BY	APP'D	DESCRIPTION
1				SEE SHEET 1

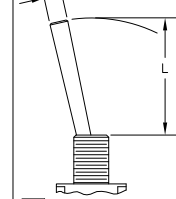

**L** LEVER

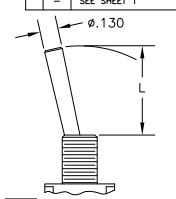

**L1** LEVER

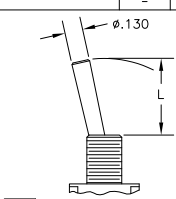

**L2** LEVER

DIM L	BUSHING TYPE	DIM L	BUSHING TYPE	DIM L	BUSHING TYPE
.840	Y, H	.640	Y, H	.550	Y, H
.910	D, D9	.710	D, D9	.620	D, D9

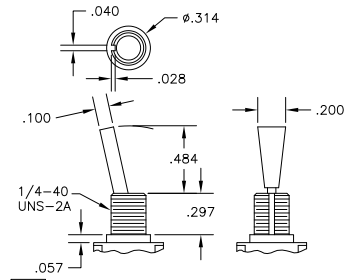

**P3** NO BUSHING OPTION NEEDED

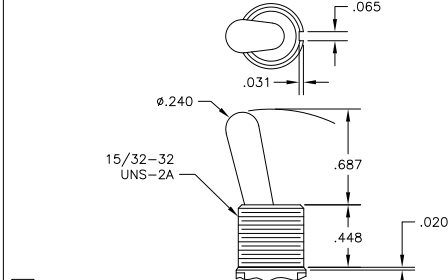

**T** NO BUSHING OPTION NEEDED

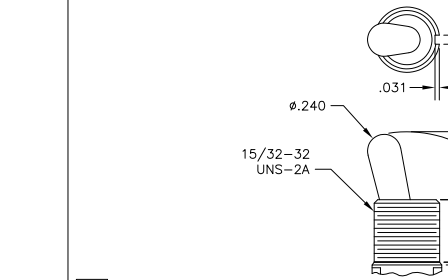

**T1** NO BUSHING OPTION NEEDED

### BUSHINGS

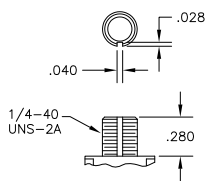

**D** THREADED  
**D9** UNTHREADED

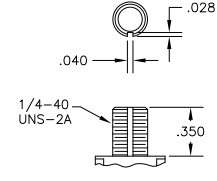

**Y** THREADED  
**Y9** UNTHREADED

CONTAINS O-RING BETWEEN TOGGLE AND BUSHING AND BETWEEN BUSHING AND PANEL

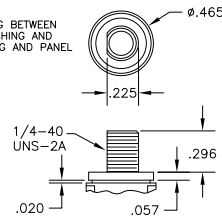

**CW** THREADED SPLASHPROOF

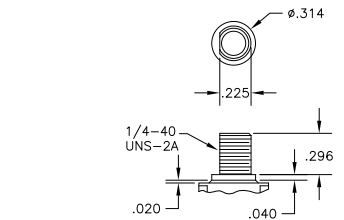

**H** HIGH TORQUE

THIS DRAWING IS A CONTROLLED DOCUMENT.

DIMENSIONS:	TOLERANCES UNLESS OTHERWISE SPECIFIED:
INCHES	
Ø	PLC ± .005
PLC	± .005
PLC	± .010
PLC	± .010
ANGLES	± .5°
FINISH	

DESIGN	DESIGNED BY	DATE	REV	DESCRIPTION
M. ZITTO	M. ZITTO			GEMINI A SERIES TOGGLE SWITCH, SINGLE POLE, 3 POSITION FUNCTIONS (03, 05 & 07)

TE Connectivity

SIZE: A2 CAGE CODE: 00779 DRAWING NO: 1825137

CUSTOMER DRAWING SCALE: 2:1 SHEET: 2 of 4 REV: A4

4

3

2

1

THIS DRAWING IS UNPUBLISHED. RELEASED FOR PUBLICATION  
 © COPYRIGHT - By - ALL RIGHTS RESERVED.

LOC	DIST	REVISIONS		
P	LTR	DESCRIPTION	DATE	BY
AD	00	SEE SHEET 1	-	-

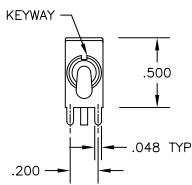

**AV2** VERTICAL RIGHT ANGLE  $\triangle$

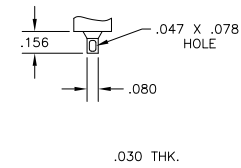
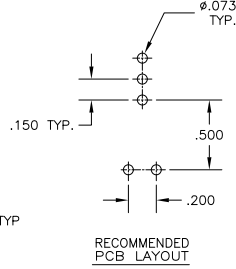
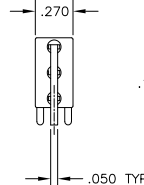
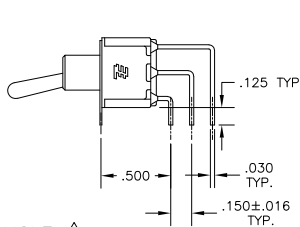

**Z** WIRE LUG

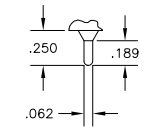

**Z3** QUICK CONNECT

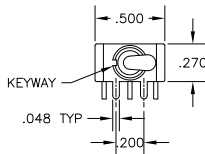

**A** RIGHT ANGLE  $\triangle$

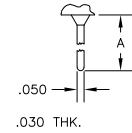
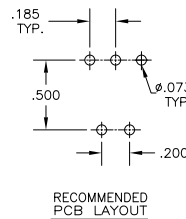
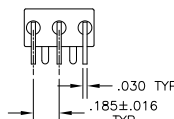
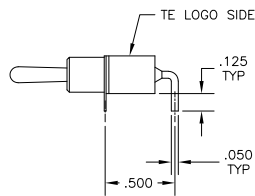

**W W4** WIRE WRAP

OPTION	DIM A
W	.736
W4	1.062

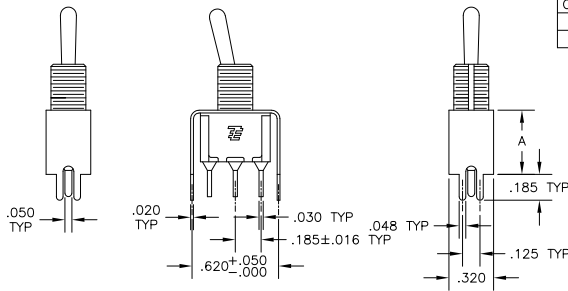

**V30 V40**  $\triangle$   
 VERTICAL SUPPORT BRACKET

OPTION	DIM A
V30	.460
V40	.630

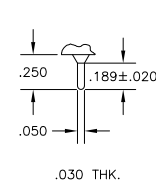
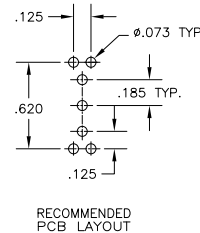

**C** PRINTED CIRCUIT

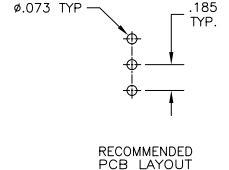

THIS DRAWING IS A CONTROLLED DOCUMENT.

DESIGNED BY: M. ZITTO	DATE: 10/14/05	 TE Connectivity
CHECKED BY: M. ZITTO	DATE: 10/14/05	
APPROVED BY: M. ZITTO	DATE: 10/14/05	GEMINI A SERIES TOGGLE SWITCH, SINGLE POLE, 3 POSITION FUNCTIONS (03, 05 & 07)
PRODUCT SPEC: -	DATE: -	
APPLICATION SPEC: -	DATE: -	SIZE: A2
WEIGHT: -	DATE: -	CAGE CODE: 00779
MATERIAL: -	DATE: -	DRAWING NO: C=1825137
FINISH: -	DATE: -	RESTRICTED TO: -
CUSTOMER DRAWING		SCALE: 2:1
		SHEET: 3 of 4
		REV: A4

4

3

2

1

THIS DRAWING IS UNPUBLISHED. RELEASED FOR PUBLICATION. ALL RIGHTS RESERVED.

LOC	DIST	REVISIONS	
AD	00	P LTR	DESCRIPTION
		DATE	BY
		---	---
		SEE SHEET 1	

Alco P/N	P/N	
A103KZQ04	1825137-1	
A103MD9AB04	1825137-2	
A103MD9AG04	1825137-3	
A103MD9AQ04	1825137-4	
A103MD9AV2B04	1825137-5	
A103P3ZQ04	1825137-6	
A103SD9AQ04	1825137-7	
A103SD9AV2B04	1825137-8	
A103SD9AV2Q04	1825137-9	
A103SDCB04	1-1825137-0	
A103SDCCQ04	1-1825137-1	
A103SDZQ04	1-1825137-2	
A103SYAQ04	1-1825137-3	
A103SYAV2Q04	1-1825137-4	
A103SYCB04	1-1825137-5	
A103SYCQ04	1-1825137-6	
A103SYWB04	1-1825137-7	
A103SYWQ04	1-1825137-8	
A103SYZB04	1-1825137-9	
A103SYZQ04	2-1825137-0	
A103T1CQ04	2-1825137-1	
A103T1ZQ04	2-1825137-2	
A103TZQ04	2-1825137-3	
A105MD9AB04	2-1825137-4	
A105MD9AQ04	2-1825137-5	
A105MYV3Q004	2-1825137-6	
A105P3CQ04	2-1825137-7	
A105P3CQ04	2-1825137-8	
A105P3ZQ04	2-1825137-9	
not assigned	3-1825137-0	
A105SD9AB04	3-1825137-1	
A105SD9AV2Q04	3-1825137-2	
A105SD9V30B04	3-1825137-3	
A105SYAB04	3-1825137-4	
A105SYAV2B04	3-1825137-5	
A105SYCB04	3-1825137-6	
A105SYCQ04	3-1825137-7	
A105SYZB04	3-1825137-8	
A105SYZQ04	3-1825137-9	
A105T1ZB04	4-1825137-0	
A105T1ZQ04	4-1825137-1	
A105TZQ04	4-1825137-2	
A107KAV2Q04	4-1825137-3	
A107KZB04	4-1825137-4	
A107MD9AV2B04	4-1825137-5	
A107MD9CQ04	4-1825137-6	
A107MD9V30Q04	4-1825137-7	
A107P3ZQ04	4-1825137-8	
A107SYAQ04	4-1825137-9	
A107SYCB04	5-1825137-0	
A107SYCQ04	5-1825137-1	
A107SYZQ04	5-1825137-2	
A107TZB04	5-1825137-3	
A105MD9AV2B	5-1825137-4	
A103MD9V30B04	5-1825137-5	PRELIMINARY
A103MCWCB04	5-1825137-6	PRELIMINARY
A103SCWCB04	5-1825137-7	PRELIMINARY

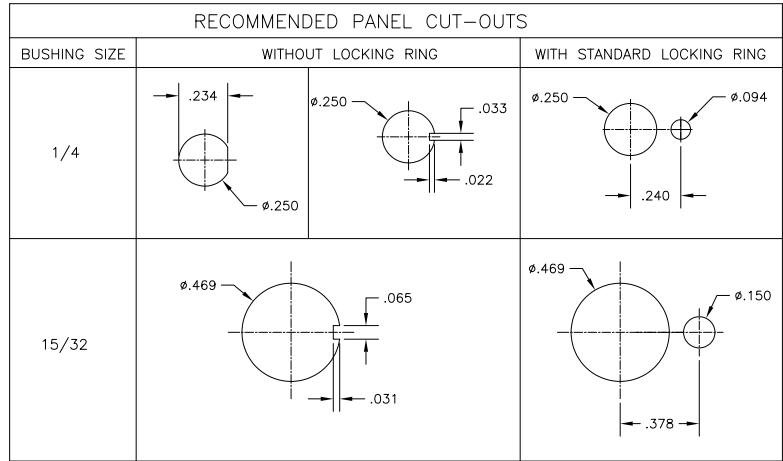

MATERIALS CHART		
COMPONENT NAME	BASE MATERIAL	FINISH
CASE	DAP, RED, UL94 V-0	
FRAME	STAINLESS STEEL	
B TERMINALS & CONTACTS	COPPER	GOLD OVER NICKEL
G TERMINALS & CONTACTS	COPPER	GOLD OVER SILVER
Q TERMINALS & CONTACTS	COPPER	.000400 SILVER
ACTUATOR	PHENOLIC, BLACK, UL94 V-1	
LEVER	BRASS	CHROME
BUSHING	BRASS	NICKEL
SPRING	MUSIC WIRE	
SUPPORT BRACKET	BRASS	TIN
PIVOT PIN	STEEL	NICKEL
LOCK WASHER	STAINLESS STEEL	
LOCKING RING	STAINLESS STEEL	
NUTS	C3604BD BRASS	NICKEL
TERMINAL SEAL	EPOXY	

THIS DRAWING IS A CONTROLLED DOCUMENT. DIM: M. ZITTO 18MAY05. DIMENSIONS: INCHES. TOLERANCES UNLESS OTHERWISE SPECIFIED: 0 PLC ± .005, 1 PLC ± .005, 2 PLC ± .005, 3 PLC ± .010, 4 PLC ± .010, ANGLES ± .5°. MATERIAL: -. FINISH: -. DIM: M. ZITTO 18MAY05. NAME: M. ZITTO. PRODUCT SPEC: -. APPLICATION SPEC: -. WEIGHT: -. CUSTOMER DRAWING. SCALE: 3:1. SHEET: 4 of 4. REV: A4. GEMINI A SERIES TOGGLE SWITCH, SINGLE POLE, 3 POSITION FUNCTIONS (03, 05 & 07). SIZE: A2. CASE CODE: C=1825137. RESTRICTED TO: -. TE Connectivity logo.