

THE INFORMATION CONTAINED IN THIS DRAWING IS THE SOLE PROPERTY OF L-COM, INC. ANY REPRODUCTION IN PART OR WHOLE WITHOUT THE WRITTEN PERMISSION OF L-COM, INC. IS PROHIBITED.

REVISIONS			
REV	DESCRIPTION	DATE	APPROVED
A	INITIAL RELEASE	01/21/03	DFP
B	ECN1482: PANEL OPENING SIZE WAS .580 X .760	9/5/03	DFP
C	ECN1629: ADDED COMPONENT SPECIFICATION TABLE	12/31/03	DFP

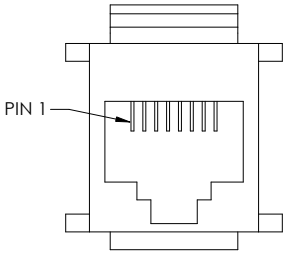

2X RJ45 JACK
(8X8)

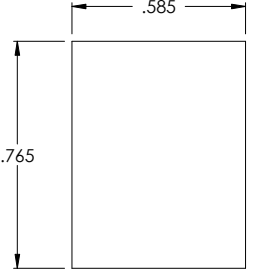
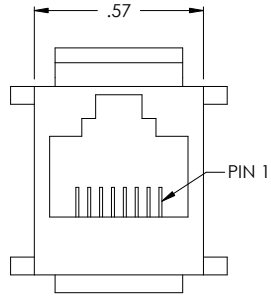
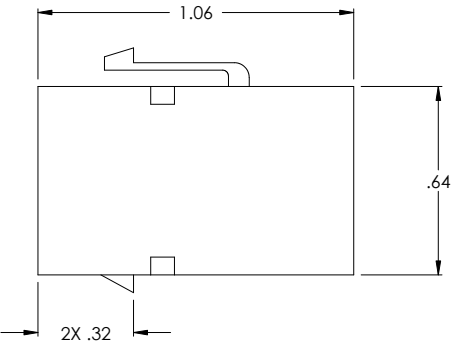

RECOMMENDED PANEL OPENING
MAXIMUM PANEL THICKNESS: .062

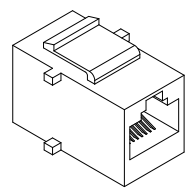

Component Specification	
Material	
Housing	Glass Filled Polyester, UL94V-0 compliant, Color: Black
Contacts	
Contact Plating	Phosphor Bronze
Contact Plating	Selective Gold, over nickel plating
Design	
Jack	Compliant to mechanical requirements of FCC 68.5 Subpart F
Electrical	
Current Rating	1.5 Amp (max)
Voltage Rating	150 VAC (max)
Environmental	
Operating Temperature Range	-20°C to +85°C
Application	
Wiring	Straight through
Maximum Panel Thickness	.062" CS-196

APPROVALS	DATE
DRAWN BY D. PARHAM	12/30/2002
CHECKED BY C. MCCORMICK	01/02/2003
APPROVED BY R. CARRICK	01/09/2003

L-com 45 BEECHWOOD DRIVE
NORTH ANDOVER, MA 01845

CONNECTIVITY PRODUCTS

PRODUCT DESCRIPTION
CATEGORY 3 UNSHIELDED COUPLER

DRAWING TITLE
OUTLINE DRAWING

SIZE A	FSCM NO. 43321	DWG. NO. TDG1026KC3-OD1	REV. C
SCALE: NONE		CAD FILE: TDG1026KC3-OD1.SLDDRW	SHEET 1 OF 1

UNLESS OTHERWISE SPECIFIED
DIMENSIONS ARE IN INCHES
TOLERANCES ARE:
.XX ±.01
.XXX ±.005
CABLE LENGTH TOLERANCE
<300' ±5% >300' ±2%

CONFIGURATION DETAILS OF
UNDIMENSIONED FEATURES
MAY VARY