

Part Number **HSR-194W** Contact Form A Switch Configuration SPST Rev. C

**Standard Size Switch with Special Tungsten Contacts**

Features	Advantages
<ul style="list-style-type: none"> <li>• Hermetically sealed contacts</li> <li>• Tungsten contacts</li> <li>• Leaded glass currently exempted from RoHS requirements</li> </ul>	<ul style="list-style-type: none"> <li>• Extended operations in extreme environments</li> <li>• Not ESD sensitive</li> <li>• Excellent historical performance</li> </ul>

**Electrical Specifications**

Power		Watts - maximum	50
Voltage	Switching	VDC - maximum	350
	Breakdown	VDC - minimum	600
Current	Switching	Amp - maximum	2
	Carry	Amp - maximum	5.4
Resistance	Initial Contact Resistance	Ohm - maximum	0.10
	Insulation Resistance	Ohm - minimum	1 E10
Capacitance	Contact	pF - typical	1.4
Temperature	Operating	°C	-40 to +125
	Storage	°C	-40 to +200

**Magnetic Specifications**

Pull - In Range		Ampere Turns	60-100
Test Coil		NARM RS-421-A	Coil IV

**Physical/Operational Specifications**

Capsule Volume	Excluding Leads	CC - nominal	1.13
Contact Material			Tungsten
Operate Time	Including Bounce	mSeconds - maximum	3.00
Release Time	Including Bounce	mSeconds - maximum	1.30

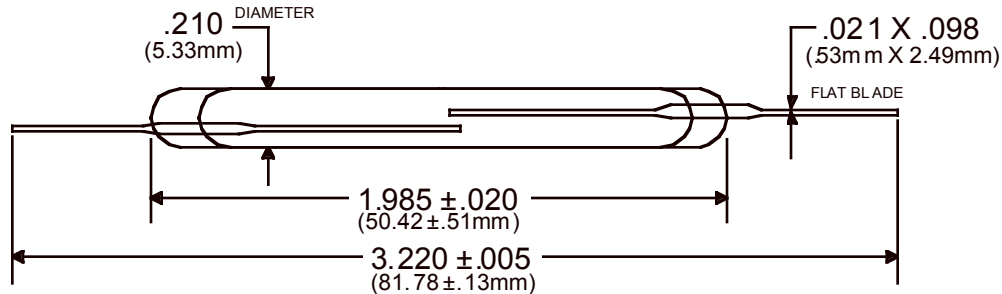

- Notes:
- (1) Specifications are not constant across entire magnetic range.
  - (2) Customer must exercise care in handling, mounting, lead forming, and cutting to prevent damage to glass capsule and/or switch sensitivity.
  - (3) For information or custom configurations about performance, mounting options or packaging, contact our Sales department.
  - (4) Information contained hereon is for informational purposes only and should not be deemed as accurate for a specific application. Consult factory for specific application information and/or latest revision.