

Last Update: 4-7-04

Ref. #: MS-100005

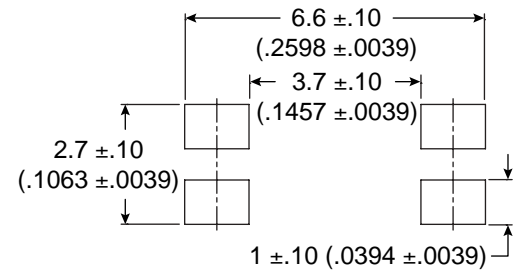

PCB Layout

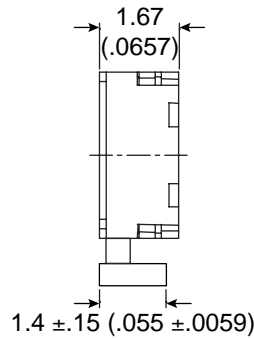
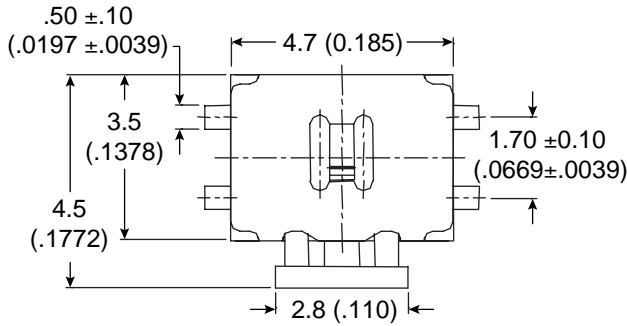
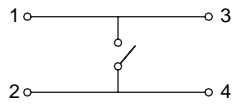
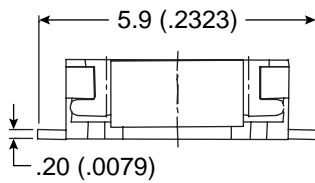

Circuit Diagram

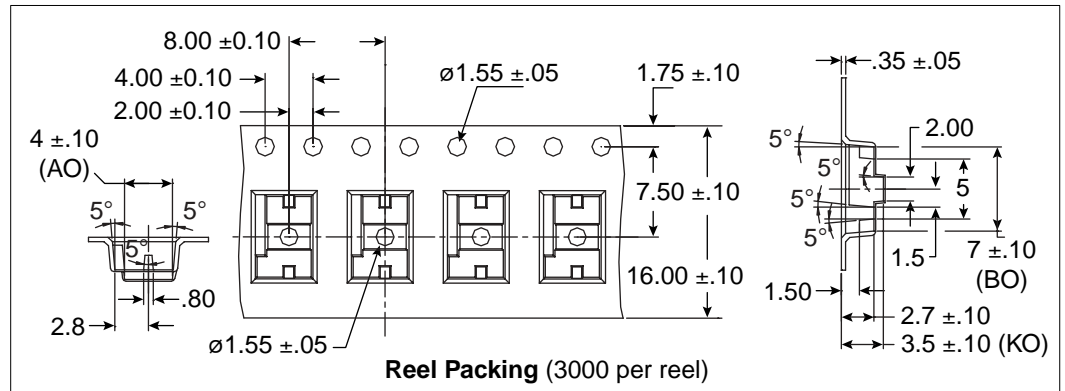

Reel Packing (3000 per reel)

Dimensions: mm (In)

Mechanical Specifications:

- Operation Force: 260 ± 50gf
- Stroke: 0.30 + 0.1 mm/- 0.15 mm
- Operation Temperature: -25°C to +70°C
- Storage Temperature: -30°C to +80°C

Electrical Specifications:

- Electrical Life: 100,000 cycles min. for PT(C)L, PT(C)F
- Rating: 50mA, 12VDC
- Contact Resistance: 100mΩ max.
- Insulation Resistance: 100MΩ min. 500VDC
- Dielectric Strength: 250VAC/ minute
- Contact Arrangement: SPST

Materials:

- Cover: Stainless steel
- Contact disc: Stainless with silver cladding
- Terminal: Brass with silver plating
- Base: LCP High-temp thermoplastic; Color: Black
- Stem: LCP High-temp thermoplastic; Color: Black
- Adhesive Tape: Teflon

Soldering Process:

- Hand Soldering: Use a soldering iron of 30 watts, controlled at 608°F (320°C) approximately 3 seconds.
- Soldering: Vapour phase and IR- reflow soldering can be applied

Reflow Temperature Profile:

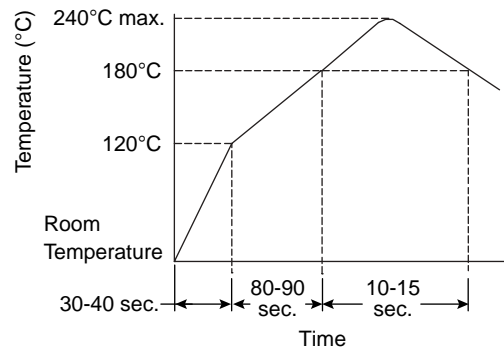

Tactile Switch
TS4922R2600



Available from Mouser Electronics

www.mouser.com

1-800-346-6873