

Dimensions: mm (In)

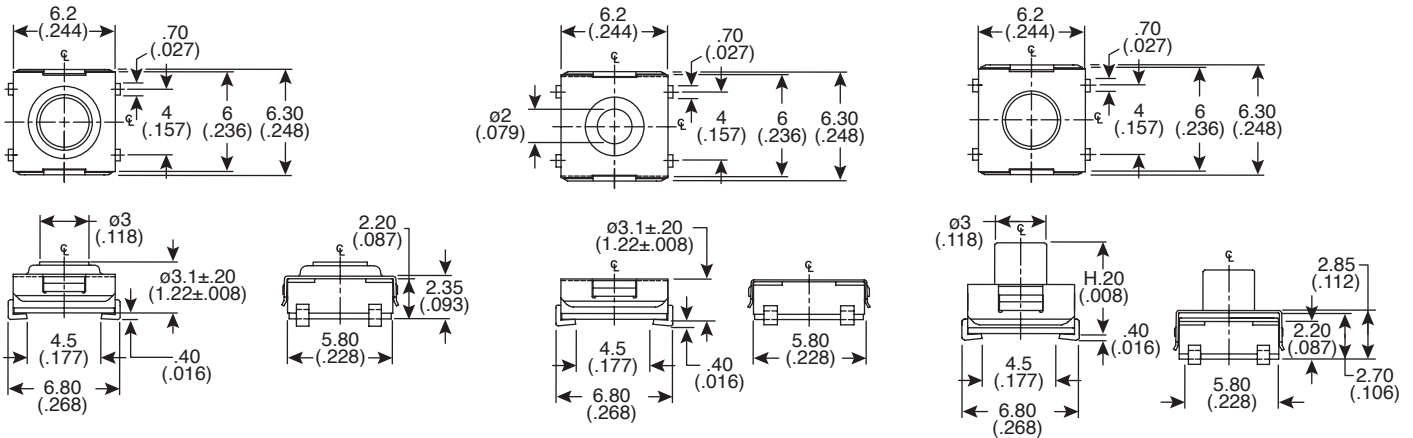

PCB Layout

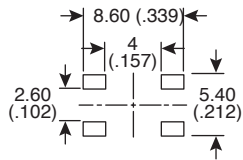

Circuit Diagram

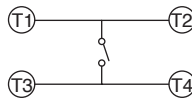

Reflow Temperature Profile

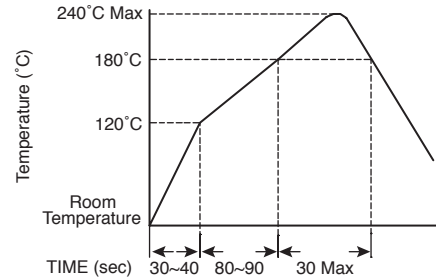

Electrical Specifications:

- Electrical Life:
  - 100K cycles (min.): TS6923T1601
  - 500K cycles (min.): TS6923T1803, TS6923T1805, TS6923T2603, TS6923T2604, TS6923T2605, TS6923T3604, TS6923T3605
- Rating: 50mA/12VDC
- Contact Resistance: 100mΩ max.
- Insulation Resistance: 100MΩ min. @ 500VDC
- Dielectric Strength: 250VAC/minute

Mechanical Specifications:

- Operating Force:
  - 160gf (silver): TS6923T1601
  - 180gf (brown): TS6923T1803, TS6923T1805
  - 260gf (red): TS6923T2603, TS6923T2604, TS6923T2605
  - 360gf (clear): TS6923T3604, TS6923T3605
- Stop Strength: Max 3kgf vertical static load cont. for 15 sec.
- Stroke: 0.25 +0.20/-0.1mm, 66N, 68S  
0.45 ±0.2mm, 69, 67, 65N(R)  
0.6 ±0.2mm, 69, 65, 67T
- Operating Temperature: -25°C to +70°C
- Storage Temperature: -30°C to +80°C
- Type: SPST

Materials:

- Cover: Stainless steel
- Contact Disc: Phosphor bronze with silver cladding
- Terminal: Brass with silver cladding
- Base: UL94V-0 Nylon high-temp. thermoplastic, black
- Stem: High-temp thermoplastic nylon UL 94V-0 (66N)
- Adhesive Tape: Resin based
- Metal Stem: Brass w/ nickel plated
- Sealed Rubber: Silicone rubber

Mountain Switch Part No.	H
TS6923T1803	3.5mm
TS6923T2603	3.5mm
TS6923T2604	3.8mm
TS6923T3604	3.8mm
TS6923T1805	5.2mm
TS6923T2605	5.2mm
TS6923T3605	5.2mm

Soldering Processes:

- Hand Soldering: Use a soldering iron of 30 watts, controlled at 608°F (320°C). approximately 2 seconds
- Soldering: Vapor phase & IR- reflow soldering can be applied
- Reflow Soldering: When applying reflow soldering, the peak temperature or the reflow over should be set to 240°C max.

Tactile Switches (SMT)

TS6923T1601	TS6923T2604	TS6923T2605
TS6923T1803	TS6923T3604	TS6923T3605
TS6923T2603	TS6923T1805	

