

Dimensions: mm (IN)

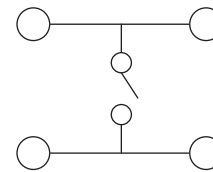

Circuit Diagram

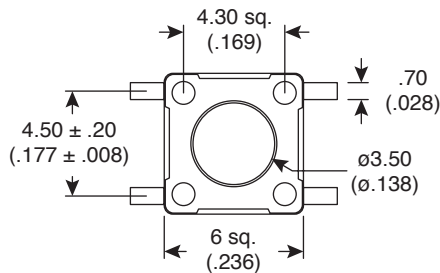
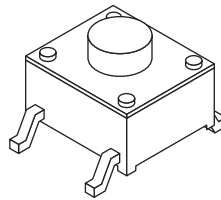
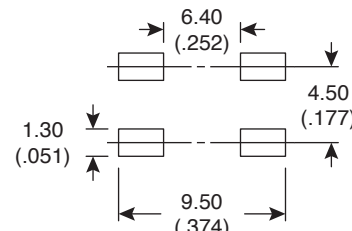
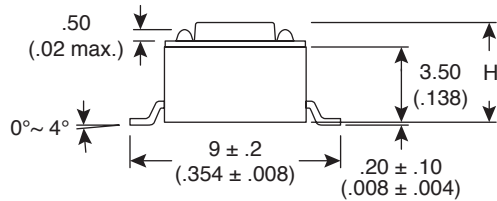

PCB Layout

Mechanical Specifications:

- Type: SPST
- Operating temperature: -25°~+70°C
- Operating force: 160 ± 50g
- Storage Temperature: -30°~ +80°C
- Travel/Stroke: (.25 +.2/ -.1mm)
- Stop strength: 3Kg for 15 seconds

Electrical Specifications:

- Rating: 50mA/12VDC
- Insulation resistance: 100MΩ min. @ 500VDC
- Dielectric Strength: 250VAC for 1 minute
- Contact resistance: 100mΩ max.
- Electrical life: 500,000 cycles

Material:

- Cover: stainless steel
- Contacts: silver clad phosphor bronze
- Terminals: silver clad brass
- Base: LCP, UL94V-0, black
- Stem: Nylon, UL94V-0, brown

Soldering Process:

- Maximum reflow soldering temperature: 240°C for 10 seconds max.

Mouser Stock No.	H Dimension In.(mm)
101-0164	.169 (4.30)
101-0264	.197 (5.00)
101-0364	.276 (7.00)
101-0464	.374 (9.51)

Tactile Switches (SMT)

101-0164, 101-0264, 101-0364, 101-0464

