

TACT Switch™ 1.25mm Height Low-profile Sidepush™ (Surface Mount Type)

SKSC Series

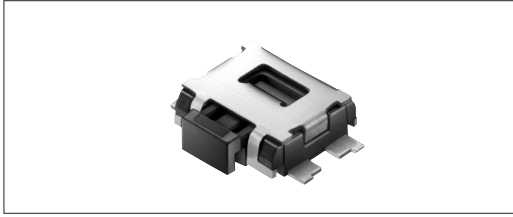

Combination of excellent solder strength & size merit (3.5×3.55mm with height of 1.25mm).



Product Line

Horizontal type

Product No.	Operating force	Operating direction	Travel (mm)	Rating (max.)	Rating (min.)	Operating life (5mA 5V DC)	Initial contact resistance	Guide bosses	Minimum order unit (pcs.)
SKSCLCE010	1.6N	Horizontal	0.2	50mA 12V DC	10μA 1V DC	100,000cycles	100mΩ max.	Without	5,000
SKSCLAE010	2.2N							With	
SKSCLDE010	1.6N							With	
SKSCLBE010	2.2N							With	

With Ground Terminal type

Product No.	Operating force	Operating direction	Travel (mm)	Rating (max.)	Rating (min.)	Operating life (5mA 5V DC)	Initial contact resistance	Guide bosses	Minimum order unit (pcs.)
SKSCPCE010	1.6N	Horizontal	0.2	50mA 12V DC	10μA 1V DC	100,000cycles	100mΩ max.	Without	5,000
SKSCP AE010	2.2N							With	
SKSCP DE010	1.6N							With	
SKSCP BE010	2.2N							With	

Packing Specifications

Taping

Unit:mm

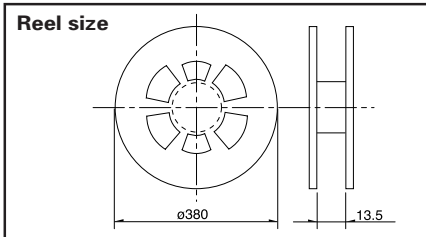

Number of packages (pcs.)			Tape width (mm)	Export package measurements (mm)
1 reel	1 case /Japan	1 case /export packing		
5,000	50,000	50,000	12	401 × 401 × 214

Dimensions

Unit:mm

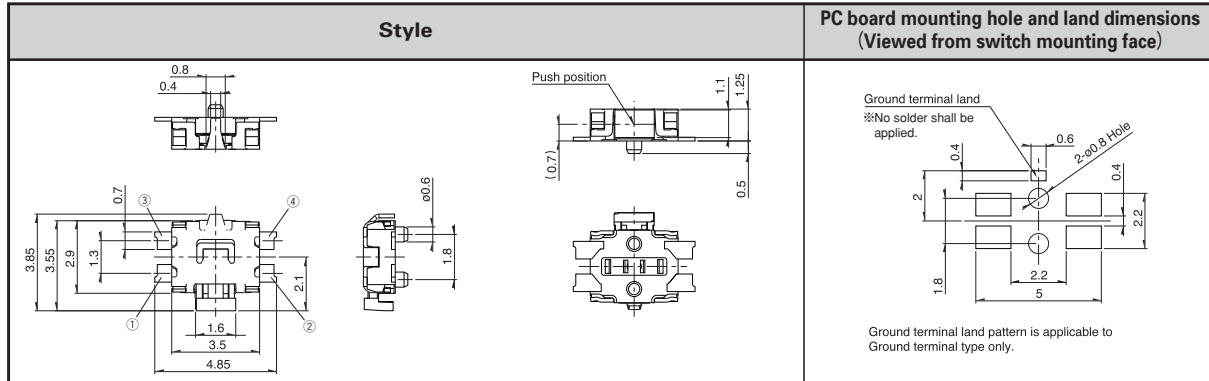

Circuit Diagram

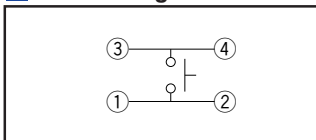

Notes

- For φ 330mm diameter reel requirements, please contact us.
- Please place purchase orders per minimum order unit N (integer).

Detector

Push

Slide

Rotary

Encoders

Power

Dual-in-line
Package Type

TACT Switch™

Custom-
Products

Sharp
Feeling

Soft
Feeling

Snap-in
Type

Surface
Mount Type







Radial
Type

Refer to P.334 for soldering conditions.

ALPS

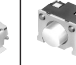
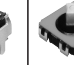
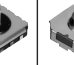
List of Varieties

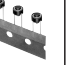
Sharp Feeling Type

Series		SKHU	SKSC	SKRE	SKRT	SKRV	SKRH	SKQU	SKRG	SKQK	SKQN	SKRC	
Detector	Photo												
Push	Type	Surface mount						Radial					
Slide	Features	Dust-proof type is available	Low-profile Horizontal type		Horizontal type	4-direction switch + push switch			Round terminal type	—	Round terminal Horizontal type	Water-proof	
Rotary	Operating direction	Vertical	—		—	●	●	●	●	●	—	●	
Encoders		Horizontal	—	●	●	●	—				●	—	
Power	Dimensions (mm)	W	6.2	3.5	3.9	4.5	6.45	7.35	□10	φ6.2	□6.6	7.3	φ9
		D	6.3	3.55			6.4	7.5				6.85	
		H	2.5	1.25	1.5	3.3	4	5	7.1	4.3	5	7.1	13
Operation force coverage	1N	↕	↕	↕	●	See the relevant pages for respective product descriptions			↕	↕	↕	↕	
	5N												
Travel (mm)		0.25	0.2			See the relevant pages for respective product descriptions			0.25				
Ground terminal		●	—	●	—								
Operating temperature range		-20°C to +70°C SKRV/QK											
		-30°C to +85°C											
Automotive use		○	—						●	—	●	—	
Electrical performance	Insulation resistance	100MΩ min. 100V DC											
	Voltage proof	250V AC for 1min. SKSC/RE/RV/RH : 100V AC for 1min.											
Durability	Vibration	10 to 55 to 10Hz/min., the amplitude is 1.5mm for all the frequencies, in the 3 direction of X, Y and Z for 2hours respectively											
	Lifetime	Shall be in accordance with the individual specification.											
Environmental performance	Cold	-30±2°C for 96h											
	Dry heat	80±2°C for 96h											
	Damp heat	60±2°C, 90 to 95%RH for 96h											
Page		316	318	319	320	483	484	485	321	323	322	324	

W : Width. The total dimension excluding terminal portion.
 D : Depth. The total dimension excluding terminal portion.
 H : Height. The minimum dimension if there is difference in product variety.

- TACT Switch™ Soldering Conditions334
- TACT Switch™ Cautions335
- Product Line of Knobs for TACT Switch™336

Notes

- The automotive operating temperature range to be individually discussed upon request.
- marks in "Available for automotive use" indicate that some of the series products can work at the operating temperature range from -40°C to +85°C, ●marks in "Available for automotive use" indicate that all of the series products can work at the operating temperature range from -40°C to +85°C.

Soldering Conditions

Condition for Reflow

Available for Surface Mount Type.

1. Heating method: Double heating method with infrared heater.
2. Temperature measurement: Thermocouple 0.1 to 0.2φ CA (K) or CC (T) at solder joints (copper foil surface). A heat resistive tape should be used to fix thermocouple.
3. Temperature profile

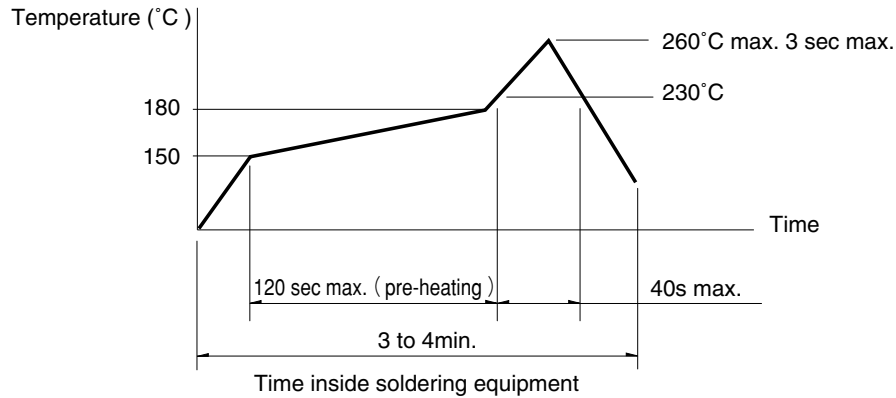

Notes

1. The above temperature shall be measured of the top of switch. There are cases where the PC board's temperature greatly differs from that of the switch, depending on the material, size, thickness of PC boards and others. The above-stated conditions shall also apply to switch surface temperatures.
2. Soldering conditions differ depending on reflow soldering machines. Prior verification of soldering condition is highly recommended.

Conditions for Auto-dip

Available for Snap-in Type and Radial Type
(Except, SKHL, SKQJ, SKQK, SKEG series)

Items	Condition
Flux built-up	Mounting surface should not be exposed to flux
Preheating temperature	Ambient temperature of the soldered surface of PC board. 100°C max.
Preheating time	60s max.
Soldering temperature	260°C max.
Duration of immersion	5s max.
Number of soldering	2times max.

Notes

1. Consult with us for availability of TACT Switch™ washing.
2. Prevent flux penetration from the top side of the TACT Switch™.
3. Switch terminals and a PC board should not be coated with flux prior to soldering.
4. The second soldering should be done after the switch is stable with normal temperature.
5. Use the flux with a specific gravity of min 0.81.
(EC-19S-8 by TAMURA Corporation, or equivalents.)

Manual Soldering (Except SKRT Series)

Items	Condition
Soldering temperature	350°Cmax.
Duration of soldering	3s max.
Capacity of soldering iron	60W max.

Detector

Push

Slide

Rotary

Encoders

Power

Dual-in-line
Package Type

TACT Switch™

Custom-
Products

Sharp
Feeling

Soft
Feeling

Snap-in
Type

Surface
Mount Type

Radial
Type