

GSD

1765-1

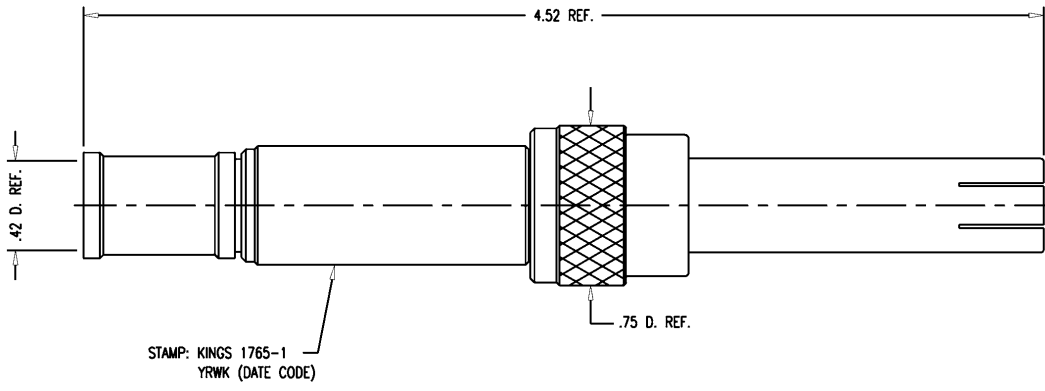

NOTES:

1. FOR USE WITH RG-8, 8A, 11, 11A & 213/U CABLE.
2. FOR CABLING INSTRUCTIONS SEE 3-7-2.
3. FOR CABLE TRIMMING USE KTJ-124 & KTD-179.
4. FOR CRIMPING USE DIE KTH-1078.
5. MATERIALS:
 INSULATOR: HIGH DENSITY POLYETHYLENE, MIL-P-22748
 GASKETS: SIL. RUB., ZZ-R-765
 K-GRIP SLEEVE: COM. BRONZE TUBE, ALLOY 220
 CONTACT: BER. COP., ASTM-B-196
 SPRING: STAINLESS STEEL, TYPE 302
 ALL OTHER PARTS: BRASS, ASTM-B16
6. FINISHES:
 CENTER CONTACT: HARD GOLD PLATE PER MIL-G-45204
 SPRING: PASSIVATE PER QQ-P-35
 ALL OTHER METAL PARTS: KINGS TARNISH RESISTANT FINISH (TR-5)
7. ELECTRICAL CHARACTERISTICS:
 NOMINAL IMPEDANCE: NON-CONSTANT
 VOLTAGE RATING: 20 KVDC

| REVISIONS | |
|-----------|---------------------------------------|
| ISSUE | CHANGES |
| 4 | CN 34190 C REDRAWN JCA 10/30/92 |
| 5 | CN 37941 E HVN 11/24/99 |

| | |
|------------------------------|---------------|
| SCALE 2:1 | |
| APPROX SURFACE AREA | |
| USED ON | |
| REF: | |
| PLUG, 20 KV | |
| DRAWN JCA | DATE 10/30/92 |
| DESIGN LJ | DATE 11/02/92 |
| APPR. | DATE |
| TUCKAHOE, NEW YORK 10707 | |
| 1765-1 | |

JCA3295

GSD