

REV	DOCUMENT	CHANGED BY	CHECK
5	0016685	DVM 03NOV05	RJ

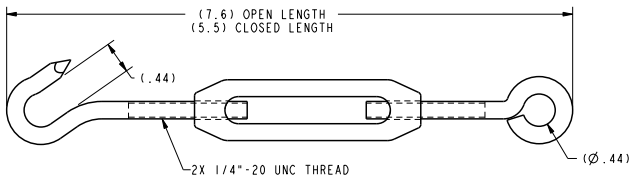

QUANTITY: 1
 MATERIAL: CARBON STEEL
 PLATING: ZINC PLATE CLEAR TRIVALENT CHROMATE FINISH
 MATING HARDWARE FURNISHED UNASSEMBLED

DESCRIPTION	MATERIAL	QUANTITY
1/4"-20 UNC HEX NUT	18-8 STAINLESS STEEL	1
1/4"-20 UNC HEX NUT (LEFT HAND)	18-8 STAINLESS STEEL	1

ALL COMPONENTS MUST BE WEEE-RoHS COMPLIANT

TURNBUCKLE

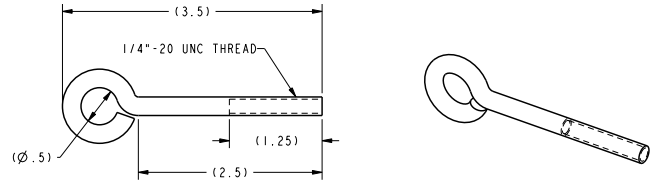

QUANTITY: 16
 MATERIAL: CARBON STEEL
 PLATING: ZINC PLATE CLEAR TRIVALENT CHROMATE FINISH
 MATING HARDWARE FURNISHED UNASSEMBLED

DESCRIPTION	MATERIAL	QUANTITY
1/4"-20 UNC HEX NUT	18-8 STAINLESS STEEL	32
1/4" SPLIT LOCKWASHER	18-8 STAINLESS STEEL	16
1/4" FLAT WASHER .62-.64 O.D.	18-8 STAINLESS STEEL	32

ALL COMPONENTS MUST BE WEEE-RoHS COMPLIANT

CABLE SUPPORT



QUANTITY: 2
 MATERIAL: STAINLESS STEEL

ALL COMPONENTS MUST BE WEEE-RoHS COMPLIANT

CABLE CLAMP

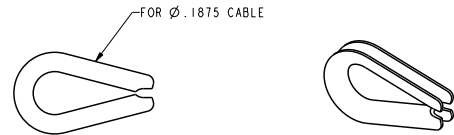

QUANTITY: 2
 MATERIAL: ZINC PLATED CARBON STEEL
 PLATING: ZINC PLATE CLEAR TRIVALENT CHROMATE FINISH

ALL COMPONENTS MUST BE WEEE-RoHS COMPLIANT

THIMBLE

NOTES
 PARTS SEALED SEPERATELY
 2 - BAGS TO BE MARKED WITH CATALOG LISTING

UNLESS OTHERWISE SPECIFIED TOLERANCES ARE:	<input checked="" type="checkbox"/> FRACTIONAL	<input type="checkbox"/> DECIMAL	<input type="checkbox"/> MIXED	DRAWN	KED	05MAR01
NO PLACE	.X	±.040	±1	CHECK	SAV	05MAR01
ONE PLACE	.XX	±.030	±0.4	THIS DRAWING COVERS A PROPRIETARY ITEM AND IS THE PROPERTY OF HONEYWELL. THIS DRAWING IS NOT TO BE COPIED OR USED WITHOUT THE PERMISSION OF HONEYWELL.		
TWO PLACE	.XXX	±.015	±0.15			
THREE PLACE	.XXXX	±.005	±			
ANGLES		±	±			
RAW MATERIAL-COMMERCIAL STANDARD				DIMENSIONS ARE TO BE MET BEFORE PROTECTIVE COATINGS ARE APPLIED		
THIRD ANGLE PROJECTION				3D PTC	ASME Y14.5M-1994	

Honeywell			
TITLE HARDWARE, PACKET			
SIZE	DWG TYPE	DRAWING NAME	REV
C	I	CPSZKI	5
SCALE	FULL	WEIGHT	SHEET 1 OF 1