



LTC-3PN



KEEPER II NON-RECHARGEABLE - LITHIUM / THIONYL CHLORIDE

Product Name Prismatic Battery

APPLICATIONS

Airports; Emergency; Industrial; Inventory Management; Measuring/Monitoring; Medical; Military; Navigation; Specialized Products

PERFORMANCE SPECIFICATIONS

Temperature:Low (Farenheit)	-67
Temperature:High (Farenheit)	185
Voltage (Volts)	3.5
Capacity (MilliAmp-Hours)	350

DIMENSIONS AND WEIGHT

Width/Diameter (Inches)	0.65
Length/Depth (Inches)	0.6
Weight (grams)	4.6
Height/Thickness (Inches)	0.265

CELL SIZE

Cell Size/Type Prismatic Cells

PRODUCT NOTES

UL recognized, no charging circuits required, non-pressurized system

The LTC-3PN series is a perfect match for applications which have little space but need a reliable, high energy source. This cell is available in three (3) printed circuit board (PCB) mounting configurations, with the flexibility to be designed for any mounting geometry. With 350 mAh packed into 0.0975 in², these small power sources will provide the solution for your electronic packaging requirements.

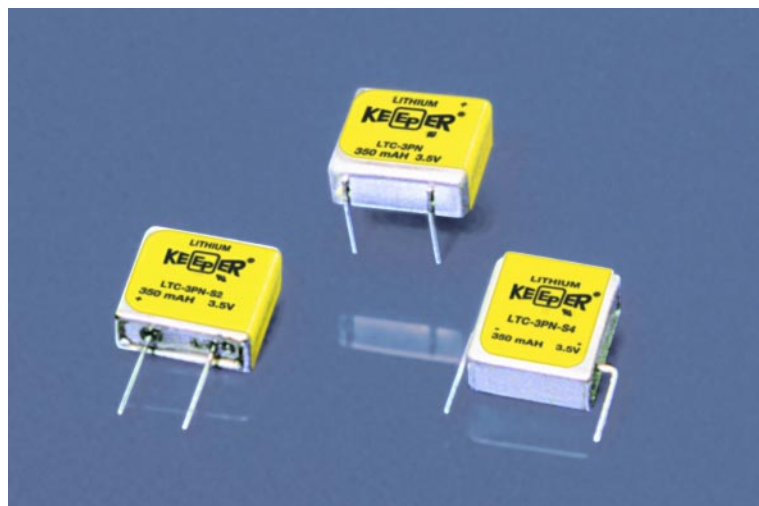

LTC-3PN PRODUCT FEATURES

- Compliant with lead-free RoHS and WEEE EC directives.
- Low profile, prismatic design.
- Stainless steel construction provides corrosion resistance, hermetic seal and structural integrity.
- Years of low rate continuous use.
- Stand-by use with 80% capacity retention after 15 years at room temperature.
- Highly efficient utilization of valuable board space.
- Wave solderable (limit solder bath exposure to a maximum of 5 seconds).
- High energy density compared to other chemistries.
- No charging circuits required.
- Higher cell voltage allows for fewer cells and high reliability.
- Flat discharge characteristics provide optimum voltage regulation.
- Non-pressurized system allow for high temperature usage.
- Ship unrestricted. IATA No. UN3090.
- Underwriters Laboratories recognized component.

TYPICAL LTC-3PN DISCHARGE CHARACTERISTICS AT VARIED TEMPERATURES

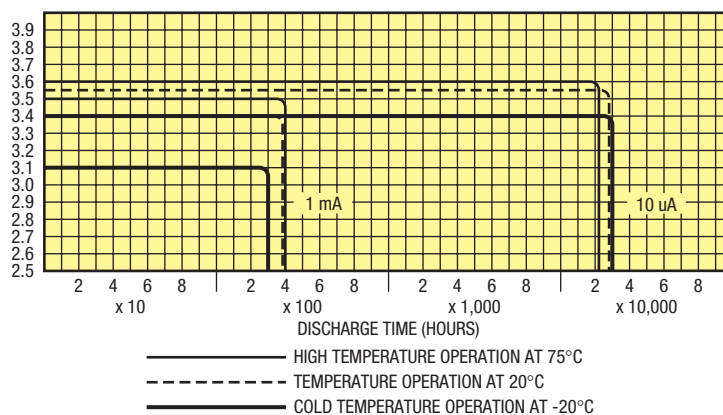

LITHIUM-THIONYL CHLORIDE BATTERIES

Part Number	Voltage	Capacity (mAh)	Length (in.)	Width (in.)	Thickness (in.)	Weight (g)
LTC-3PN	3.5	350	0.60	0.65	0.265	4.6
LTC-3PN-S2	3.5	350	0.65	0.265	0.60	4.6
LTC-3PN-S4	3.5	350	0.60	0.265	0.65	4.6

SPECIFICATIONS LTC-3PN

Nominal Open Circuit Voltage, 25°C 3.67 volts
 Nominal Working Voltage, 25°C 3.5 volts
 Nominal Capacity (350 hr. rate), 25°C 350 mAh
 Volume 0.103 cu. in.
 Weight 4.6 GMS
 Operating Temperature -40°C to +95°C
 Case Material: 304 Stainless Steel, Hermetically Sealed (case negative polarity)
 Terminal and Support Pins are .030" dia. (solder tinned)

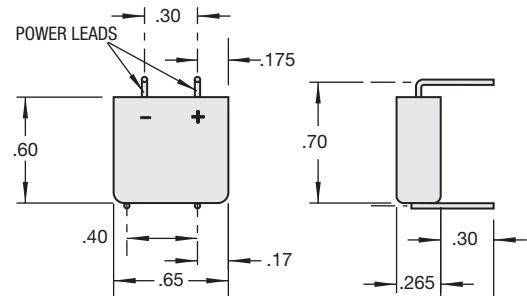

SPECIFICATIONS LTC-3PN-S2

Nominal Open Circuit Voltage, 25°C 3.67 volts
 Nominal Working Voltage, 25°C 3.5 volts
 Nominal Capacity (350 hr. rate), 25°C 350 mAh
 Volume 0.103 cu. in.
 Weight 4.6 GMS
 Operating Temperature -40°C to +95°C
 Case Material: 304 Stainless Steel, Hermetically Sealed (case negative polarity)
 Terminal and Support Pins are .030" dia. (solder tinned)

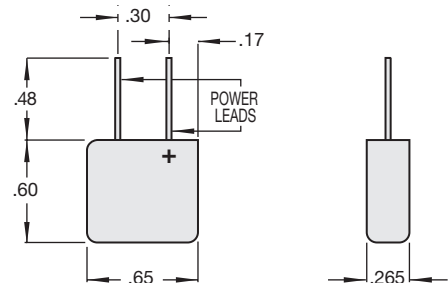

SPECIFICATIONS LTC-3PN-S4

Nominal Open Circuit Voltage, 25°C 3.67 volts
 Nominal Working Voltage, 25°C 3.5 volts
 Nominal Capacity (350 hr. rate), 25°C 350 mAh
 Volume 0.103 cu. in.
 Weight 4.6 GMS
 Operating Temperature -40°C to +95°C
 Case Material: 304 Stainless Steel, Hermetically Sealed (case negative polarity)
 Terminal and Support Pins are .030" dia. (solder tinned)

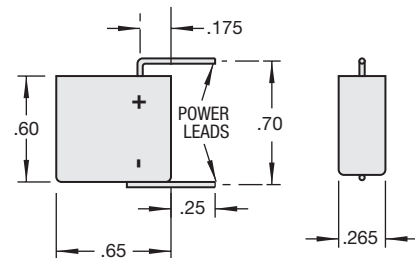

The specifications on this sheet may be changed by EaglePicher without notice.
 EaglePicher™ is a trademark of and Keeper® is a registered trademark of EaglePicher Corporation.

WE CAN DESIGN TO FIT ANY APPLICATION.

Our team of engineers can design any pin configuration required to fit your specialized application. If you don't see a battery configuration you need here, call us and we will begin working on a EPT part number just for you.