

MICRO SWITCH
a Honeywell Division

SWITCH - ENCLOSED

CATALOG LISTING
JS-556
M8805/55-006

FED. WFS. CODE 81929

2X $\varnothing 138-40$ UNF-2B THREAD
SELF LOCKING INSERT NUT

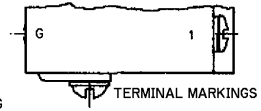
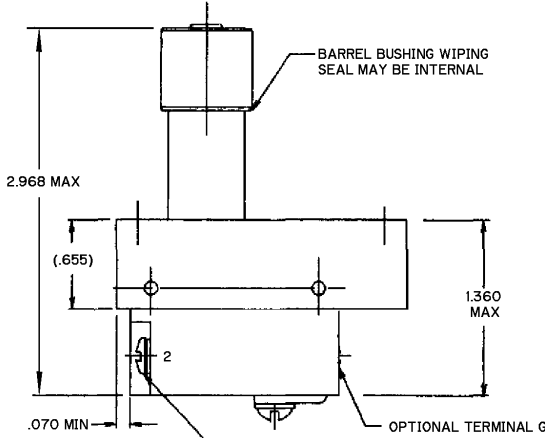
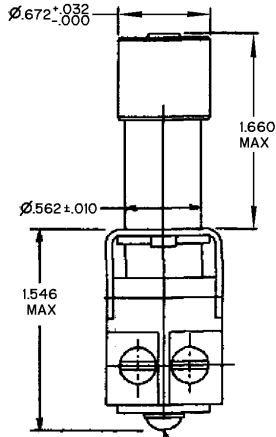
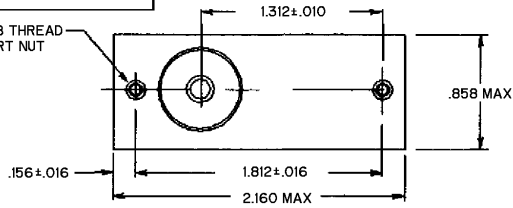

TERMINAL G
 $\varnothing .138-32$ UNC-2A
(*6-32 UNC-2A) .250 LONG
ROUND HEAD SCREW MS35338-98
LOCKWASHER OR EQUIVALENT

3X $\varnothing .125-40$ UNC-2A
(*5-40 UNC-2A) .250
LONG BINDING HEAD
SCREW (1 ADDITIONAL
G TERMINAL OPTIONAL)

THIS DRAWING COVERS A PROPRIETARY ITEM AND IS THE PROPERTY OF MICRO SWITCH, A DIVISION OF HONEYWELL. THIS DRAWING IS NOT TO BE COPIED OR USED WITHOUT THE APPROVAL OF MICRO SWITCH

CHARACTERISTICS	ELECTRICAL DATA
ACTUATING FORCE ----- 7 - 11 LBS	CONTACT ARRANGEMENT D P S T - N O
FULL OVERTRAVEL FORCE----- 20 LBS MAX	28 VDC RATED LOAD OVERLOAD
RELEASE FORCE----- 5 LB MIN	
PRETRAVEL----- .090 MIN	INDUCTIVE .75 1.75
DIFFERENTIAL TRAVEL----- .050 MIN	
OVERTRAVEL----- .050 MIN	
TOTAL TRAVEL----- .165 MIN	

ELECTRICAL DATA	
CONTACT ARRANGEMENT D P S T - N O	
28 VDC RATED LOAD OVERLOAD	
INDUCTIVE	.75 1.75

THIRD ANGLE PROJECTION	
DO NOT SCALE PRINT	
UNLESS OTHERWISE SPECIFIED TOLERANCES ARE	
ONE PLACE	(.01) ± .030
TWO PLACE	(.001) ± .015
THREE PLACE	(.0001) ± .005
ANGLES	±
WEIGHT	.32 LB MAX

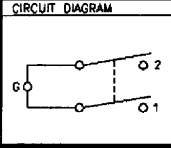

- NOTES
- 1 - SWITCH SEALED PER MIL-PRF-8805, SYMBOL 3
 - 2 - TERMINAL HARDWARE PACKET FURNISHED UNASSEMBLED: 15PA308-JS INCLUDES BUSS BRACKET AND TERMINAL SCREWS
 - 3 - MICRO SWITCH, MANUFACTURER'S CAGE CODE, CATALOG LISTING, MILITARY PART NUMBER AND DATE CODE IDENTIFIED ON SIDE OF SWITCH
 - 4 - OPERATING TEMPERATURE RANGE: -40°C TO +85°C

ANSI Y14.5M-1982 APPLIES

RASTER
 DRAWN
 JJA 7 OCT 99
 CHECK SAV 7 OCT 99
 CHECK
 REVISIONS
 A 201207
 14 SEP 00
 B 1000287
 05 JAN 04
 CHECK
 ISSUE
 3
 RELEASE NO
 PR-24110
 REPLACES
 JS-556
 CATALOG LISTING