

FG-23824-G22
SHT 1.1

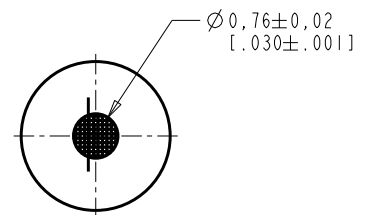
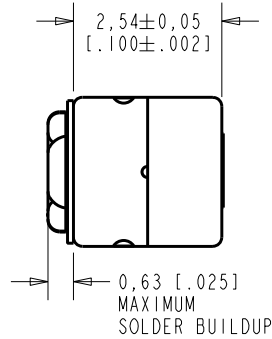
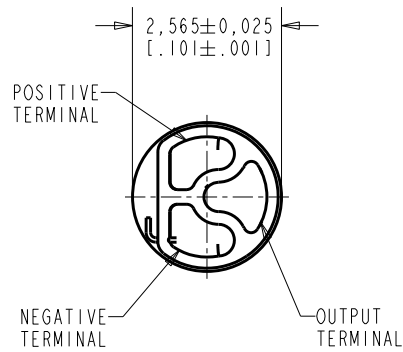

DIMENSIONS IN MILLIMETERS [INCHES]

Revision	C.O. #	Implementation Date	RELEASE LEVEL	REVISION
C	MI0103600	FALSE	Active	C
B	MI0102044	12-26-08		
A	MI0101294	11-30-06		
SCALE: 10:1			DR. BY	DATE
DO NOT SCALE DRAWING			MMM	11-30-06
			CK. BY	DATE
TITLE: MICROPHONE		FG-23824-G22	GJP	11-30-06
OUTLINE DRAWING		SHT 1.1	APP. BY	DATE
			GJP	11-30-06

KNOWLES ELECTRONICS
ITASCA, ILLINOIS U.S.A.

RE111AS1ZE.FRM Rev: B

SENSITIVITY IN dB RELATIVE TO 1.0 VOLT/0.1 Pa (N/M²)
FOR CONDITIONS SHOWN BELOW.

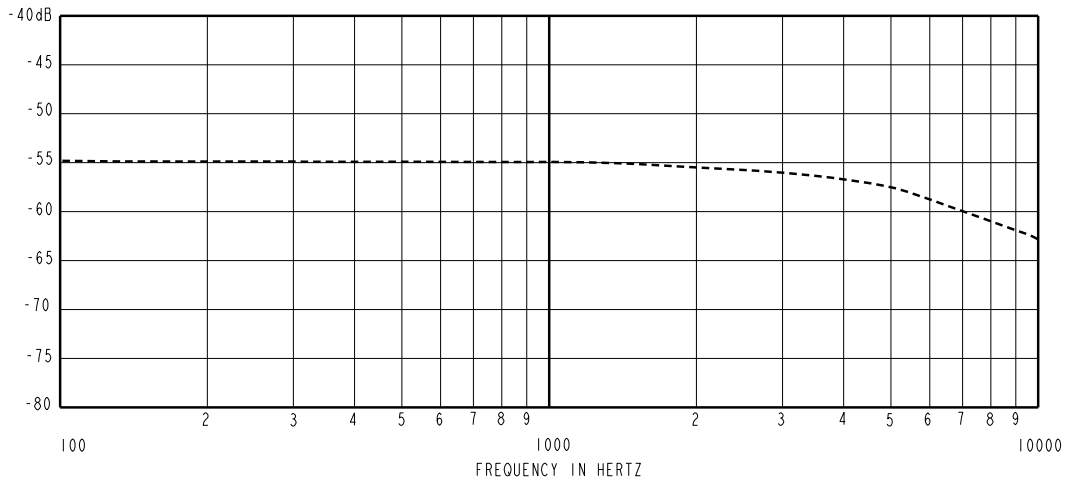

FREQUENCY	SENSITIVITY			DEVICE CONFORMITY	
	MIN.	NOM.	MAX.	RANGE OF DEVIATION FROM 1KHz	
100	---	-55.0	---	-3.0	+3.0
1000	-58.0	-55.0	-52.0	0.0	0.0
6000	---	-58.0	---	-5.0	-1.0

SUPPLY IN PACKS WITH 1000 Hz
SENSITIVITY GRADES

GRADE	MIN. (dB)	MAX. (dB)
A	-53.99	-52.00
B	-55.99	-54.00
C	-58.00	-56.00

- NOTES:
1. CASE CONNECTED TO NEGATIVE TERMINAL.
 2. MICROPHONE TO BE FUNCTIONAL WITH 1.6 VDC SUPPLY.
 3. TYPICAL SENSITIVITY TO HUMIDITY AT 1000Hz IS 0.06 dB/%RH
 4. SENSITIVITY AND NOISE VALUES INDICATED ON THIS SPECIFICATION ARE VALID AT 50% HUMIDITY.

PORT LOCATION	DC SUPPLY	AMPLIFIER CURRENT DRAIN	SENSITIVITY CHANGE ON REDUCING SUPPLY TO 0.9VDC	"A" WEIGHTED NOISE (1 kHz EQUIV. SPL)	OUTPUT IMPEDANCE OHMS			CAPACITANCE ±50%	
					MIN.	NOM.	MAX.	1-2	1-3
OKN	1.3V	50µA MAX.	3 dB MAX.	28.0 dB MAX.	10000	12000	14000	75pF	75pF

CAPACITANCE PROBE POINTS

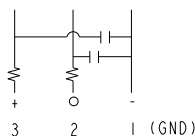

Revision	C.O. #	Implementation Date	RELEASE LEVEL	REVISION
C	MI0103600	FALSE	Active	C
B	MI0102044	12-26-08		
A	MI0101294	11-30-06		

KNOWLES ELECTRONICS
ITASCA, ILLINOIS U.S.A.

WHEN TEST LIMITS ARE USED TO ESTABLISH INCOMING INSPECTION ACCEPTANCE/REJECTION CRITERIA, CORRELATION OF TEST EQUIPMENT WITH KNOWLES IS ALSO REQUIRED FOR ELIMINATION OF EQUIPMENT AND TEST METHOD VARIATION

TITLE: **MICROPHONE** **FG-23824-G22**
PERFORMANCE SPECIFICATION **SHT 2.1**

DR. BY	DATE
MMM	11-30-06
CK. BY	DATE
GJP	11-30-06
APP. BY	DATE
GJP	11-30-06