

REV.	DESCRIPTION	DATE	APPROVED
A	Engineering Release	10/20/05	M. C.

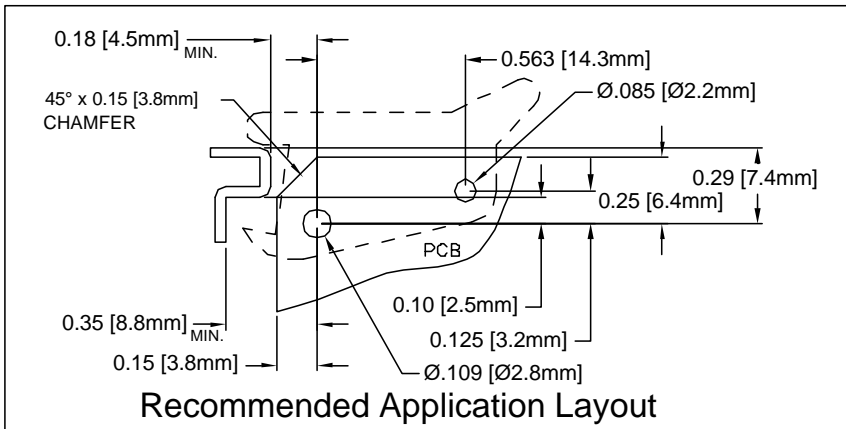
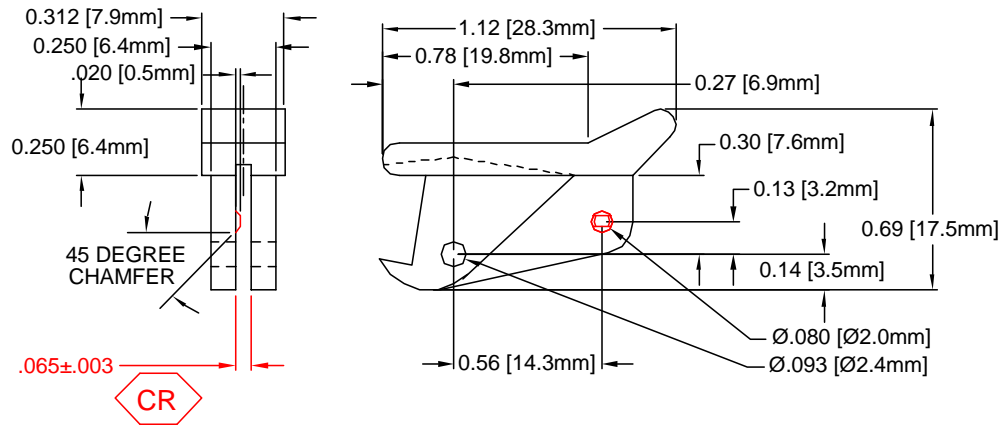

CR CRITICAL TO QUALITY. A COOLING FIXTURE MAY BE REQUIRED TO MAINTAIN TOLERANCE.

STANDARD TOLERANCE (UNLESS OTHERWISE SPECIFIED)		 4 THOMAS, IRVINE, CA. 92618 TEL: (949) 951-8808 FAX: (949) 951-3974	
DECIMALS: .X ±.1 .XX ±.01 .XXX ±.005			
DESIGNED: Ty Yin	DATE: 10/20/05	TITLE: CIRCUIT BOARD CARD EJECTOR	
CHECKED: M. Chen	DATE: 10/20/05	PART NO: LP-06-1	REVISION: A
		CAGE CODE : 32559	SHEET # 1 OF 1
<small>CAD GENERATED DOCUMENT. DO NOT MEASURE DRAWING.</small>			

2. MATERIAL: NYLON 6/6, 94V-0, WHITE. BIVAR MATERIAL CODE 24-WE.
RTP POLYAMIDE NYLON 6/6, 0299X63548, NATURAL OR MODIFIED PLASTICS MN6/6-SE WHT.
1. GENERAL SPECIFICATIONS: BIVAR MOLDED COMPONENT SPECIFICATION BV00-E101.