

3/16 HEX MALE-FEMALE STANDOFFS

RAF

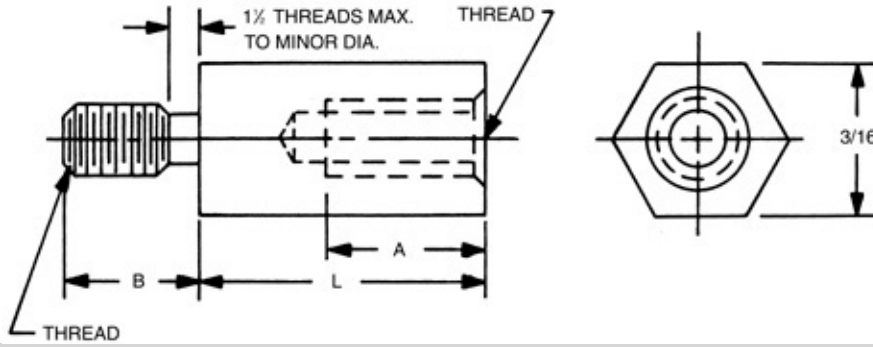

RAF

Order Code: (code is blank)

<<<

>>>

Contents

Finishes:

select a finish

Quote

[\[How to create part numbers\]](#)

[\[Material Specifications\]](#)

| SELECT | PART NO. | LENGTH |
|-----------------------|----------|--------|
| <input type="radio"/> | 4500A | 5/32 |
| <input type="radio"/> | 4500 | 3/16 |
| <input type="radio"/> | 4500T | 7/32 |
| <input type="radio"/> | 4501 | 1/4 |
| <input type="radio"/> | 4501T | 9/32 |
| <input type="radio"/> | 4502 | 5/16 |
| <input type="radio"/> | 4502T | 11/32 |
| <input type="radio"/> | 4503 | 3/8 |
| <input type="radio"/> | 4503T | 13/32 |
| <input type="radio"/> | 4504 | 7/16 |
| <input type="radio"/> | 4504T | 15/32 |
| <input type="radio"/> | 4505 | 1/2 |
| <input type="radio"/> | 4505T | 17/32 |
| <input type="radio"/> | 4506 | 9/16 |
| <input type="radio"/> | 4506T | 19/32 |
| <input type="radio"/> | 4507 | 5/8 |
| <input type="radio"/> | 4507T | 21/32 |
| <input type="radio"/> | 4508 | 11/16 |
| <input type="radio"/> | 4508T | 23/32 |

| SELECT | PART NO. | LENGTH |
|-----------------------|----------|--------|
| <input type="radio"/> | 4509 | 3/4 |
| <input type="radio"/> | 4509T | 25/32 |
| <input type="radio"/> | 4510 | 13/16 |
| <input type="radio"/> | 4510T | 27/32 |
| <input type="radio"/> | 4511 | 7/8 |
| <input type="radio"/> | 4511T | 29/32 |
| <input type="radio"/> | 4512 | 15/16 |
| <input type="radio"/> | 4512T | 31/32 |
| <input type="radio"/> | 4513 | 1 |
| <input type="radio"/> | 4514 | 1-1/16 |

| SELECT | PART NO. | LENGTH |
|-----------------------|----------|---------|
| <input type="radio"/> | 4515 | 1-1/8 |
| <input type="radio"/> | 4516 | 1-3/16 |
| <input type="radio"/> | 4517 | 1-1/4 |
| <input type="radio"/> | 4518 | 1-5/16 |
| <input type="radio"/> | 4519 | 1-3/8 |
| <input type="radio"/> | 4520 | 1-7/16 |
| <input type="radio"/> | 4521 | 1-1/2 |
| <input type="radio"/> | 4522 | 1-9/16 |
| <input type="radio"/> | 4523 | 1-5/8 |
| <input type="radio"/> | 4524 | 1-11/16 |
| <input type="radio"/> | 4525 | 1-3/4 |
| <input type="radio"/> | 4526 | 1-13/16 |
| <input type="radio"/> | 4527 | 1-7/8 |
| <input type="radio"/> | 4528 | 1-15/16 |
| <input type="radio"/> | 4529 | 2" |

| Select | CODE | THREAD |
|-----------------------|------|--------|
| <input type="radio"/> | 256 | 2-56 |
| <input type="radio"/> | 440 | 4-40 |
| <input type="radio"/> | 632 | 6-32 |

THREAD LENGTH CODE

| THREAD | A | B |
|--------|------|------|
| 2-56 | 3/16 | 5/32 |
| 4-40 | 1/4 | 3/16 |
| 6-32 | 3/8 | 1/4 |

In short lengths, "A" will be tapped to maximum depth

| Select | CODE | MATERIAL | RoHS |
|-----------------------|------|-----------------|------|
| <input type="radio"/> | AL | ALUMINUM | YES |
| <input type="radio"/> | B | BRASS | YES |
| <input type="radio"/> | SS | STAINLESS STEEL | YES |
| <input type="radio"/> | S | STEEL | YES |
| <input type="radio"/> | N | NYLON | YES |

Ordering Code

| | | | |
|--------|----------|---|--------|
| xxxx | xxx | x | x |
| | | | |
| | Thread | | Finish |
| Length | Material | | |

For non standard items please click [here](#)

RAF

© 1999 RAF Electronic Hardware All Rights Reserved

Seymour CT 06483 203 888-2133 Fax: 203 888-9860 www.rafhdwe.com