

# HIGH CURRENT CABLE CONNECTORS



A choice of 2 and 3 way high reliability Power Connectors with crimp and solder-bucket terminations.

- 10 Amp current rating
- Fully polarised housings
- Latching for strain-relief
- Back Potting for Sealing Protection Ratings of IP55, combined with "O" ring for IP67. Order Code K3605-00
- Supplied loose for customer assembly
- Standard colour grey. Contact Technical Sales for other colours and plating options
- For Tooling see below
- Wire size: 18 AWG

## MALE HOUSING

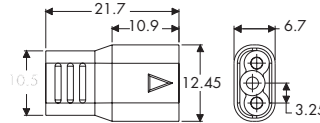

### Order Code

2 way K3600-91  
3 way K3700-91

## FEMALE HOUSING

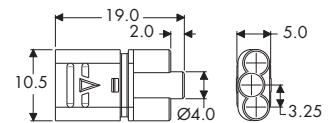

### Order Code

2 way K3601-91  
3 way K3701-91

## CONTACTS

### MALE SOLDER BUCKET

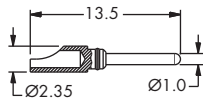

### Tin Plated Order Code

K3602-06

### FEMALE SOLDER BUCKET

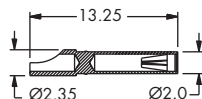

### Tin Shell, Tin Contact Order Code

K3603-T6

### MALE CRIMP CONTACT

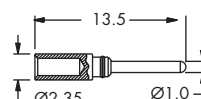

### Tin Plated Order Code

K3606-06

### FEMALE CRIMP CONTACT

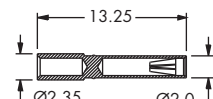

### Tin Shell, Tin Contact Order Code

K3607-T6

## CRIMP BARREL SIZE

Wire Size (AWG)	Crimp Tool Setting	Pull-off Force (Newtons)
18	8	142N

Insertion/Withdrawal Tool Order Code:  
**ZK3610-00**

Order Code:  
**M22520/2-01**  
(Use with Positioner)

Positioner Order Code:  
**ZK3609-00**  
(Use with Crimp Tool)

## WIRE STRIPPING DETAILS

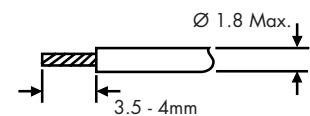

# TOOLING FOR POWERFIT SERIES

Extraction Tool Order Code: **ZKF-021**

## HAND CRIMP TOOL

Order Code: **ZKF-020**

## SEMI AUTOMATED TOOLING

Machine Order Code: **ZGP-PEO**

Contact Order Code	AWG	Mini Applicator	Spares
KF-4400006	16-20	ZKF-022	ZKF-023
KF-4410006	22-24	ZKF-024	ZKF-025
KF-4600006	16-20	ZKF-022	ZKF-023
KF-4610006	22-24	ZKF-024	ZKF-025
KF-4620006	26-28	ZKF-026	ZKF-027



North/South America  
Tel: +1 812 285 0055  
E-mail: [mis@harwin.com](mailto:mis@harwin.com)

Europe/Middle East  
Tel: +44 (0) 23 9237 0451  
E-mail: [mis@harwin.co.uk](mailto:mis@harwin.co.uk)

Asia/Pacific  
Tel: +65 779 4909  
E-mail: [mis@harwin.com.sg](mailto:mis@harwin.com.sg)