

Part Number:

254-PB507

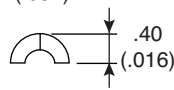

Pin Terminal

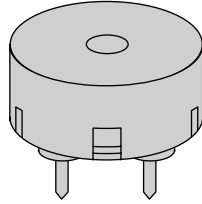
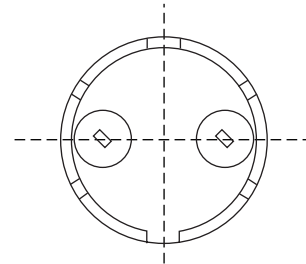
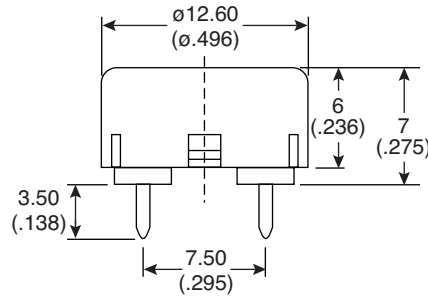

Piezoelectric Buzzer
(External Drive)

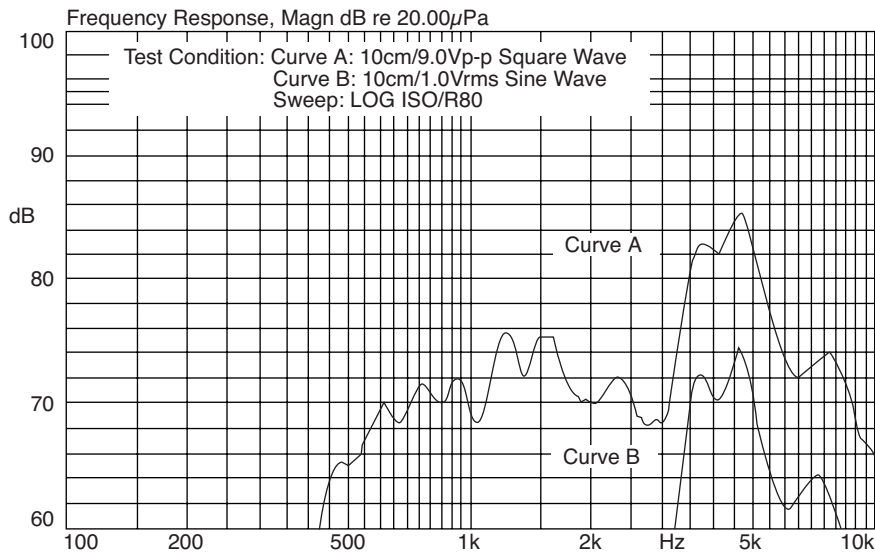

KT-400138

Electrical Specifications:

- Sound Pressure Level: 80dB min. at 4.0KHz/9.0Vp-p Square Wave/10cm.
70dB min. at 4.0KHz/1Vrms Sine Wave/10cm.
- Capacitance: 7,500pF \pm 30% at 120Hz
- Current Consumption: 3mA max. at 4.0KHz/9.0Vp-p Square Wave
- Allowable Input Voltage: 15Vp-p max.

Materials:

- Case: PBT (UL 94V-0)
- Lead Pin: Phosphor Bronze
- Weight: 0.7 grams

Mechanical Specifications:

- Operating Temperature: -20°C to +70°C
- Storage Temperature: -40°C to +85°C

Available from Mouser Electronics

www.mouser.com

(800) 346-6873

Specifications are subject to change without notice. No liability or warranty implied by this information. Environmental compliance based on producer documentation.