



# Heyco® EMC Metal Liquid Tight Cordgrips

EMC Nickel-Plated Brass with Contact Sleeve

## PG Hubs

- Excellent 360° shield contact with contact sleeve due to braided shield which runs into the gland.
- Combination of the sealing insert and the contact socket guarantees a constant contact quality with minimal transfer impedance.
- Ideal for applications where Electromagnetic Compatibility (EMC) is needed.
- Long thread for use in standard or thick panels.
- Inner cable protection.
- Nickel-plated finish over brass provides excellent corrosion resistance and durability.
- EMC locknuts available. See page X-X.
- Multiple sizes for cable diameters ranging from .10" (2,5 mm) to 1.00" (25,5 mm).
- IP 68 Rated.
- Temperature range of -40°F (-40°C) to 212°F (100°C).
- Cord Grips are made of nickel plated brass and the gland is made of TPE.



CABLE DIA. RANGE				PART NO.	Thread Size	Clearance Hole		PART DIMENSIONS					
Minimum		Maximum						A Max. O.A. Length		B Thread Length		C Wrenching Flat Size	
in.	mm.	in.	mm.			in.	mm.	in.	mm.	in.	mm.	in.	mm.
.18	4,5	.24	6,0	<b>4600</b>	PG7	.50	12,7	1.06	27,0	.39	10,0	.59	15,0
.24	6,0	.30	7,5	<b>4641</b>	PG7	.50	12,7	1.06	27,0	.39	10,0	.59	15,0
.24	6,0	.32	8,0	<b>4644</b>	PG9	.61	15,5	1.18	30,0	.39	10,0	.71	18,0
.32	8,0	.39	10,0	<b>4645</b>	PG9	.61	15,5	1.26	32,0	.39	10,0	.71	18,0
.22	5,5	.33	8,5	<b>4647</b>	PG11	.75	19,0	1.22	31,0	.39	10,0	.83	21,0
.33	8,5	.47	12,0	<b>4648</b>	PG11	.75	19,0	1.22	31,0	.39	10,0	.83	21,0
.32	8,0	.43	11,0	<b>4650</b>	PG13	.83	21,1	1.22	31,0	.39	10,0	.94	24,0
.43	11,0	.55	14,0	<b>4651</b>	PG13	.83	21,1	1.3	33,0	.39	10,0	.94	24,0
.32	8,0	.43	11,0	<b>4653</b>	PG16	.91	23,1	1.22	31,0	.39	10,0	.94	24,0
.43	11,0	.55	14,0	<b>4654</b>	PG16	.91	23,1	1.3	33,0	.39	10,0	.94	24,0
.51	13,0	.63	16,0	<b>4656</b>	PG21	1.14	29,0	1.45	37,0	.47	12,0	1.18	30,0
.63	16,0	.75	19,0	<b>4657</b>	PG21	1.14	29,0	1.57	40,0	.47	12,0	1.18	30,0
.75	19,0	.91	23,0	<b>4659</b>	PG29	1.48	37,6	1.61	41,0	.47	12,0	1.50	38,0
.91	23,0	1.00	25,5	<b>4660</b>	PG29	1.48	37,6	1.61	41,0	.47	12,0	1.50	38,0

## Metric Hubs

CABLE DIA. RANGE				PART NO.	Thread Size	Clearance Hole		PART DIMENSIONS					
Minimum		Maximum						A Max. O.A. Length		B Thread Length		C Wrenching Flat Size	
in.	mm.	in.	mm.			in.	mm.	in.	mm.	in.	mm.	in.	mm.
.10	2,5	.14	3,5	<b>4613</b>	M8x1,25	.33	8,4	.94	24,0	.39	10,0	.43	11,0
.12	3,0	.16	4,0	<b>4614</b>	M8x1,25	.33	8,4	.94	24,0	.39	10,0	.43	11,0
.12	3,0	.16	4,0	<b>4615</b>	M10x1,5	.41	10,4	.98	25,0	.39	10,0	.51	13,0
.16	4,0	.24	6,0	<b>4616</b>	M10x1,5	.41	10,4	.98	25,0	.39	10,0	.51	13,0
.18	4,5	.24	6,0	<b>4618</b>	M12x1,5	.50	12,7	1.06	27,0	.39	10,0	.59	15,0
.24	6,0	.30	7,5	<b>4619</b>	M12x1,5	.50	12,7	1.06	27,0	.39	10,0	.59	15,0
.24	6,0	.32	8,0	<b>4622</b>	M16x1,5	.64	16,3	1.18	30,0	.39	10,0	.71	18,0
.32	8,0	.39	10,0	<b>4623</b>	M16x1,5	.64	16,3	1.26	32,0	.39	10,0	.71	18,0
.32	8,0	.43	11,0	<b>4625</b>	M20x1,5	.80	20,3	1.22	31,0	.39	10,0	.94	24,0
.43	11,0	.55	14,0	<b>4626</b>	M20x1,5	.80	20,3	1.30	33,0	.39	10,0	.94	24,0
.51	13,0	.63	16,0	<b>4628</b>	M25x1,5	1.00	25,4	1.41	36,0	.43	11,0	1.18	30,0
.63	16,0	.75	18,0	<b>4629</b>	M25x1,5	1.00	25,4	1.53	39,0	.43	11,0	1.18	30,0
.71	18,0	.83	21,0	<b>4631</b>	M32x1,5	1.27	32,3	1.65	42,0	.51	13,0	1.42	36,0
.21	21,0	.98	25,0	<b>4632</b>	M32x1,5	1.27	32,3	1.65	42,0	.51	13,0	1.42	36,0

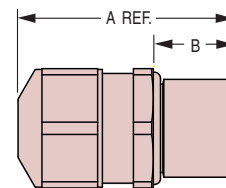
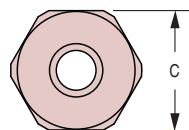

Quick Specs

Material	Nickel-Plated Brass W/TPE sealing gland
Certifications	Recognized under the Component Program of Underwriters' Laboratories File E51579 to both Canadian and U.S. requirements
Temperature Rating	-40°F (-40°C) to 212°F (100°C)
IP Rating	IP 68