

REV	ECN	APP'D
-	4503	10 10/31/01
A	5742	PN 12/28/05

SCFF SERIES PART NUMBERING SCHEME

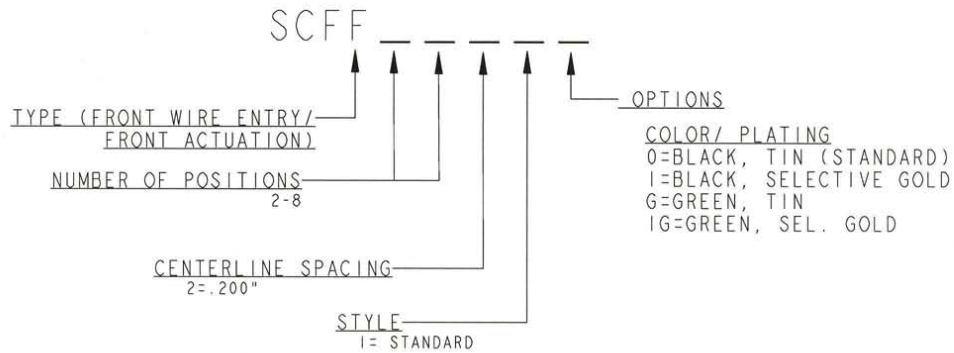

COLOR/ PLATING
 0=BLACK, TIN (STANDARD)
 1=BLACK, SELECTIVE GOLD
 G=GREEN, TIN
 1G=GREEN, SEL. GOLD

CONSULT PCD FOR PART NO. AND AVAILABILITY OF FOLLOWING OPTIONS:
 *CUSTOM COLORS *CUSTOM KEYING
 *CUSTOM MARKING *SELECTIVE CONTACT LOADING
 *NUMBER OF POSITIONS 9-24

INSTALLATION RECOMMENDATIONS:

WIRE RANGE: AWG #12-28, STRANDED OR SOLID,
 WIRE STRIP LENGTH: .250" (6,35mm)

MATERIALS:

HOUSING: PPO, UL 94 V-0
 CONTACT: PHOSPHOR BRONZE, TIN FINISH
 SPRING CLAMP: STAINLESS STEEL

MAX OPERATING TEMP: 105°C



RATINGS

CURRENT - 15 A
 VOLTAGE - 300V
 U.L. FILE NO. PENDING



RATINGS

CURRENT - 15 A
 VOLTAGE - 300 V
 CSA FILE NO. PENDING

DIN VDE 0627:1986
 DIN VDE 0110-1:1989
 EN 60947-1:1991
 EN 60947-7-1:1992

CURRENT -15 A
 VOLTAGE - 300 V
 TUV FILE NO. PENDING

DIMENSIONS

ANSI Y14.5M
 UNITS: INCHES
 Pro/E FILE

TOLERANCES

.XX ±0.01
 .XXX ±0.005
 ANGLES ±2.0°

PROJECTION



Amphenol Pcd

ENGR

C. LUSHUA 7/17/01

CHKD

A. PATRIE 10/30/01

APPD

I. QUINN 10/31/01

TITLE

**SCF SERIES
 PLUGGABLE TERMINAL BLOCK**

ORIGINAL
 STAMPED
 IN RED

THIS DOCUMENT CONTAINS
 PROPRIETARY INFORMATION WHICH
 IS THE CONFIDENTIAL PROPERTY
 OF AMPHENOL PCD, INC.
 PEABODY, MA, USA

SIZE

A

DWG NO.

SCFF02210

REV

A

CODE: 58982

SCALE: NONE

SHEET 1 OF 2

L=NUM OF POS X CL SPACING
 A=NUM OF POS X CL SPACING+.060

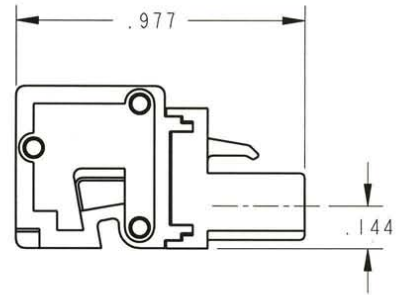
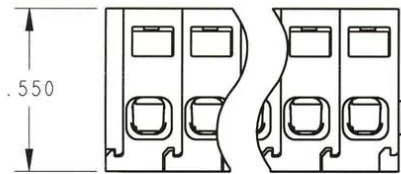
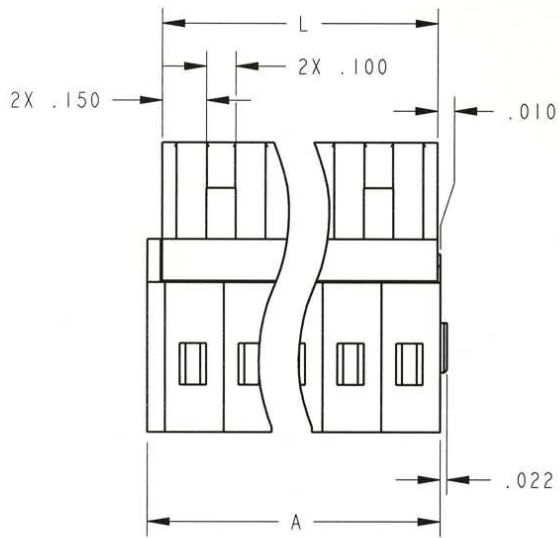

SIZE A	DWG NO. SCFF02210	REV A
CODE: 58982	SCALE: NONE	SHEET 2 OF 2

