

Recommended PCB Layout (top view)

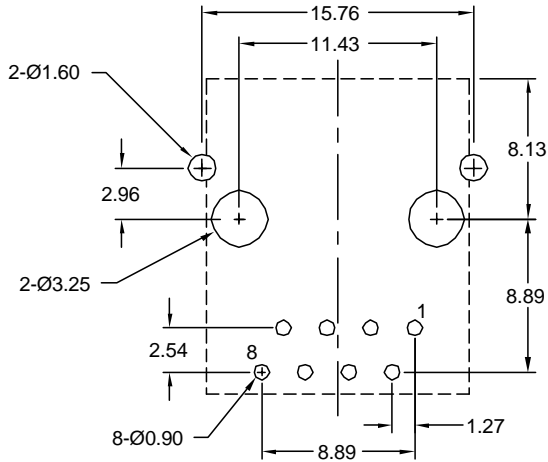

Part Number	Contact Area Plating Finish
GMHT-S-88	15u" Gold (standard)
GMHT-S-88-50	50u" Gold (50 option)

Materials and Finish

Housing Material-
High Temp Thermoplastic
(Reflow Process Compatible)
UL 94V-0 Rated
Color: Black
Design meets UL 1863 Sec. 8
Electrical Probe and Sec. 20
Child Finger test requirements

Shield Material-
Copper Alloy, 0.20mm thick,
Nickel Plated

Contact Material-
Phosphor Bronze

Contact Plating Options-
Standard: 0.0001" Nickel
Plating, Selective Plating
0.000015" Gold on Contact
Area, Tin/Lead on Termination End

-50 Option: 0.0001" Nickel Plating,
Selective Plating 0.000050"
Gold on Contact Area to
Comply with FCC Requirements
Under No. 47 C.F.R. Part 68,
Subpart F, Tin/Lead on
Termination End

Electrical Characteristics

Insulation Resistance-
500 Megohms min.

Dielectric Withstanding Voltage-
1000V rms, 60Hz

Contact Resistance-
20 milliohms max.

Current Rating-
1.5 Amps

Operating Temperature-
-40°C to +80°C

Durability Rating-
500 mating cycles min.

Tolerances
X.X ± 0.25
X.XX ± 0.15
Unless Stated
Otherwise

REVISION	DATE	DESCRIPTION	DRAWN BY	REV CHECK BY	UNITS
C2	8/14/02	ECO #02-016	C. Leiva	H. MA	mm
C3	3/28/03	ECO #03-011	REVISED BY	CHECK DATE	DATE
C4	6/15/05	ECO #05-017	R. Aguirre	7/27/05	11/19/96

GMHT-S-88

Right Angle Modular Jack, Shielded
B position, 8 contacts, High Temperature

