

REV.	DATE	DESCRIPTION
A	09/16/03	MODIFY CONTACT PIN LENGTH

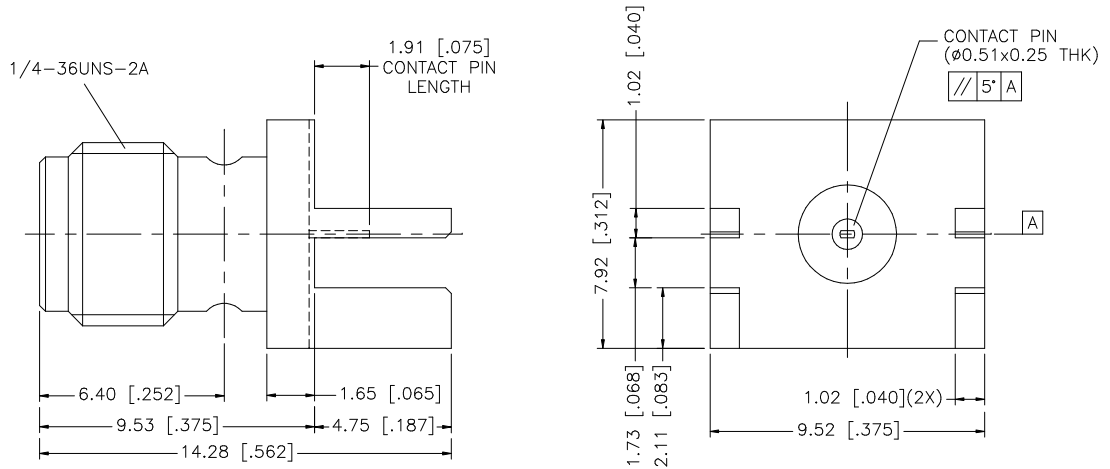

NOTE:

1. MAX. BOARD THICKNESS = 1.57mm

				UNLESS OTHERWISE SPECIFIED DIMENSIONS ARE IN MILLIMETERS. DIMENSIONS IN [] ARE IN INCHES AND FOR CUSTOMER REFERENCE ONLY.	APPROVALS	DATE	Amphenol Connex			
8				UNLESS OTHERWISE SPECIFIED TOLERANCES FOR MILLIMETERS ARE: 0.5 - 8mm ± 0.20mm 8 - 30mm ± 0.40mm 30 - 120mm ± 0.50mm UNLESS OTHERWISE SPECIFIED TOLERANCES FOR INCHES ARE: .020 - .315 = ± 0.007" .315 - 1.180 = ± 0.015" 1.180 - 4.724 = ± 0.020" DO NOT SCALE DRAWING	DRAWN	G.R.S.				09/16/03
7					CHECKED			PART NO. 132357		
6					ISSUED					
5					SHEET	1 OF 1		REV. A	SIZE A	SCALE NA
4					CAD FILE	C:/132/132357.DWG				
3	CONTACT PIN	BER. COPPER	GOLD		1					
2	INSULATOR	TEFLON	NATURAL		1					
1	BODY	BRASS	GOLD		1					
	DESCRIPTION	MATERIAL	FINISH	QTY						