

REV.	DATE	ECR NO.	DESCRIPTION
NC	05/08/03	-	INITIAL RELEASE
A	10/07/08	-	REVISE SLEEVE, FERRULE, INSULATOR DIMENSIONS

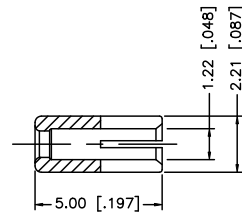
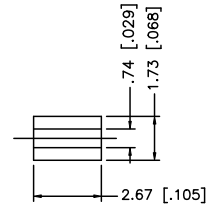
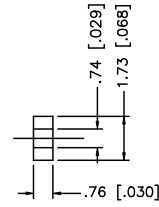
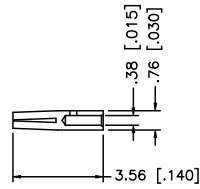
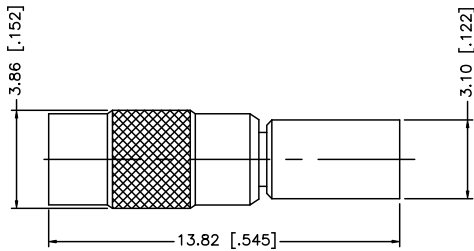
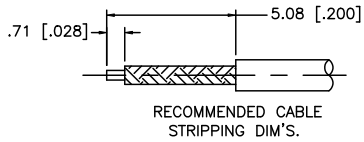

NOTE:

1. CRIMPED FERRULE HEX CRIMP SIZE .105" [2.67]
2. CONTACT PIN TO SOLDER.

DESCRIPTION	MATERIAL	FINISH	QTY	UNLESS OTHERWISE SPECIFIED DIMENSIONS ARE IN MILLIMETERS. DIMENSIONS IN [ ] ARE IN INCHES AND FOR CUSTOMER REFERENCE ONLY.	APPROVALS	DATE	Amphenol Connex									
8							<b>MMCX RECEPTACLE CRIMP TYPE (FOR 1.13mm CABLE)</b>									
7	INNER FERRULE	BRASS	NICKEL	1	DRAWN	GRS				10/07/08	<b>262141</b>					
6	SLEEVE	BRASS	NICKEL	1	CHECKED									PART NO. 262141 DWG. NO. 262141.DWG REV. A SIZE A SCALE NA		
5	INSULATOR	PTFE	NATURAL	1	ISSUED											
4	CONTACT PIN	BER. COPPER	GOLD	1	SHEET	1 OF 1		UNLESS OTHERWISE SPECIFIED TOLERANCES FOR MILLIMETERS ARE: 0.5 - 8mm ± 0.20mm 8 - 30mm ± 0.40mm 30 - 120mm ± 0.50mm  UNLESS OTHERWISE SPECIFIED TOLERANCES FOR INCHES ARE: .020 - .315 = ± 0.007" .315 - 1.180 = ± 0.015" 1.180 - 4.724 = ± 0.020"  DO NOT SCALE DRAWING								
3	INSULATOR	PTFE	NATURAL	1							CAD FILE C:/262/262141.DWG					
2	REAR BODY	BRASS	NICKEL	1										DRAWN GRS 10/07/08		
1	BODY	BRASS	GOLD	1												
								PART NO. 262141								
											DWG. NO. 262141.DWG					
														REV. A SIZE A SCALE NA		
								UNLESS OTHERWISE SPECIFIED TOLERANCES FOR MILLIMETERS ARE: 0.5 - 8mm ± 0.20mm 8 - 30mm ± 0.40mm 30 - 120mm ± 0.50mm  UNLESS OTHERWISE SPECIFIED TOLERANCES FOR INCHES ARE: .020 - .315 = ± 0.007" .315 - 1.180 = ± 0.015" 1.180 - 4.724 = ± 0.020"  DO NOT SCALE DRAWING								
											CAD FILE C:/262/262141.DWG					
														DRAWN GRS 10/07/08		
								PART NO. 262141								
											DWG. NO. 262141.DWG					
														REV. A SIZE A SCALE NA		