

NOTES:

1. DO NOT SCALE THIS DRAWING.
2. MATERIAL AND FINISH:
 BODY: BRASS, GOLD PLATED
 CONTACT: BERYLLIUM COPPER, GOLD PLATED
 INSULATOR: PTFE
2. 50 OHM IMPEDANCE.

901-10036		REVISIONS			
DRAWING NO.	REV	DESCRIPTION	DATE	ECO	APPR
THIRD ANGLE PROJ.	⊕ ↶ A	RELEASE TO MFG.	9/14/00	43504	PB/

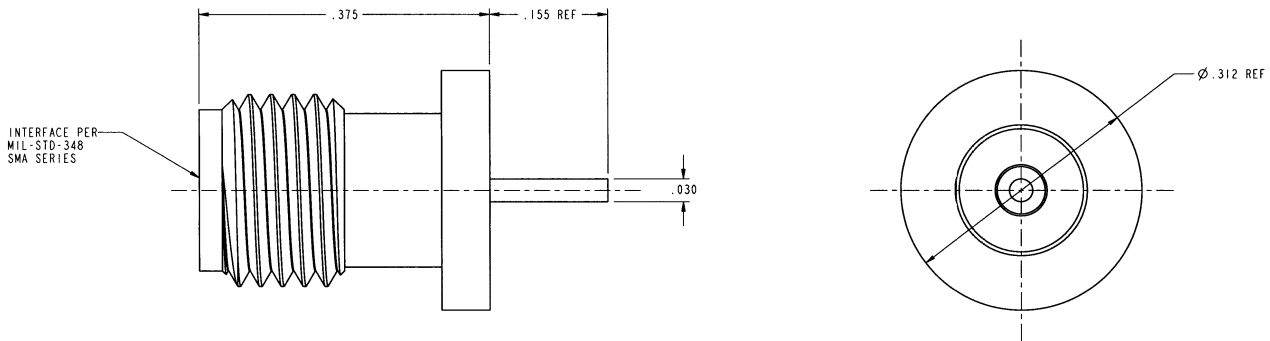
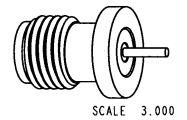

CUSTOMER OUTLINE DRAWING
 FOR REFERENCE ONLY

UNLESS OTHERWISE SPECIFIED, DIMENSIONS ARE IN INCHES AND TOLERANCES ARE: 2 PLACE DECIMAL ±.015 (0.381 mm) 3 PLACE DECIMAL ±.005 (0.127 mm) ANGLES ± 1° NOTICE - These drawings, specifications, or other data (1) are, and remain the property of Amphenol Corp. (2) must be returned upon request; and (3) are confidential and not to be disclosed to any person other than those to whom they are given by Amphenol Corp. The furnishing of these drawings, specifications, or other data by Amphenol Corp., or to any other person to anyone for any purpose is not to be regarded by implication or otherwise in any manner licensing, granting rights or permitting such holder or any other person to manufacture, use or sell any product, process or design, patented or otherwise, that may in any way be related to or disclosed by said drawings, specifications, or other data.	MATERIAL REFERENCE EAR 102-9676 (0 1 615X-1621-200 GEN# ASSYF1_SMA	DRAWN P. BRENZEL DATE 12-Sep-00	TITLE SMA JACK PC MOUNT RECEPTACLE		Amphenol Amphenol Corporation Communication and Network Products Division Danbury, CT U.S.A. 06810 SCALE: 8.0:1 SHEET 2 OF 2	
		ENGINEER P. BRENZEL DATE 12-Sep-00	APPROVED DATE 9/13/00	CAD FILE 1:\SMA\901-10036		CODE ID 74868