

REV.	DATE	DESCRIPTION
NC	01/17/06	UPDATE DRAWING FORMAT

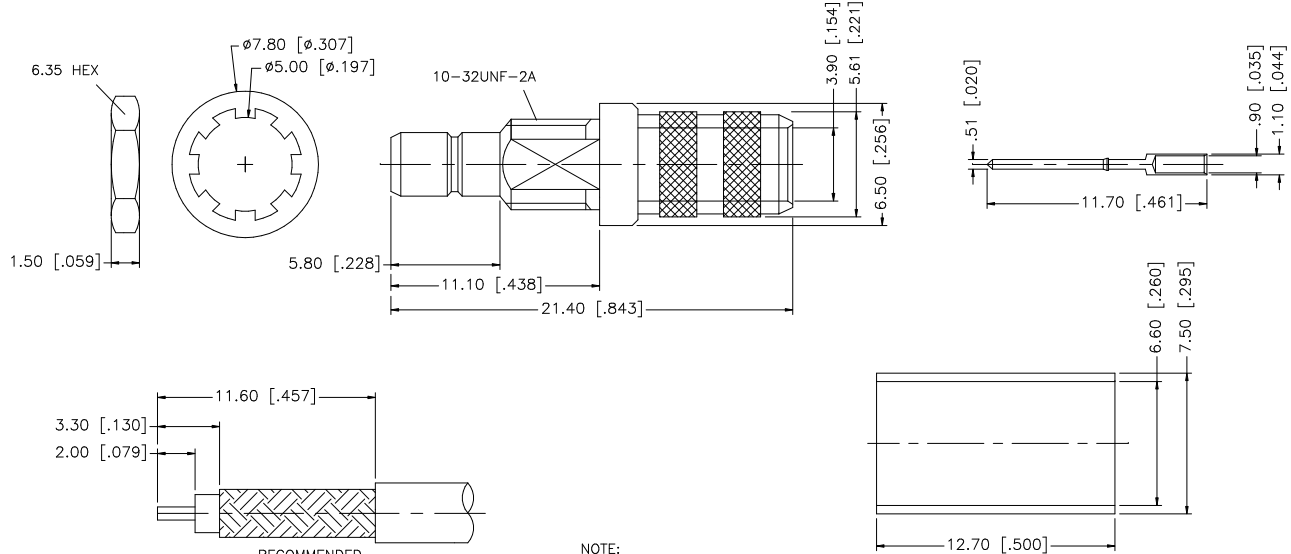
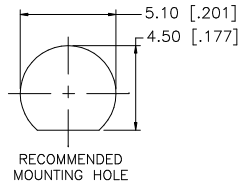

NOTE:
 1. CRIMPED FERRULE
 HEX CRIMP SIZE .255"
 2. CONTACT PIN TO SOLDER

DESCRIPTION	MATERIAL	FINISH	QTY	DO NOT SCALE DRAWING	APPROVALS	DATE	Amphenol Connex			
8							Amphenol Connex PART DESCRIPTION MINI 75ohm SMB CRIMP JACK (FOR RG-59/U 20AWG CABLE) PART NO. 142337-75 DWG. NO. 142337-75.DWG REV. NC SIZE A SCALE NA			
7					DRAWN G.R.S.	01/17/06				
6	HEX NUT	BRASS	GOLD	1	CHECKED					
5	LOCK WASHER	BRASS	GOLD	1	ISSUED					
4	FERRULE	COPPER	GOLD	1	SHEET	1 OF 1				
3	CONTACT PIN	BRASS	GOLD	1	CAD FILE	C:/142/142337-75.DWG				
2	INSULATOR	TEFLON	NATURAL	1						
1	BODY	BRASS	GOLD	1						

UNLESS OTHERWISE SPECIFIED DIMENSIONS ARE IN MILLIMETERS; DIMENSIONS IN [] ARE IN INCHES AND FOR CUSTOMER REFERENCE ONLY.
 TOLERANCES FOR MILLIMETERS ARE:
 0.5 - 8mm ± 0.20mm
 8 - 30mm ± 0.40mm
 30 - 120mm ± 0.50mm
 TOLERANCES FOR INCHES ARE:
 .020 - .315 = ± 0.007"
 .315 - 1.180 = ± 0.015"
 1.180 - 4.724 = ± 0.020"