

| REV. | DATE | DESCRIPTION |
|------|----------|-----------------------|
| NC | 02/22/99 | INITIAL RELEASE |
| A | 11/01/06 | UPDATE DRAWING FORMAT |

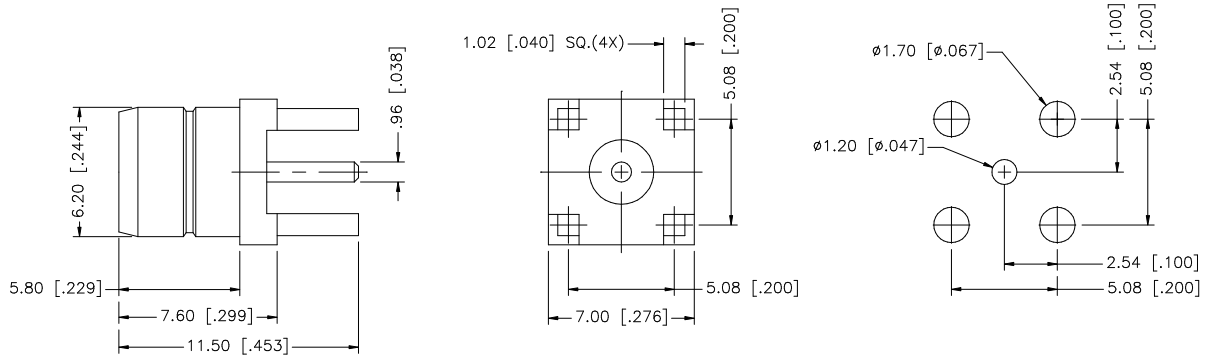

| | | | | | | | | | |
|---|-------------|----------|---------|---|-------------------|------------|---|----------|-------|
| 8 | | | | <p>UNLESS OTHERWISE SPECIFIED DIMENSIONS ARE IN MILLIMETERS. DIMENSIONS IN [] ARE IN INCHES AND FOR CUSTOMER REFERENCE ONLY.</p> <p>UNLESS OTHERWISE SPECIFIED TOLERANCES FOR MILLIMETERS ARE: 0.5 - 8mm \pm 0.20mm 8 - 30mm \pm 0.40mm 30 - 120mm \pm 0.50mm</p> <p>UNLESS OTHERWISE SPECIFIED TOLERANCES FOR INCHES ARE: .020 - .315 = \pm 0.007" .315 - 1.180 = \pm 0.015" 1.180 - 4.724 = \pm 0.020"</p> <p>DO NOT SCALE DRAWING</p> | APPROVALS | DATE | <h1 style="color: blue;">Amphenol Connex</h1> <p style="text-align: center;">SMB P.C. MOUNT JACK - 75ohm</p> <p style="text-align: center;">-</p> <p style="text-align: center;">142139</p> | | |
| 7 | | | | | DRAWN | G.R.S. | | 11/01/06 | |
| 6 | | | | | CHECKED | | | | |
| 5 | | | | | ISSUED | | | | |
| 4 | | | | | SHEET | 1 OF 1 | | | |
| 3 | CONTACT PIN | BRASS | GOLD | | 1 | | | | |
| 2 | INSULATOR | TEFLON | NATURAL | | 1 | | | | |
| 1 | BODY | BRASS | GOLD | | 1 | | | | |
| | DESCRIPTION | MATERIAL | FINISH | QTY | CAD FILE | DWG. NO. | REV. | SIZE | SCALE |
| | | | | | C:/142/142139.DWG | 142139.DWG | A | A | NA |