

NOTES:

- 1. MATERIALS OF CONSTRUCTION:  
 BODY = STAINLESS STEEL (ASTM A 582, TYPE 303 COND A NON MAG)  
 GOLD PLATED PER AMPHENOL SPEC. 349-50669  
 FEMALE CONTACT = BeCu (QQ-C-530, ALLOY 173 COND H), GOLD PLATED PER AMPHENOL SPEC. 349-50670  
 INSULATOR = PTFE PER ASTM D 1710 OR EQUIV

901-9704		REVISIONS			
DRAWING NO.	REV	DESCRIPTION	DATE	ECO	APPR
THIRD ANGLE PROJ.	A	RELEASE TO MFG.	6/30/87	34330	RF/JSP
	D	SEE SHEET 1	7/1/02	44086	CPM

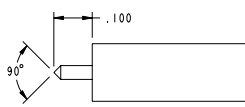
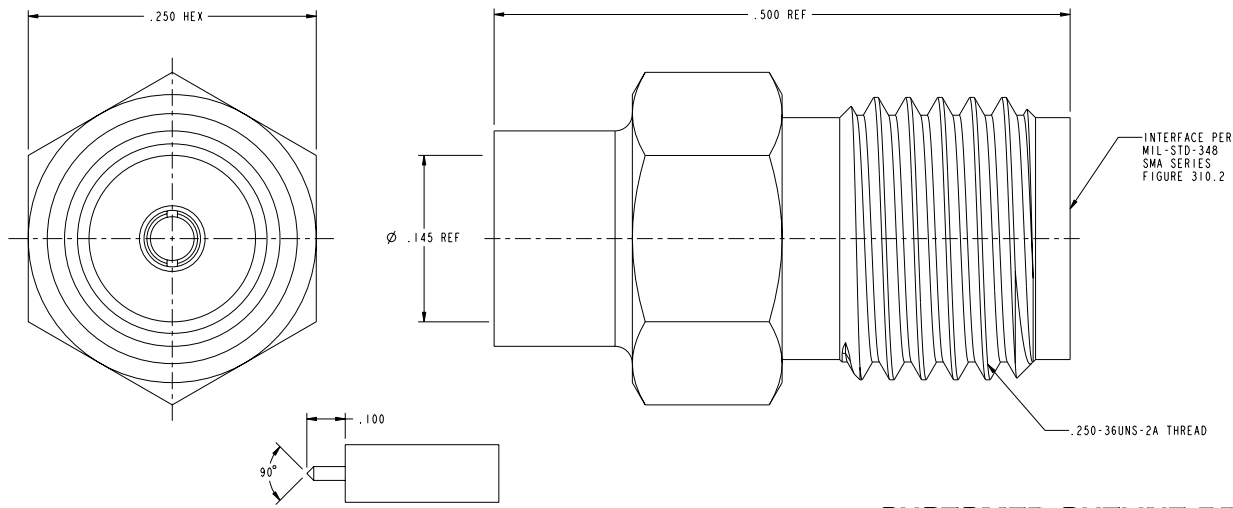
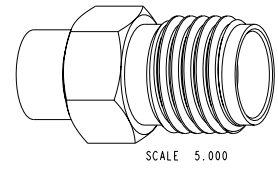

**CUSTOMER OUTLINE DRAWING**  
 ALL OTHER SHEETS ARE FOR INTERNAL USE ONLY

UNLESS OTHERWISE SPECIFIED, DIMENSIONS ARE IN INCHES AND TOLERANCES ARE: 2 PLACE DECIMAL 3 PLACE DECIMAL ANGLES ±.015 (0.381 mm) ±.005 (0.127 mm) ± 1°	MATERIAL  REFERENCE EAR 111-100017 H.P. 1250-1359-1 GEN# ASSYF54.SMA	DRAWN C. McGRATH	DATE 19-Jun-02	TITLE SMA JACK CAPTIVE CONTACT FOR .141 SEMI-RIGID CABLE	Amphenol Amphenol Corporation Communication and Network Products Division Danbury, CT U.S.A. 06810		
		ENGINEER O. BARTHELMES	DATE 19-Jun-02			APPROVED O. BARTHELMES	DATE 26-Jun-02
NOTICE - These drawings, specifications, or other data (1) are, and remain the property of Amphenol Corp. (2) must be returned upon request; and (3) are confidential and not to be disclosed to any person other than those to whom they are given by Amphenol Corp. The furnishing of these drawings, specifications, or other data by Amphenol Corp., or to any other person for any purpose is not to be regarded by implication or otherwise in any manner licensing, granting rights or permitting such holder or any other person to manufacture, use or sell any product, process or design, patented or otherwise, that may in any way be related to or disclosed by said drawings, specifications, or other data.		CAD FILE I:\SMA901-9704	CODE ID 74868	DWG SIZE B	DRAWING NO. 901-9704	SCALE: 12.0:1 SHEET 2 OF 2	REV D