

REV.	DATE	DESCRIPTION
NC	01/29/98	INITIAL RELEASE
A	07/20/05	UPDATE DRAWING FORMAT

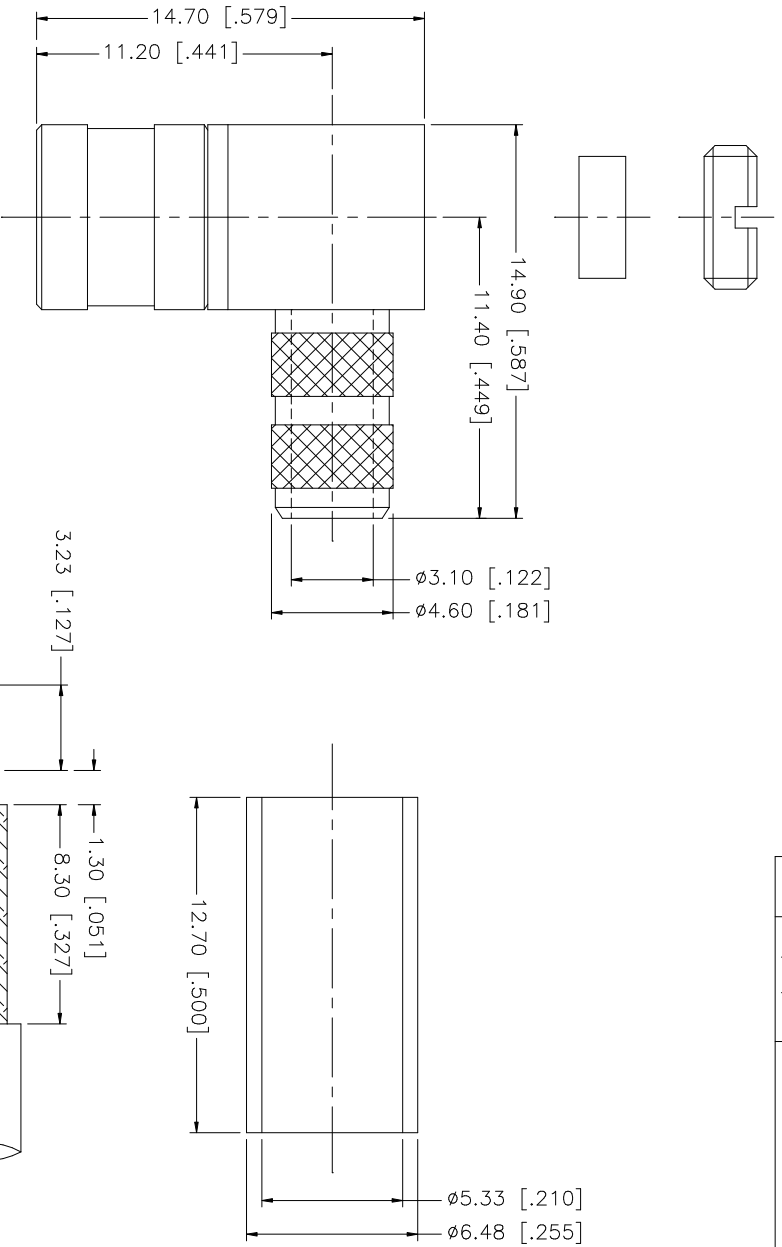

REV.	DATE	DESCRIPTION
8		
7		
6		
5		
4		
3		
2		
1		

DESCRIPTION	MATERIAL	FINISH	QTY	UNLESS OTHERWISE SPECIFIED DIMENSIONS ARE INCHES AND FOR CUSTOMER REFERENCE ONLY*	UNLESS OTHERWISE SPECIFIED TOLERANCES FOR MILLIMETERS ARE:	UNLESS OTHERWISE SPECIFIED DIMENSIONS ARE INCHES AND FOR CUSTOMER REFERENCE ONLY*	UNLESS OTHERWISE SPECIFIED TOLERANCES FOR MILLIMETERS ARE:
FERRULE	COPPER	GOLD	1		0.5 - 8mm $\pm$ 0.20mm		0.20 - .315 = $\pm$ 0.007"
NUT	BRASS	GOLD	1		8 - 30mm $\pm$ 0.40mm		.315 - 1.180 = $\pm$ 0.015"
INSULATOR	P.E.	NATURAL	1		30 - 120mm $\pm$ 0.50mm		1.180 - 4.724 = $\pm$ 0.020"
CONTACT PIN	BER. COPPER	GOLD	1				
INSULATOR	TEFLON	NATURAL	1				
BODY	BRASS	GOLD	1				

APPROVALS	DATE
DRAWN G.R.S.	07//20/05
CHECKED	
ISSUED	
SHEET 1 OF 1	

Amphenol Connex

PART DESCRIPTION  
SMB R/A/ CRIMP PLUG  
(RG-58/U CABLE)

PART NO. 142206

CAD FILE C:/142/142206.DWG

DWG. NO. 142206.DWG

REV. A

SIZE A

SCALE NA

DO NOT SCALE DRAWING