

DRAWING No.: M30-301 XX 46R      IF IN DOUBT - ASK      ©      NOT TO SCALE      THIRD ANGLE PROJECTION      ALL DIMENSIONS IN mm

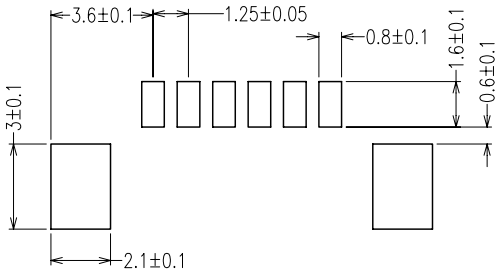
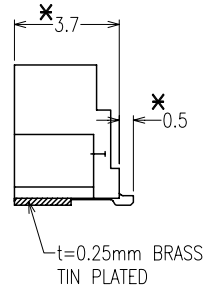
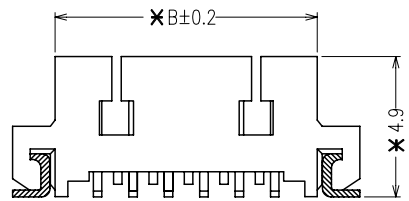
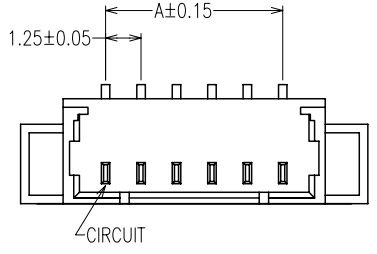

PCB LAYOUT SURFACE MOUNTING

**SPECIFICATIONS:**  
 MATERIAL:-  
 MOULDING: NYLON 9T, UL94V-0  
 CONTACT: PHOSPHOR BRONZE, 0.3MM FLAT PIN  
 FINISH:-  
 TIN PLATED  
 ELECTRICAL:-  
 CURRENT RATING: 1A AC/DC MAX.  
 WORKING VOLTAGE: 100V AC/DC  
 WITHSTAND VOLTAGE: 500V AC/MINUTE  
 CONTACT RESISTANCE: 20 mΩ MAX.  
 INSULATION RESISTANCE: 100 MΩ MIN.  
 ENVIRONMENTAL:-  
 TEMPERATURE RANGE: -25°C TO +85°C  
 OTHERS:-  
 MATE WITH HOUSING M30-130 XX 46

NOTES: ALL DIMENSIONS AND NOTES MARKED \* ARE CRITICAL AND MUST BE CHECKED IN ACCORDANCE WITH QUALITY DOC. QI-02A

NO. OF WAYS	PART NO	DIM (MM)	
		A	B
2	M30-3010246R	1.25	4.25
3	M30-3010346R	2.50	5.50
4	M30-3010446R	3.75	6.75
5	M30-3010546R	5.00	8.00
6	M30-3010646R	6.25	9.25
7	M30-3010746R	7.50	10.50
8	M30-3010846R	8.75	11.75
9	M30-3010946R	10.00	13.00
10	M30-3011046R	11.25	14.25
11	M30-3011146R	12.50	15.50
12	M30-3011246R	13.75	16.75
13	M30-3011346R	15.00	18.00
14	M30-3011446R	16.25	19.25
15	M30-3011546R	17.50	20.50

Allan	4	02.10.08	A166
Allan	3	04.07.08	A141
Allan	2	02.07.08	A139
Allan	1	18.09.06	-

\*NOTE: REMOVE R FOR LOOSE BAG PACKING

ORDER CODE  
**M30-301 XX 46R**  
 NO. OF WAYS  WITH R: REEL PACKING  
 WITHOUT R: LOOSE BAG PACKING  
 (10pcs Per Strip, 10 Strips per Bag)

NAME	ISS.	DATE	C/NOTE
APPROVED: <i>Ben</i>			
CHECKED:			
DRAWN: Allan			
CUSTOMER REF.:			
ASSEMBLY DRG:			

**HARWIN**

THIS DRAWING AND ANY INFORMATION OR DESCRIPTIVE MATTER SET OUT HEREON ARE CONFIDENTIAL AND COPYRIGHT PROPERTY OF THE HARWIN GROUP AND MUST NOT BE DISCLOSED, LOANED, COPIED OR USED FOR MANUFACTURING, TENDERING OR FOR ANY OTHER PURPOSE WITHOUT THEIR WRITTEN PERMISSION.

TOLERANCES  
 X. = ±1mm  
 X.X = ±0.25mm  
 X.XX = ±0.15mm  
 X.XXX = ±0.08mm  
 ANGLES = ±5°  
 UNLESS STATED

MATERIAL: SEE NOTES  
 FINISH: SEE NOTES  
 S/AREA: mm<sup>2</sup>

TITLE: HEADER P=1.25MM SMT STRAIGHT TYPE  
 DRAWING NUMBER: M30-301 XX 46R

HARWIN USA  
 TEL: 603 893 5376  
 FAX: 603 893 5396  
 mis@harwin.com

HARWIN Europe (UK)  
 TEL: 023 9231 4545  
 FAX: 023 9231 4590  
 mis@harwin.co.uk

HARWIN Asia  
 TEL: +65 6 779 4909  
 FAX: +65 6 779 3868  
 mis@harwin.com.sg

SHT 1 OF 1