

INTRODUCTION:

Adam Tech HFCS Series .050" IDC Sockets are low profile, precision designed flat cable sockets that feature either .050" x .100" centerlines or .050" x .050" centerlines. These sockets quickly and easily mass terminate flat cable in one simple step. Their versatility allows them to mate with a multitude of .050" pitch pin headers. Our superior selectively gold plated contact design provides a smooth high pressure wiping action to ensure excellent continuity. They are used with a single layer of .025" flat cable. Their small size, light weight and high density make them ideal for compact and limited space applications.

FEATURES:

- .050" x .050" or .050" x .100"
- Low Profile and High Density
- Uses Single layer .025" Flat Cable
- Quickly and easily mass terminates standard Flat Cable
- Smooth High Pressure Wiping Contacts

MATING CONNECTORS:

Adam Tech .050" HBHR series box headers or HPH2 series pin headers

SPECIFICATIONS:

Material:

Insulator: PBT, glass reinforced, rated UL94V-0
 Insulator Color: Black
 Contacts: Phosphor Bronze

Contact Plating:

Tin over copper underplate overall

Electrical:

Operating voltage: 250V AC max.
 Current rating: 1 Amp max.
 Contact resistance: 20 mΩ max. Initial
 Insulation resistance: 5000 MΩ min.
 Dielectric withstanding voltage: 1000V AC for 1 minute

Mechanical:

Insertion force: 0.312 lbs per contact max.
 Withdrawal force: 0.094 lbs per contact min.
 Recommended wire size: 28 Awg stranded
 Cable retention: 22 lbs. min axial force per inch.
 Mating durability: 500 cycles min.

Temperature Rating:

Operating temperature: -40°C to +105°C

PACKAGING:

Anti-ESD plastic trays

SAFETY AGENCY APPROVALS:

UL Recognized File No. E224053
 CSA Certified File No. LR1578596

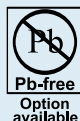

ORDERING INFORMATION

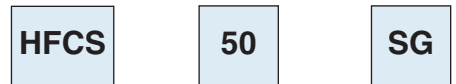

SERIES INDICATOR

- ***HFCS** = Low profile .050" x .100" IDC Socket for single layer .025" Flat Cable
- ***HFCS-A** = Low profile .050" x .050" IDC Socket for single layer .025" Flat Cable
- ****HFDP** = .050" Paddleboard Connector for single layer .025" Flat Cable
- ****FDH** = 4 Row Transition plug

PLATING

- SG** = Selective gold plating in contact area, nickel plating in termination area
- T** = Tin plated (HFDP)

POSITIONS

- HFCS:** 10, 20, 30, 40, 50, 60, 70, 80, 90, 100
- HFCS-A:** 10, 20, 26, 34, 40, 50
- HFDP:** 30, 50, 68, 72, 80, 100
- FDH:** 10, 14, 16, 20, 26, 34, 40, 50, 60

* Denotes RoHS compliant lead-free product
 ** Requires -RC option below to be RoHS compliant

OPTIONS

Add designator(s) to end of part number
RC = RoHS compliant lead-free product with Hi-Temp insulator

.050" IDC SOCKET

.050" X .050" & .050" X .100"
DUAL ROW FLAT CABLE SOCKETS
HFCS SERIES

HFCS-A
.050" X .050"



HFCS-A-34-SG

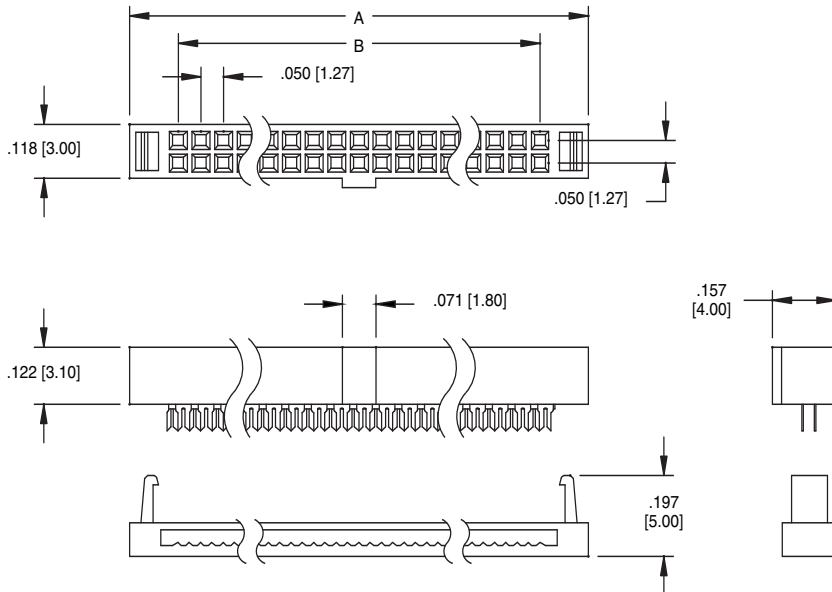

PART No. & POSITIONS	DIMENSIONS	
	A	B
HFCS-A-10	.413 [10.50]	.450 [5.08]
HFCS-A-20	.665 [16.90]	.450 [11.43]
HFCS-A-26	.815 [20.70]	.600 [15.24]
HFCS-A-34	1.016 [25.80]	.800 [20.32]
HFCS-A-40	1.165 [29.60]	.950 [24.13]
HFCS-A-50	1.413 [35.90]	1.200 [30.48]

HFCS
.050" X .100"



HFCS-40-SG

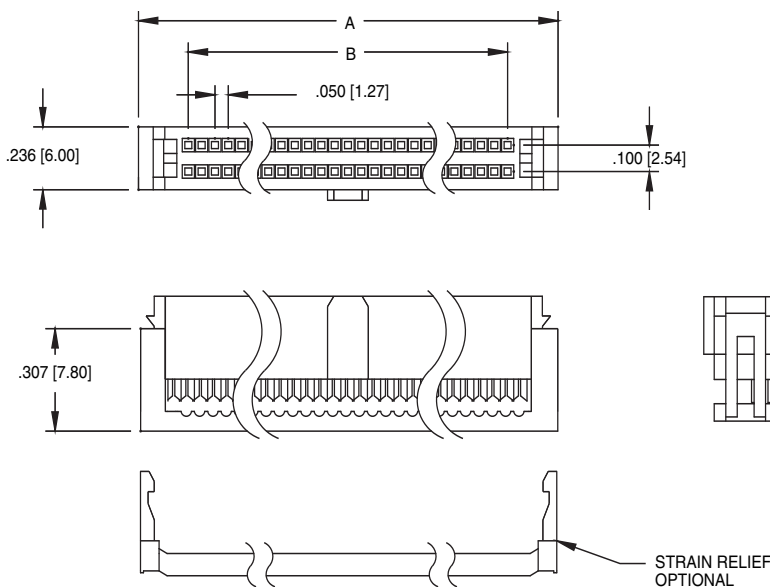

PART No. & POSITIONS	Dimensions	
	A	B
HFCS-10	0.200 (11.10)	0.437 (5.08)
HFCS-20	0.450 (17.45)	0.687 (11.43)
HFCS-30	0.700 (23.80)	0.937 (17.78)
HFCS-40	0.950 (30.15)	1.187 (24.13)
HFCS-50	1.200 (36.50)	1.437 (30.48)
HFCS-60	1.450 (42.85)	1.687 (36.83)
HFCS-70	1.700 (49.20)	1.937 (43.18)
HFCS-80	1.950 (55.55)	2.187 (49.53)
HFCS-90	2.200 (61.90)	2.437 (55.88)
HFCS-100	2.450 (68.25)	2.687 (62.23)