

SCALE 2.000

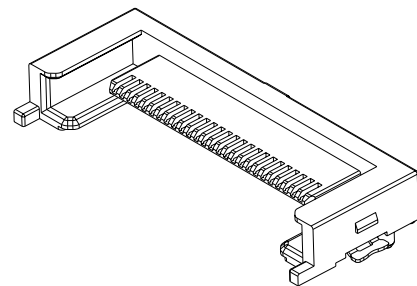

SCALE 2.000

NOTES:

1. MATERIAL:
 HOUSING: HIGH TEMPERATURE THERMOPLASTIC, UL94 V-0 FLAME RETARDANT;
 TERMINAL: COPPER ALLOY, PLATING SPECIFICATION AS BELOW:
 Ni 50u" UNDER PLATED,
 Au OR GXT ON CONTACT AREA (ONE SIDE)
 Tin 120u" VOER SOLDERING AREA
2. PRODUCT PERFORMANCE PER SPECIFICATION GS-12-285;
3. PRODUCT PACKING PER SPECIFICATION GS-14-924;
4. RoHS COMPATIBLE PRODUCT SPECIFICATIONS
- a-PLATING:
 -"LF" MEANS THE PRODUCT IS LEAD-FREE, 2micro-meter MINIMUM MATTE TIN OVER 1.27micro-meter MINIMUM NICKEL UNDERPLATE.
- b-MANUFACTURING PROCESS COMPATIBILITY:
 -THE HOUSING WILL WITHSTAND EXPOSURE TO 260°C±5°C SOLDER BATH TEMPERATURE FOR 5 SECONDS IN A REFLOW SOLDER APPLICATION WITH A 1.6mm MIN THICK CIRCUIT BOARD.
5. PART NUMBER SCHEME:
 10030584-X X X X XLF

MYLAR	
1	WITH
2	WITHOUT
PACKAGING	
1	TUBE (N/A)
2	TAPE AND REEL
3	TRAY
CONTACT PLATING	
1	GOLD 30u"
2	GXT 30u" 4 GXT 15u"
STAND-OFF	
1	±0.0
PLASTIC COLOR	
1	BLACK
2	NATURE

rev	ecn no	dr	date
A	T04-0374	TAI	09/20/2004
B	T05-0024	TAI	01/31/2004
C	T05-0047	TAI	03/07/2005
D	T05-0104	TAI	05/11/2005
E	N08-0069	R.B	04/28/2008
F	N09-0353	R.B	11/04/2009

www.fciconnect.com		surface	tolerance std	projection	MM
		ASME Y14.5			
TOLERANCES UNLESS OTHERWISE SPECIFIED					
Dr	A. JUANG	07/03/03	ANGULAR	0.x ±0.50	size A4 Scale 1.000
Eng	A. JUANG	07/03/03	LINEAR	0.xx ±0.30	
Chr	SCOTT LU	07/03/03	0° ±2°	0.xxx ±0.10	ECN *
Appr	JENN TSAO	07/03/03	Product family EXPRESSCARD		Spec ref *
FCJ		HOST CONNECTOR ASS'Y		orig no	10030584
		EXPRESSCARD		Rev.	F
catalog no		10030584	CUSTOMER	sheet 1 of 3	



Copyright FCJ.

REV F - 2009-04-07

PART NO.	NOTE
10030584-X1XXLF	TOP MOUNT

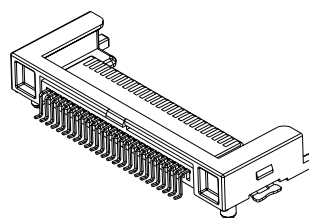
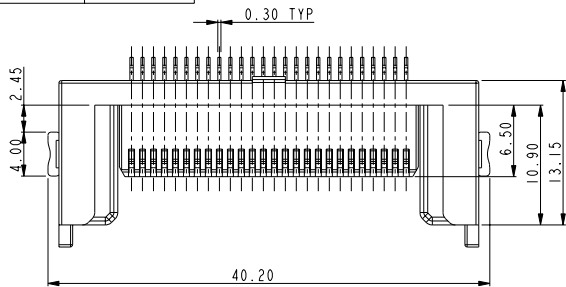

SCALE 1.500

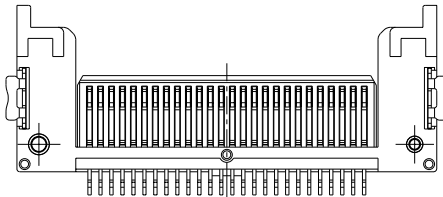
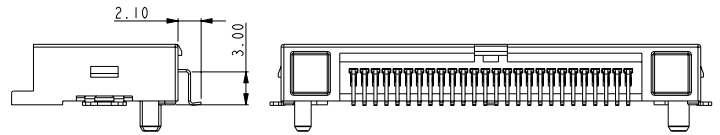
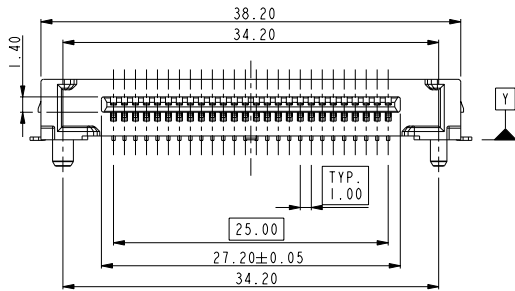
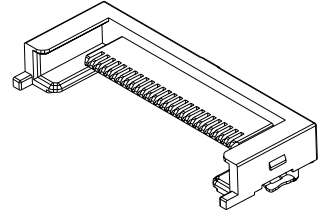

www.fciconnect.com		surface <input checked="" type="checkbox"/>	tolerance std ASME Y14.5	projection	MM
TOLERANCES UNLESS OTHERWISE SPECIFIED				← →	
Dr A. JUANG	07/03/03	ANGULAR	LINEAR	0.x ±0.50	size A4 Scale 1.000
Eng A. JUANG	07/03/03	0° ±2°		0.xx ±0.30	
Chr SCOTT LU	07/03/03			0.xxx ±0.10	ECN *
Appr JENN TSAO	07/03/03	Product family EXPRESSCARD		Spec ref	
	HOST CONNECTOR ASS'Y		dwg no	10030584	Rev. F
	EXPRESSCARD		catalog no	10030584	CUSTOMER
					sheet 2 of 3

REV F - 2008-04-07

3PDM: Rev:F

STATUS Released

4 Printed: Oct 12, 2010

FCJ
Copyright FCI.

FCI CONFIDENTIAL



This document is the property of and embodies CONFIDENTIAL and PROPRIETARY information of FCI. No part of the information shown on this document may be used in any way or disclosed to others without the written consent of FCI. Copyright FCI.

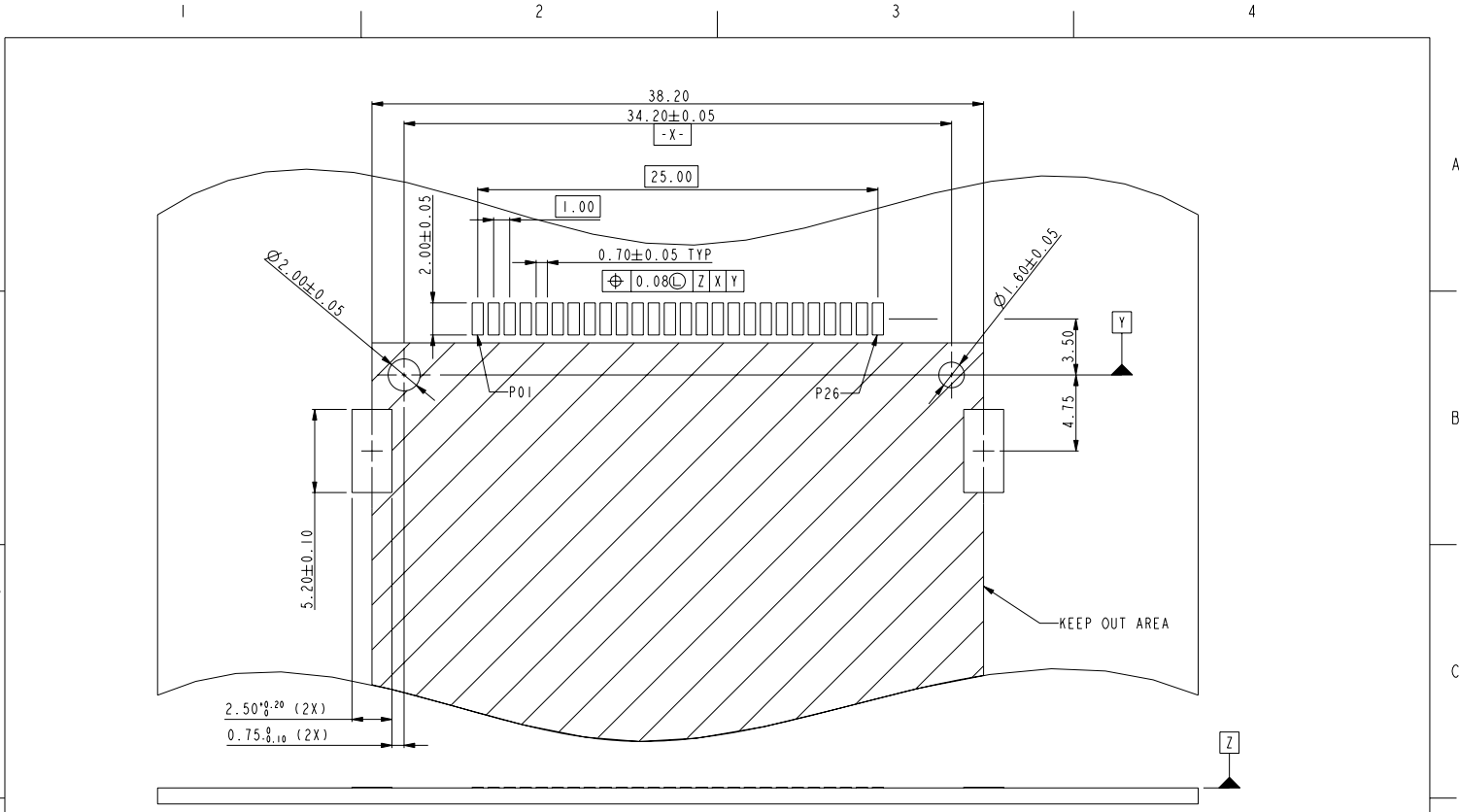

Material	SEE NOTE	Spec ref	*
Mat code	-	surface	✓ tolerance ASME Y14.5
Heat treat	-	projection	⊕
Plating/Finish	-	size	A4
Dr	A. JUANG 07/03/03	Product family	EXPRESSCARD
Eng	A. JUANG 07/03/03	Model Name	10030584
Chr	SCOTT LU 07/03/03	Model Revision	C
Appr	JENN TSAO 07/03/03	REL Level	proi..release
FCI logo	HOST CONNECTOR ASS'Y	eng no	10030584
title	EXPRESSCARD	Rev.	F
Proj/E file	catalog no	10030584	CUSTOMER
		sheet	3 of 3

3 PDM: Rev:F STATUS Released 4 Printed: Oct 12, 2010