

Customer Information Sheet

DRAWING No.: D8864-42

SHEET 2 OF 2

IF IN DOUBT - ASK

©

NOT TO SCALE

THIRD ANGLE PROJECTION

ALL DIMENSIONS IN mm

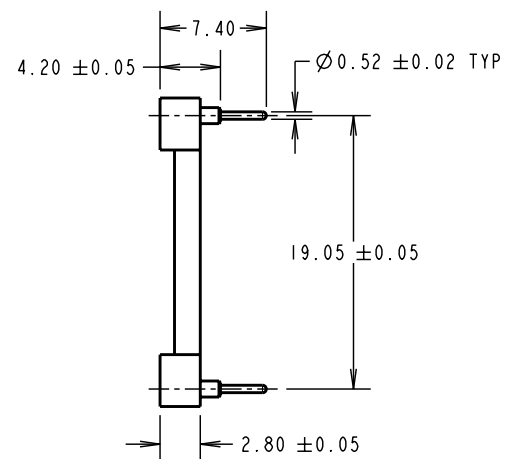
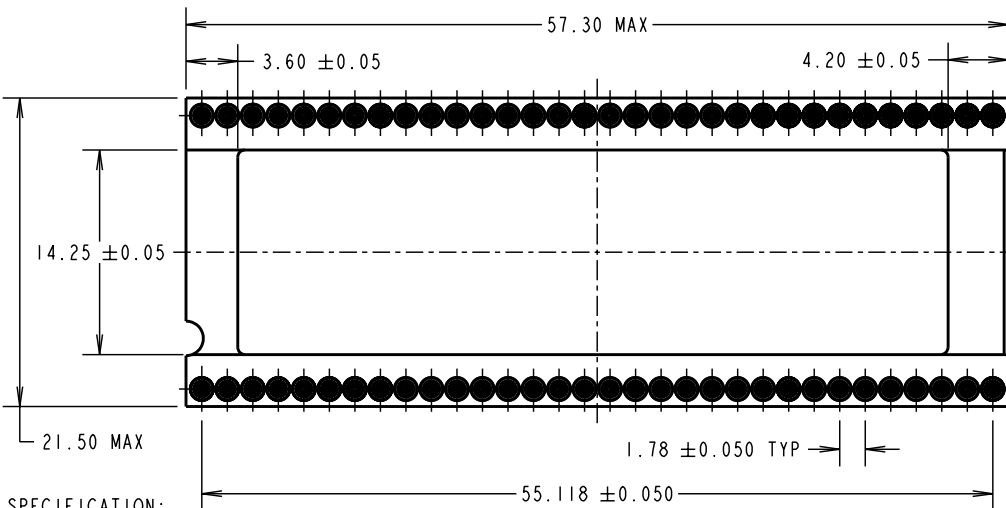

SPECIFICATION:

MATERIAL:
 MOULDING = GLASS FILLED PCT UL94V-0, BLACK
 CONTACT SHELL = BRASS
 CONTACT CLIP = BERYLLIUM COPPER

FINISH:
 CONTACT SHELL = 5µ 100% TIN
 CONTACT CLIP = GOLD FLASH

ELECTRICAL:
 CURRENT RATING = 1A
 VOLTAGE RATING = 100V AC, 150V DC
 CONTACT RESISTANCE = 10 MILLIOHMS MAX
 INSULATION RESISTANCE = 10,000 MEGOHMS MIN
 DIELECTRIC STRENGTH = 700V AC

ENVIRONMENTAL:
 TEMPERATURE RANGE = -55°C TO +125°C

MECHANICAL:
 INSERTION FORCE (Ø0.43mm GAUGE) = 3.4N MAX
 WITHDRAWAL FORCE (Ø0.43mm GAUGE) = 0.6N MIN

- NOTES:**
1. RECOMMENDED HOLE SIZE = Ø0.80mm.
 2. RECOMMENDED MATING PIN SIZE = Ø0.56-0.40mm OR 0.25mm x 0.45mm.
 3. RECOMMENDED PC BOARD THICKNESS = 1.4 TO 2.0mm
 4. MAXIMUM CONTACT DEPTH = 2.20mm.
 MAXIMUM MATING PIN LENGTH = 3.55mm.

CP	2	15.01.10	10640
NAME	ISS.	DATE	C/NOTE
APPROVED: C.PENROSE			
CHECKED: R.ADDE			
DRAWN: W.J.BOURNE			
CUSTOMER REF.:			
ASSEMBLY DRG:			

HARWIN

HARWIN USA TEL: 603 893 5376 FAX: 603 893 5396 mis@harwin.com	HARWIN Europe (UK) TEL: 023 9231 4545 FAX: 023 9231 4590 mis@harwin.co.uk	HARWIN Asia TEL: +65 6 779 4909 FAX: +65 6 779 3868 mis@harwin.com.sg
--	--	--

THIS DRAWING AND ANY INFORMATION OR DESCRIPTIVE MATTER SET OUT HEREON ARE CONFIDENTIAL AND COPYRIGHT PROPERTY OF THE HARWIN GROUP AND MUST NOT BE DISCLOSED, LOANED, COPIED OR USED FOR MANUFACTURING, TENDERING OR FOR ANY OTHER PURPOSE WITHOUT THEIR WRITTEN PERMISSION.

TOLERANCES
 X. = ±1mm
 X.X = ±0.25mm
 X.XX = ±0.10mm
 X.XXX = ±0.01mm
 ANGLES = ±5°
 UNLESS STATED

MATERIAL:
 SEE ABOVE

FINISH:
 SEE ABOVE

S/AREA:
 mm²

TITLE:
 1.778mm (0.07") PITCH 64-WAY
 DIL IC SOCKET (SHRINK-DIP)

DRAWING NUMBER:
 D8864-42

SHT
 2 OF 2