

Customer Information Sheet

DRAWING No.: D39XX-42

SHEET 2 OF 2

IF IN DOUBT - ASK

©

NOT TO SCALE

THIRD ANGLE PROJECTION

ALL DIMENSIONS IN mm

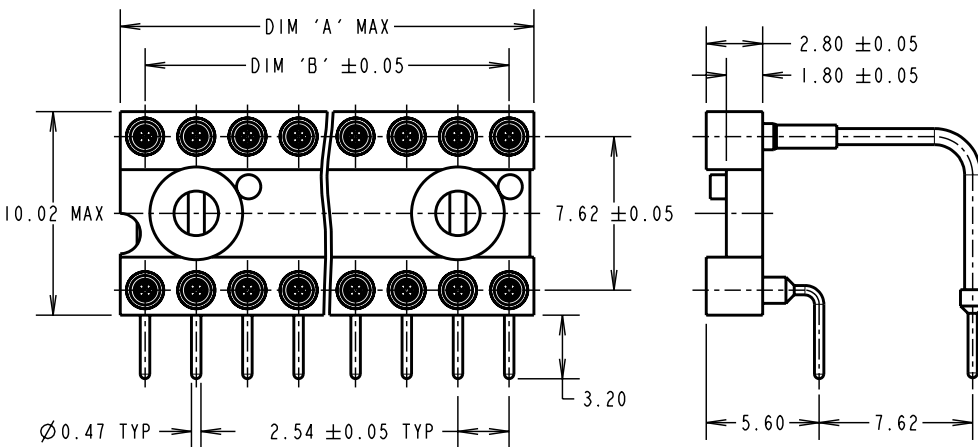

SPECIFICATIONS:

MATERIALS:

MOULDING = GLASS FILLED PCT, BLACK, UL94V-0
CONTACT SHELL = BRASS
CONTACT CLIP = BERYLLIUM COPPER

FINISH:

CONTACT SHELL = 5µ 100% TIN
CONTACT CLIP = 0.25µ GOLD

ELECTRICAL:

CURRENT RATING = 1A
VOLTAGE RATING = 100V AC, 150V DC
CONTACT RESISTANCE = 10 MILLIOHMS MAX
INSULATION RESISTANCE = 10,000 MEGOHMS MIN
DIELECTRIC WITHSTANDING = 1,000V AC MIN

MECHANICAL:

INSERTION FORCE (Ø0.43mm GAUGE) = 3.0N MAX
WITHDRAWAL FORCE (Ø0.43mm GAUGE) = 0.5N MIN
DURABILITY = 100 CYCLES MIN

ENVIRONMENTAL:

TEMPERATURE RANGE = -55°C TO +125°C

ORDER CODE:

D39XX-42

No. OF CONTACTS _____
6, 8, 14, 16, 18, 20, 24

FINISH _____
100% TIN SHELL, GOLD CLIP

NOTES:

1. RECOMMENDED HOLE SIZE = Ø0.80mm.
2. RECOMMENDED PC BOARD THICKNESS = 1.4 TO 2.0mm.
3. RECOMMENDED MATING PIN DIAMETER = Ø0.56-0.40mm.
4. MAXIMUM CONTACT DEPTH = 2.40mm.
MAXIMUM MATING PIN LENGTH = 3.65mm.

PART No.	No. OF CONTACTS	DIM 'A'	DIM 'B'
D3906-42	6	7.60	5.08
D3908-42	8	10.10	7.62
D3914-42	14	17.70	15.24
D3916-42	16	20.30	17.78
D3918-42	18	22.80	20.32
D3920-42	20	25.30	22.86
D3924-42	24	30.40	27.94

CP	2	15.01.10	10640
----	---	----------	-------

NAME	ISS.	DATE	C/NOTE
------	------	------	--------

APPROVED: C. PENROSE

CHECKED: R. ADDE

DRAWN: W. J. BOURNE

CUSTOMER REF.:

ASSEMBLY DRG:

HARWIN

HARWIN USA
TEL: 603 893 5376
FAX: 603 893 5396
mis@harwin.com

HARWIN Europe (UK)
TEL: 023 9231 4545
FAX: 023 9231 4590
mis@harwin.co.uk

HARWIN Asia
TEL: +65 6 779 4909
FAX: +65 6 779 3868
mis@harwin.com.sg

THIS DRAWING AND ANY INFORMATION OR DESCRIPTIVE MATTER SET OUT HEREON ARE CONFIDENTIAL AND COPYRIGHT PROPERTY OF THE HARWIN GROUP AND MUST NOT BE DISCLOSED, LOANED, COPIED OR USED FOR MANUFACTURING, TENDERING OR FOR ANY OTHER PURPOSE WITHOUT THEIR WRITTEN PERMISSION.

TOLERANCES

X. = ±1mm
X.X = ±0.25mm
X.XX = ±0.10mm
X.XXX = ±0.01mm
ANGLES = ±5°
UNLESS STATED

MATERIAL:

SEE ABOVE

FINISH: SEE ABOVE

S/AREA: mm²

TITLE:

2.54mm PITCH DIL
IC DISPLAY SOCKET
(CLOSED FRAME)

DRAWING NUMBER:

D39XX-42

SHT

2 OF 2