

- NOTES:
- PRESS FIT LEGS, 0.120 INCHES LONG.  
1.57 [0.062] MINIMUM PCB THICKNESS.
  - THIS CAGE IS FOR SINGLE SIDED USE ONLY.
  - CAN BE USED WITH THE FOLLOWING LIGHT PIPE PART NUMBERS:  
747260001 - LIGHT PIPE FROM BACK TO TOP  
(REFER TO DOCUMENT SD-74726-001)  
747260002 - LIGHT PIPE FROM SIDE TO TOP  
(REFER TO DOCUMENT SD-74726-002)
  - MATERIAL: COPPER ALLOY  
PLATING: PRE-PLATED WITH NICKEL
  - THIS PART MEETS THE RESTRICTION OF HAZARDOUS SUBSTANCES IN ELECTRICAL AND ELECTRONIC EQUIPMENT (ROHS) DIRECTIVE (2002/95/EC).

REV DWS: CAGE REV E: MSL: 200-055 C: DRAWN: JRESENDE 2009/09/28 CHK: KX: JANTIA APPR: J. JANTIA	QUALITY SYMBOLS	GENERAL TOLERANCES (UNLESS SPECIFIED)	DIMENSION STYLE	SCALE	DESIGN UNITS	THIRD ANGLE PROJECTION	
	$\nabla=0$ $\nabla=0.005$	(UNLESS SPECIFIED) 4 PLACES ± 0.01 INCH 3 PLACES ± 0.005 INCH 2 PLACES ± 0.01 INCH 1 PLACE ± 0.25 INCH ANGULAR ± 1°	MM/IN DATE DRAWN BY: JRESENDE 2009/09/28 CHECKED BY: DATE APPROVED BY: DATE JRESENDE 2009/09/28	5:1	METRIC	<input checked="" type="checkbox"/> THIRD ANGLE PROJECTION	
	DRAFT WHERE APPLICABLE MUST REMAIN WITHIN DIMENSIONS	MATERIAL NO. 747370033	DOCUMENT NO. SD-74737-0033	SFP ONE PIECE CAGE PRESS-FIT (0.120 LEGS) W/ MODIFIED LATCH TANG MOLEX INCORPORATED			
							SHEET NO. 1 OF 3

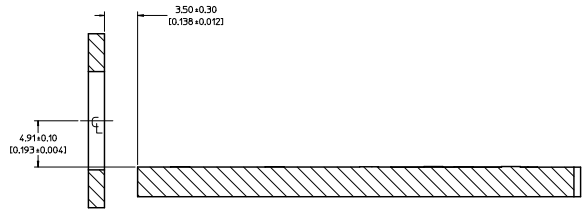

20 19 18 17 16 15 14 13 12 11 10 9 8 7 6 5 4 3 2 1

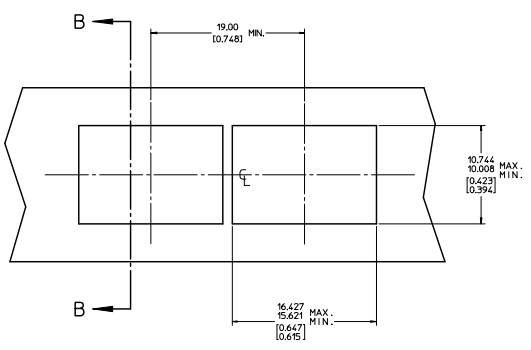
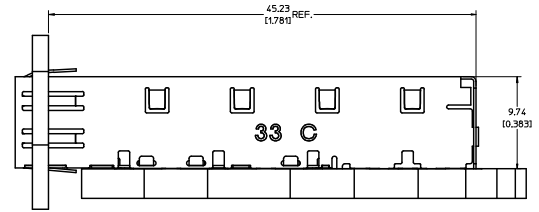

SECTION B-B

REV DIMS: CAGE REV REV NO: 2009-09-28 DRAWN BY: JRESENDE CHECKED BY: JRESENDE APPROVED BY: JRESENDE DATE: 2009/09/28	QUALITY SYMBOLS	GENERAL TOLERANCES (UNLESS SPECIFIED)	DIMENSION STYLE	SCALE	DESIGN UNITS	THIRD ANGLE PROJECTION														
	▽ 0 ▽ 0	<table border="1"> <thead> <tr> <th></th> <th>mm</th> <th>INCH</th> </tr> </thead> <tbody> <tr> <td>4 PLACES ± ---</td> <td>± 0.005</td> <td>± 0.001</td> </tr> <tr> <td>3 PLACES ± ---</td> <td>± 0.005</td> <td>± 0.001</td> </tr> <tr> <td>2 PLACES ± 0.13</td> <td>± 0.01</td> <td>± 0.005</td> </tr> <tr> <td>1 PLACE ± 0.25</td> <td>± 0.01</td> <td>± 0.005</td> </tr> </tbody> </table>		mm	INCH	4 PLACES ± ---	± 0.005	± 0.001	3 PLACES ± ---	± 0.005	± 0.001	2 PLACES ± 0.13	± 0.01	± 0.005	1 PLACE ± 0.25	± 0.01	± 0.005	MM/IN 5:1 METRIC	5:1 METRIC	THIRD ANGLE PROJECTION
		mm	INCH																	
	4 PLACES ± ---	± 0.005	± 0.001																	
3 PLACES ± ---	± 0.005	± 0.001																		
2 PLACES ± 0.13	± 0.01	± 0.005																		
1 PLACE ± 0.25	± 0.01	± 0.005																		
DRAFT WHERE APPLICABLE MUST REMAIN WITHIN DIMENSIONS	DRAWN BY: JRESENDE CHECKED BY: JRESENDE APPROVED BY: JRESENDE DATE: 2009/09/28	TITLE: SFP ONE PIECE CAGE PRESS-FIT (0.120 LEGS) W/ MODIFIED LATCH TANG	MATERIAL NO.: 747370033 DOCUMENT NO.: SD-74737-0033	SHEET NO.: 3 OF 3																
THIS DRAWING CONTAINS INFORMATION THAT IS PROPRIETARY TO MOLEX INCORPORATED AND SHOULD NOT BE USED WITHOUT WRITTEN PERMISSION																				

19 18 17 16 15 14 13 12 11 10 9 8 7 6 5 4 3 2 1

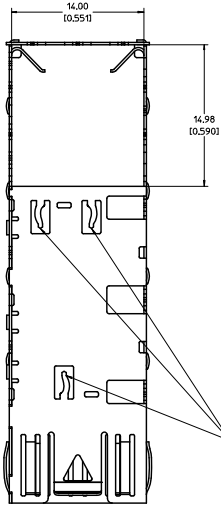

EMI PINS REMAIN FLAT. NO THROUGH HOLES IN PCB NECESSARY.

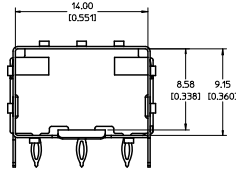
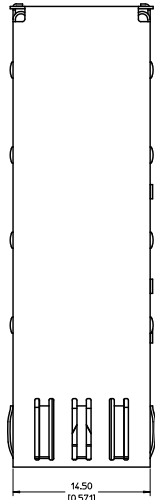

SPRING FINGER GASKET WITH TWO POINTS OF CONTACT. COMPLIES WITH (SFP) MSA BOARD AND BEZEL LOCATIONS.

TABS USED TO MOUNT LIGHT PIPE COVER

CAGE IDENTIFICATION LAST 2 DIGITS P/N AND REV LETTER (ex: 36 X)

ONE PIECE DESIGN SECURELY FASTENED

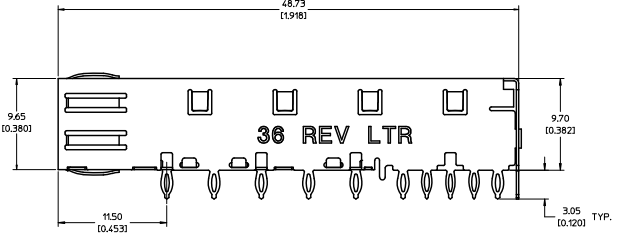
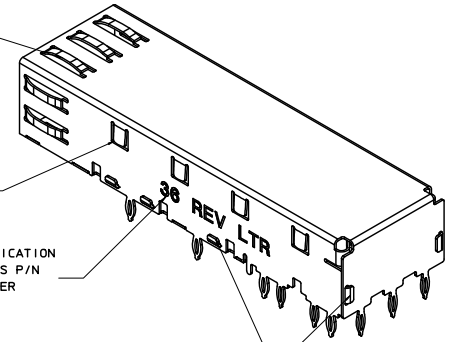

NOTES:

1. PRESS FIT LEGS, 0.120 INCHES LONG. 1.57 [0.062] MINIMUM PCB THICKNESS.
2. THIS CAGE IS FOR SINGLE SIDED USE ONLY.
3. CAN BE USED WITH THE FOLLOWING LIGHT PIPE PART NUMBERS:

747260001 - LIGHT PIPE FROM BACK TO TOP (REFER TO DOCUMENT SD-74726-001)

747260002 - LIGHT PIPE FROM SIDE TO TOP (REFER TO DOCUMENT SD-74726-002)

4. MATERIAL: COPPER ALLOY PLATING: PRE-PLATED WITH NICKEL

5. THIS PART MEETS THE RESTRICTION OF HAZARDOUS SUBSTANCES IN ELECTRICAL AND ELECTRONIC EQUIPMENT (ROHS) DIRECTIVE (2002/95/EC).

INITIAL RELEASE DATE: 2010/08/18 DRAWN BY: JERWIN CHECKED BY: A. JOHNSTON APPROVED BY: J. ANOTA	QUALITY SYMBOLS	GENERAL TOLERANCES (UNLESS SPECIFIED)		DIMENSION STYLE	SCALE	DESIGN UNITS	THIRD ANGLE PROJECTION
	▽=0	mm	INCH	MM/IN	5:1	METRIC	⊙
	▽=0	4 PLACES ± 0.13	± 0.005				
		3 PLACES ± 0.13	± 0.01				
		2 PLACES ± 0.25	± 0.01				
		1 PLACE ± 0.25	± 0.01				
		ANGULAR ± 1°					
		DRAFT WHERE APPLICABLE MUST REMAIN WITHIN DIMENSIONS					
		MATERIAL NO.	747370036	DOCUMENT NO.	SD-74737-0036	SHEET NO. 1 OF 4	
		THIS DRAWING CONTAINS INFORMATION THAT IS PROPRIETARY TO MOLEX INCORPORATED AND SHOULD NOT BE USED WITHOUT WRITTEN PERMISSION					



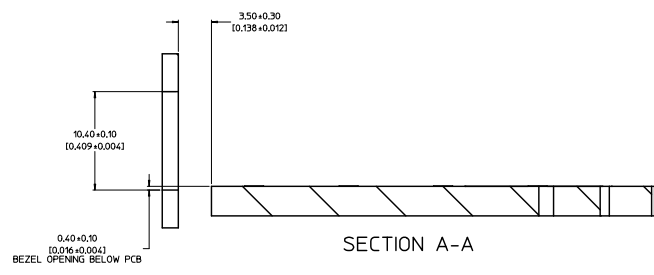
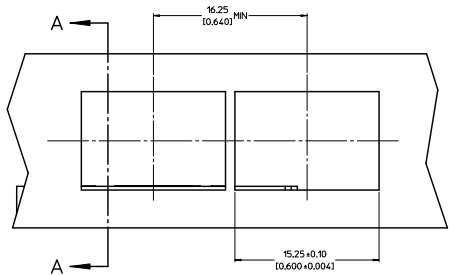
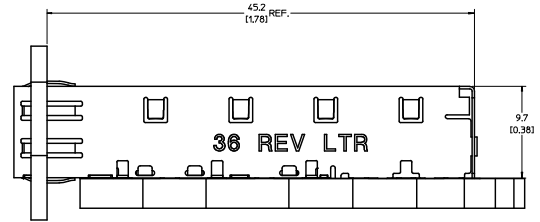

INITIAL RELEASE E.C. UNLESS SPECIFIED DRAWN BY: JERWIN 2010/08/18 CHECKED BY: AJOHNSTON 2010/08/18 APPROVED BY: KJANOTA 2010/08/26 DESCRIPTION: SFP ONE PIECE CAGE	QUALITY SYMBOLS	GENERAL TOLERANCES (UNLESS SPECIFIED)	DIMENSION STYLE	SCALE	DESIGN UNITS	THIRD ANGLE PROJECTION	
	▽=0 ▽=0.05	4 PLACES ± --- ± --- 3 PLACES ± --- ± 0.005 2 PLACES ± 0.13 ± 0.01 1 PLACE ± 0.25 ± --- ANGULAR ± 1 °	MM/IN	5:1	METRIC		
		DRAWN BY: JERWIN 2010/08/18	DATE	2010/08/18	TITLE	SFP ONE PIECE CAGE	
		CHECKED BY: AJOHNSTON 2010/08/18	DATE	2010/08/18	TITLE	PRESS-FIT (0.120 LEGS) NO EMI PINS	
	APPROVED BY: KJANOTA 2010/08/26	DATE	2010/08/26			MOLEX INCORPORATED	
		MATERIAL NO.	747370036	DOCUMENT NO.	SD-74737-0036	SHEET NO. 3 OF 4	
		DRAFT WHERE APPLICABLE MUST REMAIN WITHIN DIMENSIONS					THIS DRAWING CONTAINS INFORMATION THAT IS PROPRIETARY TO MOLEX INCORPORATED AND SHOULD NOT BE USED WITHOUT WRITTEN PERMISSION



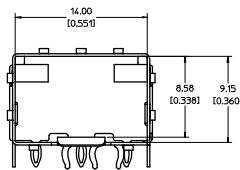
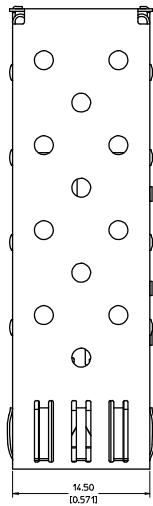
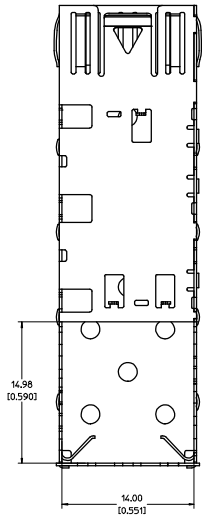

SPRING FINGER GASKET WITH TWO POINTS OF CONTACT. COMPLIES WITH (SFP) MSA BOARD AND BEZEL LOCATIONS.

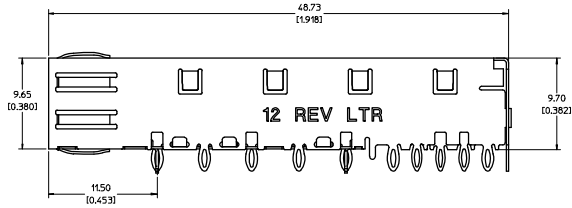
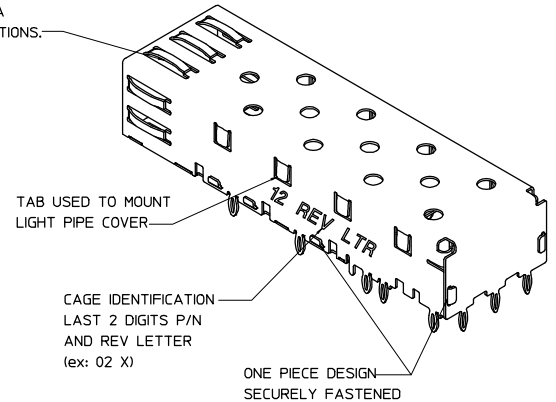

NOTES:

- PRESS FIT LEGS, 0.090 INCHES LONG. 157 [0.062] MINIMUM PCB THICKNESS.
- THIS CAGE IS FOR SINGLE SIDED USE ONLY.
- CAN BE USED WITH THE FOLLOWING LIGHT PIPE PART NUMBERS:
  - 747260001 - LIGHT PIPE FROM BACK TO TOP (REFER TO DOCUMENT SD-74726-001)
  - 747260002 - LIGHT PIPE FROM SIDE TO TOP (REFER TO DOCUMENT SD-74726-002)
- MATERIAL: COPPER ALLOY  
PLATING: PRE-PLATED WITH NICKEL
- THIS PART MEETS THE RESTRICTION OF HAZARDOUS SUBSTANCES IN ELECTRICAL AND ELECTRONIC EQUIPMENT (ROHS) DIRECTIVE (2002/95/EC).

UPDATE & REV. SHEET ELC INC. 2008-2012 DRAWING CODE: 2007/11/05 CHKD: 2007/11/06 APPROVED: 2007/11/07	QUALITY SYMBOLS	GENERAL TOLERANCES (UNLESS SPECIFIED)	DIMENSION STYLE	SCALE	DESIGN UNITS	THIRD ANGLE PROJECTION
	$\nabla$ 0 $\nabla$ 0.05 $\nabla$ 0.13 $\nabla$ 0.25	4 PLACES ± 0.05 ± 0.005 3 PLACES ± 0.13 ± 0.01 2 PLACES ± 0.25 ± 0.05 1 PLACE ± 0.25 ± 0.05 ANGULAR ± 1°	MM/IN	5:1	METRIC	<input checked="" type="checkbox"/> THIRD ANGLE PROJECTION <input type="checkbox"/> FIRST ANGLE PROJECTION
	DRAWN BY: CCX CHECKED BY: RMAHMOOD	DATE: 2007/01/17	TITLE: SFP ONE PIECE CAGE W/009 LEG DESIGN SALES DRAWING	MOLEX INCORPORATED		
	DRAFT WHERE APPLICABLE MUST REMAIN WITHIN DIMENSIONS	MATERIAL NO: 747370012	DOCUMENT NO: SD-74737-012	SHEET NO: 1 OF 4		





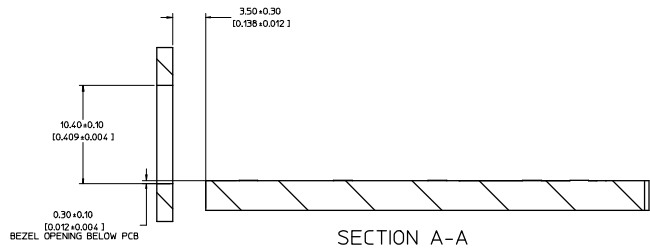
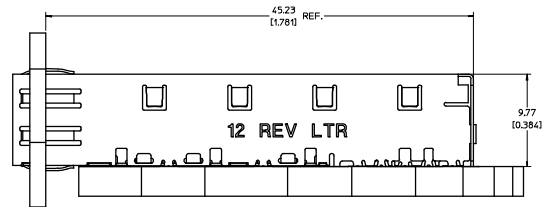
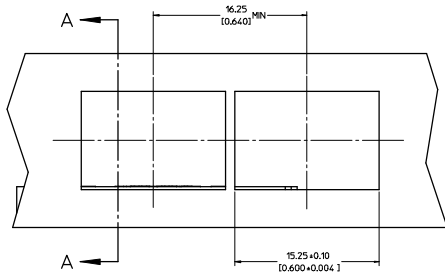

UPDATE & REV. SHEET ELEC. US. 23085-002 DRAWN BY: CCOX CHKD: CCOX APPR. NAME: CCOX DATE: 2007/12/09 DATE: 2007/12/09 DATE: 2007/12/09	QUALITY SYMBOLS	GENERAL TOLERANCES (UNLESS SPECIFIED)	DIMENSION STYLE	SCALE	DESIGN UNITS	THIRD ANGLE PROJECTION																
	▽=0 ▽=0.1	<table border="1"> <thead> <tr> <th></th> <th>mm</th> <th>INCH</th> </tr> </thead> <tbody> <tr> <td>4 PLACES ± ---</td> <td>± ---</td> <td>± ---</td> </tr> <tr> <td>3 PLACES ± ---</td> <td>± 0.05</td> <td>± ---</td> </tr> <tr> <td>2 PLACES ± 0.13</td> <td>± 0.1</td> <td>± ---</td> </tr> <tr> <td>1 PLACE ± 0.25</td> <td>± ---</td> <td>± ---</td> </tr> </tbody> </table>		mm	INCH	4 PLACES ± ---	± ---	± ---	3 PLACES ± ---	± 0.05	± ---	2 PLACES ± 0.13	± 0.1	± ---	1 PLACE ± 0.25	± ---	± ---	DRAWN BY: CCOX DATE: 2007/01/17 CHECKED BY: RMAHM000 DATE: 2007/01/17 APPROVED BY: RMAHM000 DATE: 2007/01/17	MM/IN	5:1	METRIC	<input checked="" type="checkbox"/> THIRD ANGLE <input type="checkbox"/> PROJECTION
		mm	INCH																			
	4 PLACES ± ---	± ---	± ---																			
3 PLACES ± ---	± 0.05	± ---																				
2 PLACES ± 0.13	± 0.1	± ---																				
1 PLACE ± 0.25	± ---	± ---																				
DESCRIPTION	MATERIAL NO. 747370012 DOCUMENT NO. SD-74737-012	SFP ONE PIECE CAGE W/009 LEG DESIGN SALES DRAWING		MOLEX INCORPORATED		SHEET NO. 3 OF 4																
DRAFT WHERE APPLICABLE MUST REMAIN WITHIN DIMENSIONS	THIS DRAWING CONTAINS INFORMATION THAT IS PROPRIETARY TO MOLEX INCORPORATED AND SHOULD NOT BE USED WITHOUT WRITTEN PERMISSION																					

