

This document is the property of Amphenol Corporation and is delivered on the express condition that it is not to be disclosed, reproduced or used, in whole or in part, for manufacture or sale by anyone other than Amphenol Corporation without its prior consent, and that no right is granted to disclose or to use any information in this document.

\*\* THIS PRODUCT DIDN'T HAVE ENVIRONMENT- RELATED SUBSTANCES PER MATERIALS SPECIFICATION #MS-S001, LEVEL 1. WHEN THE TIME SET SCHEDULE OF LEVEL 2 IS EXPIRY, THE SUBSTANCES SHALL NOT BE CONTAINED WITH THIS PRODUCT.

# CUSTOMER DRAWING

REVISIONS				
SYM	ECN No.	DESCRIPTION	DATE	APPROVED
A		RELEASE TO PRODUCTION	10/25/2005	Henry Ko

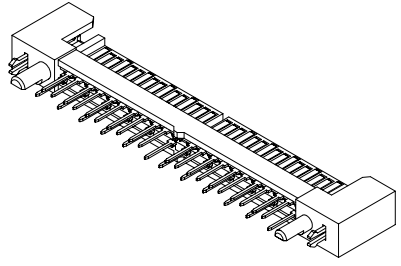
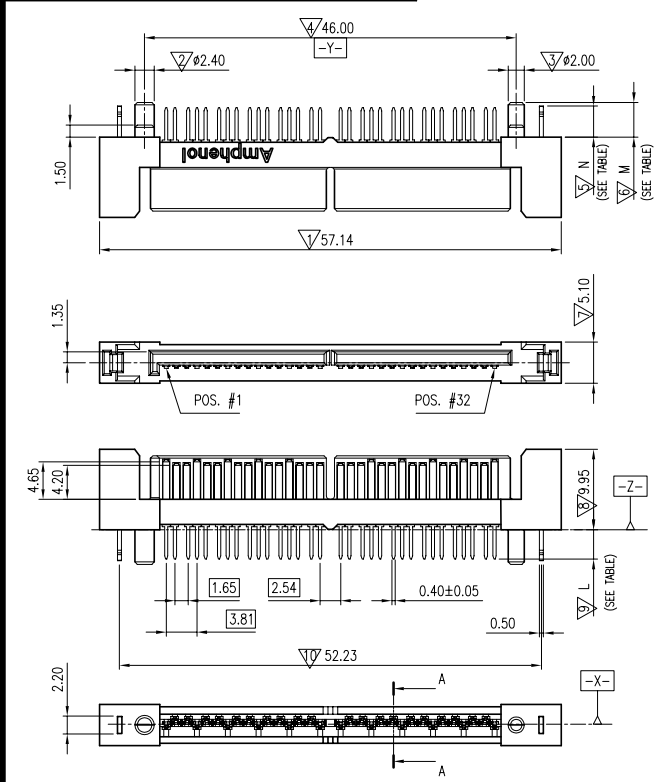

P/N SYSTEM:  
G38A 2 X X 1 4 A EU

CONTACT FINISH:  
0: GOLD FLASH  
1: 15u" GOLD  
2: 30u" GOLD

PACKAGING CODE:  
A: TRAY PACKAGING

TERMINAL STYLE:  
2: DIP 2.54mm TAIL (FOR 1.57 mm PCB)  
7: DIP 3.65mm TAIL (FOR 2.67 mm PCB)

MATERIAL OF INSULATION:  
4: NYLON 9T+45%GF, BLACK

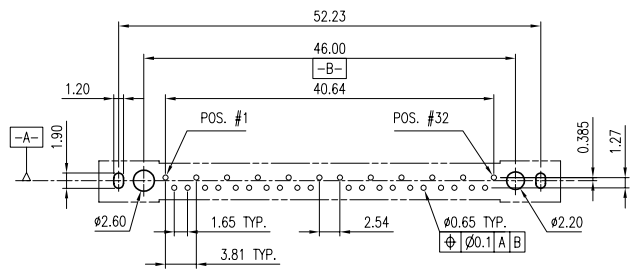
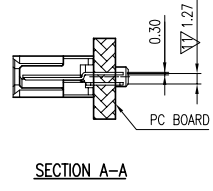

PART NUMBER	PC BOARD THICKNESS	PC TAIL LENGTH "L"	PEG LENGTH "M"	BOARDLOCK LENGTH "N"
G38A 2 X 714 AEU	2.67±0.1	3.65±0.2	4.3±0.1	3.85±0.2
G38A 2 X 214 AEU	1.57±0.1	2.54±0.2	3.2±0.1	2.75±0.2

- NOTES:
- HOUSING: NYLON 9T+ 45%G/F, UL 94V-0, COLOR- BLACK
  - CONTACT: PHOSPHOR BRONZE, 0.3mm THICKNESS, SELECTIVE GOLD OVER NICKEL PLATED ON CONTACT AREA, TIN OVER NICKEL PLATED ON TERMINAL AREA
  - BOARDLOCK: PHOSPHOR BRONZE, 0.5mm THICKNESS, TIN OVER NICKEL PLATED
  - THIS PRODUCT DOESN'T CONTAIN ENVIRONMENTAL HAZARDOUS MATERIALS PER MATERIAL SPECIFICATION #MS-S001.
  - THE DIMENSIONS MARKED  $\nabla$  WILL BE CHECKED BY Q.C. AND PROCESS ENGINEERS.

TOLERANCE m/m	APPROVALS	DATE
x. ±0.30	DRAWN	
x.x ±0.25	DESIGNED	
x.xx ±0.15	CHECKED	
x.xxx ±0.05	APPROVED	
ANGULAR ±2'		

TITLE  
SAS BACKPLANE CONNECTOR  
32- POS., 4- PORT  
MALE, DIP TYPE  
VERTICAL TYPE

**Amphenol®**  
Amphenol Corporation  
Amphenol Taiwan Corporation

SCALE N.A. SHEET 1 OF 1

DRAWING NO. T367-G38A2X214AEU-34

REV. A

UNLESS OTHERWISE SPECIFIED	UNIT MM	SIZE A4	PART NO. G38A 2XX 14AEU	DRAWING NO. T367-G38A2X214AEU-34	REV. A
----------------------------	---------	---------	-------------------------	----------------------------------	--------