

**Recommended PCB Layout
(Bottom View)**

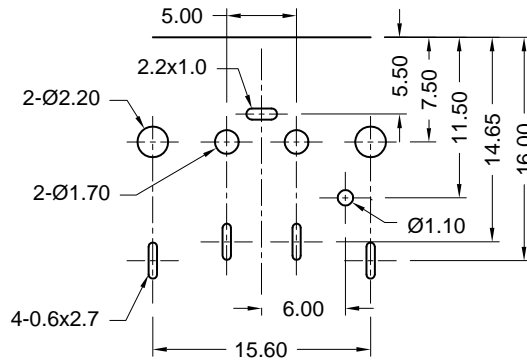
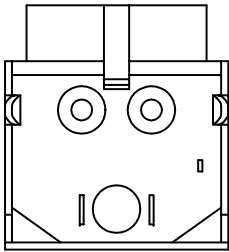

Material and Finish

Inner Shield: copper alloy,
tin plated

Outer Shield: steel, tin plated

Body: PBT thermoplastic
UL94V-0 rated
color - black

Contacts: pins 1 and 2 - brass,
tin plated
pin 3 - phosphor bronze,
tin plated

Electrical Characteristics

Contact Rating:
#1,#2: 7.5A max. @ 20V DC
#3: 1.0A max. @ 20V DC

Insulation Resistance:
50 Megohms min. at 250V DC

Dielectric Strength:
250 V AC rms for 1 minute

Contact Resistance:
50 milliohms max.

Tolerances	
X.X ± 0.25	
X.XX ± 0.15	
Unless Stated Otherwise	

REVISION	DATE	DESCRIPTION	DRAWN BY	CHECKED BY	UNITS
A3	12/13/00	Ref ECD 00-213	J. Kring	H. MA	mm
A4	7/09/01	Ref ECD 01-085	REVISED BY	CHECK DATE	DATE
A5	12/03/02	Ref ECD 02-136	T. Gokcek	12/04/02	1/22/96

KPJ-3S-S

DC Power Jack
3 position, shielded

