

807-191

TABLE I		
CLASS	SHELL MATERIAL	FINISH DESCRIPTION
C	ALUMINUM	BLACK ANODIZE FINISH
M		ELECTROLESS NICKEL FINISH
NF		OLIVE DRAB CADMINUM OVER ELECTROLESS NICKEL FINISH
ZN		ZINC-NICKEL/O. D. OVER ELECTROLESS NICKEL
Z1	STAINLESS STEEL	PASSIVATE

REVISIONS			
SYM.	DESCRIPTION	DATE	APPROVED
A	RELEASED	03/16/05	GSE
B	REVISED PER DCN 24511	08/24/05	GSE

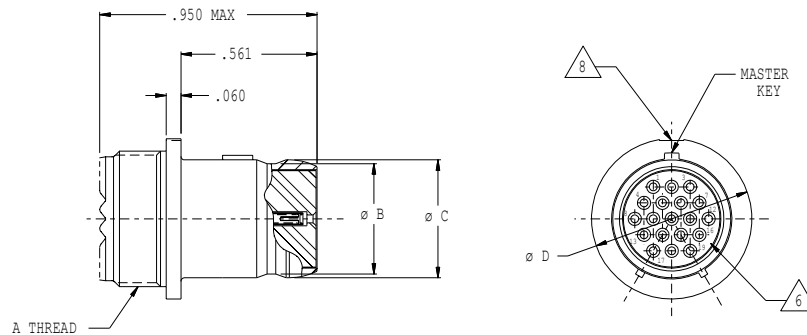

10. FOR BACKSHELL TERMINATION, REFERENCE GLENNAIR HOLDING TOOL 607-004.

9. THIS PUSH/PULL PLUG REQUIRES 10 ±4 POUNDS TO FULLY DISENGAGE CONNECTOR.

8 RED STRIPE INDICATOR FOR ALIGNMENT DURING MATING.

7. GLENNAIR SERIES OF 807-191 PLUG CONNECTOR IS DESIGNED TO MATE WITH GLENNAIR SERIES OF 807-192, OR 807-211 RECEPTACLE CONNECTOR.

6 INSERT ARRANGEMENT SHOWN IS FOR REFERENCE ONLY, SEE TABLE III.

5. CRIMP TOOL DATA (23 GA):
- a) CRIMP FRAME: M22520/2-01
 - b) POSITIONER FOR USE WITH CRIMP FRAME: GLENNAIR PART NO. 809-005.
 - c) INSERTION TOOL: GLENNAIR PART NO. 809-006 (METAL TWEEZERS TYPE TOOL).
 - d) EXTRACTION TOOL: GLENNAIR PART NO. 809-007 (METAL TWEEZERS TYPE TOOL).

4. 23 GA CRIMP BARREL ACCOMMODATES 22, 24, 26 AND 28 GAGE WIRE.

3. THE CONTACTS ARE SIZE 23 CRIMP TYPE, AND ARE USED IN A REAR RELEASE RETENTION SYSTEM. (EXCEPT FOR 9-4 ARRANGEMENT)

2. MATERIAL / FINISH:
 SHELL - AL ALLOY OR CRES/SEE TABLE I.
 INSULATORS - HIGH GRADE RIGID DIELECTRIC/N.A.
 INTERFACIAL SEAL/GROMET SEAL - FLUOROSILICONE.
 CONTACT- COPPER ALLOY / GOLD PLATE PER ASTM B 488, TYPE 3, CLASS 1.25 (.00005 MIN THK), OVER A SUITABLE UNDERPLATE.

1. ASSEMBLY TO BE IDENTIFIED WITH GLENNAIR'S NAME PART NUMBER AND DATE CODE SPACE PERMITTING.

L-3 COMM APPLICATION
 NO CHANGES PERMITTED
 UNLESS APPROVED BY
 L-3 COMM

UNLESS OTHERWISE SPECIFIED DIMENSIONS ARE IN INCHES TOLERANCES: FRACTIONS ± 1/16 DECIMALS .XX ± .030 .XXX ± .015 ANGLES ± 1°	DRAWN R L	05/13/04	GLENNAIR, INC. CAD 1997 1211 AIR WAY - GLENDALE - CALIFORNIA 91201
	CHECK		
	ENGR JLT	05/13/04	CONNECTOR PLUG, PUSH/PULL TYPE. #23 CONTACTS, CRIMP REAR RELEASE SHELL SIZE 5-15
	<i>J. Brown</i> APPROVED		
DO NOT SCALE THIS DRAWING	RELEASE DATE	06324	CODE IDENT. NO. C
B/F 04-3857 P/C 807	ORIGINAL RELEASE DATE		SIZE 807-191
	NON REPARABLE COMMERCIAL ITEM	SCALE N/A	WEIGHT N/A
			REV. B
			SHEET 1 OF 3

NOTES: UNLESS OTHERWISE SPECIFIED

TABLE II					TABLE III			
DIMENSIONS					INSERT ARRANGEMENT			
SHELL SIZE	A THREAD	ø B	ø C	ø D,MAX	SHELL SIZE	ARR NO.	CONTACT SIZE	CONTACT QTY
5	.2500-32 UNEF-2A	.220	.255	.440	5	5-3	23	3
6	.3125-32 UNEF-2A	.285	.315	.490	6	6-4	23	4
7	.4375-28 UNEF-2A	.350	.380	6-7		23	7	
9	.5625-24 UNEF-2A	.455	.485	.665	9	9-19	23	19
12	.6875-24 UNEF-2A	.645	.680	.860		9-4	16	4
14	.9375-20 UNEF-2A	.770	.800	.980	12	12-37	23	37
15	.9375-20 UNEF-2A	.830	.860	1.040	14	14-55	23	55
					15	15-85	23	85

REVISIONS			
SYM.	DESCRIPTION	DATE	APPROVED
SEE SHEET 1			

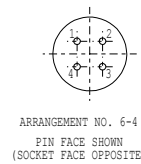
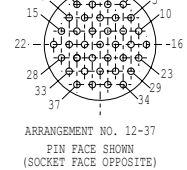
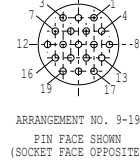
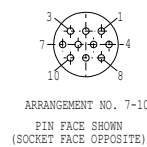
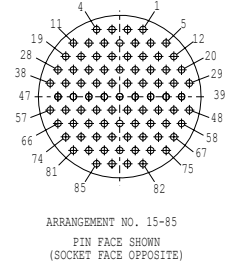
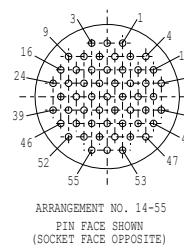
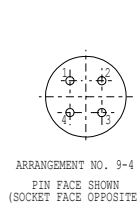

PART NUMBER DEVELOPMENT

EXAMPLE: 807-191 - 06 Z 9-19 S A A

CONNECTOR SERIES _____

SHELL STYLE _____
06 = PLUG

CLASS _____
(SEE TABLE I)

SHELL SIZE/INSERT ARRANGEMENT NO. _____
(SEE TABLE III)

CONTACT STYLE _____
S = SOCKET
P = PIN

KEY POSITION _____
A, B, C, D (SEE TABLE IV)

ADAPTER _____
A = MOLDING ADAPTER
B = MOLDING, BANDING ADAPTER
(OMIT FOR NONE)

UNLESS OTHERWISE SPECIFIED DIMENSIONS ARE IN INCHES TOLERANCES: FRACTIONS ± 1/16 DECIMALS .XX ± .010 .XXX ± .005 ANGLES ± 1°	DRWN	R L	05/13/04	GLENAIR, INC. CAD 1997 1211 AIR WAY - GLENDALE - CALIFORNIA 91201
	CHECK	ENGR	GSB	
DO NOT SCALE THIS DRAWING	 APPROVED: _____ RELEASE DATE: _____ ORIGINAL RELEASE DATE: _____			CONNECTOR PLUG, PUSH/PULL TYPE. #23 CONTACTS, CRIMP REAR RELEASE SHELL SIZE 5-15
B/F 04-3857 P/C 807 NON REPAIRABLE COMMERCIAL ITEM	SCALE	N/A	WEIGHT	N/A
	CODE IDENT. NO.	STES	807-191	REV. B
	06324	C		SHEET 2 OF 3

TABLE IV		
ALTERNATE KEY AND KEYWAY POSITION		
POSITION	A°	B°
A	150°	210°
B	75°	210°
C	95°	230°
D	140°	275°

REVISIONS			
SYM.	DESCRIPTION	DATE	APPROVED
SEE SHEET 1			

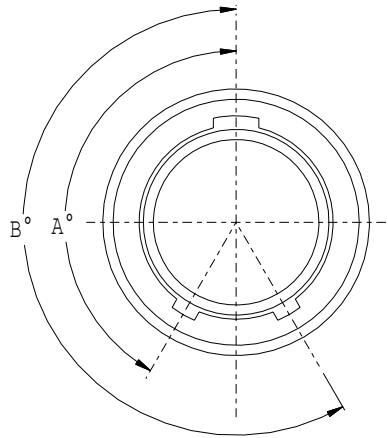

ALTERNATE POSITION
KEY ROTATION

UNLESS OTHERWISE SPECIFIED DIMENSIONS ARE IN INCHES TOLERANCES: FRACTIONS ± 1/16 DECIMALS .XX ± .030 .XXX ± .015 ANGLES ± 1°	DRAWN R L	05/13/04	GLENAIR, INC. CAD 2000 1211 AIR WAY - GLENDALE - CALIFORNIA 91201
	CHECK		
	ENGR. GSB	05/13/04	CONNECTOR PLUG, PUSH/PULL TYPE. #23 CONTACTS, CRIMP REAR RELEASE SHELL SIZE 5-15
	<i>D. Brown</i> APPROVED		CODE IDENT. NO. 06324
DO NOT SCALE THIS DRAWING	RELEASE DATE	ORIGINAL RELEASE DATE	SIZE C
B/F 04-3857	E/C 807	NON REPARABLE COMMERCIAL ITEM	SCALE N/A WEIGHT N/A SHEET 3 OF 3
			REV. B