

Coupling connectors

DCS-2 / 4.8 mm

3/6/8/10 way coupling housings for 1.5, 2.8 & 4.8 mm terminals

Features

- 3-6-8-10 position housings available
- Lateral secondary lock for terminal position assurance (T.P.A.)
- GO-NO-GO housing locking principle
- 3 position housing can be used as a modular system (to obtain a 6 position housing)
- Mechanical polarization
- Several colours available

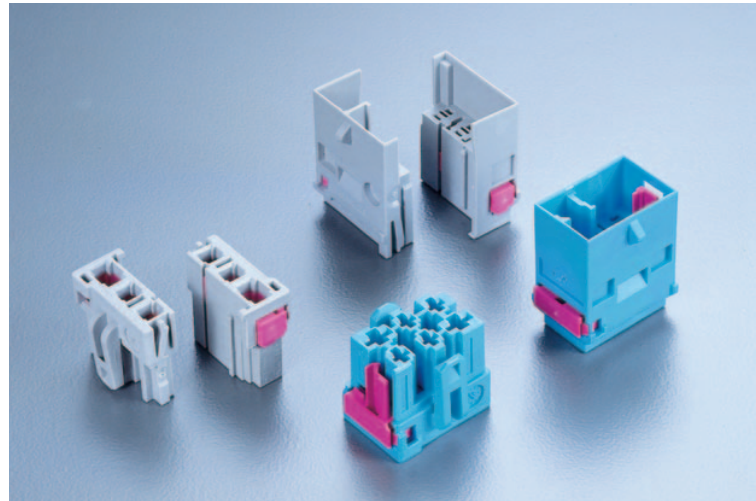

Performance characteristics

- Temperature range:
from -40°C to +120°C
- Contact retention force:
> 55 N for 1.5 mm terminals
> 80 N for 2.8 mm terminals
- Contact insertion force:
< 10 N for 1.5 mm terminals
< 15 N for 2.8 mm terminals
- Connector mating force: < 100 N

Construction

- Housing material: PBT

Tooling

- Terminal removal tool: Consult us

Connector compatibility

- Usable terminals:
 - DCS-2 1.5 mm terminals
 - DCS-2 2.8 mm terminals
 - 4.8 mm terminals

Part Numbers	No. of position	Terminal size	Type	Colour
3 023 13 01	3	2 x [2.8 mm] + 1 x [4.8 mm]	Modular female housing	Black
3 023 14 01	3	2 x [2.8 mm] + 1 x [4.8 mm]	Modular female housing	Black
3 033 04 01	3	2 x [2.8 mm] + 1 x [4.8 mm]	Modular male housing	Black
3 033 05 01	3	2 x [2.8 mm] + 1 x [4.8 mm]	Modular male housing	Black
3 020 15 01	4	4 x [2.8 mm]	Modular female housing	Black
3 020 16 01	4	4 x [2.8 mm]	Modular female housing	Black
3 031 03 01	8	8 x [2.8 mm]	Modular male housing	Black
3 023 12 01	6	4 x [2.8 mm] + 2 x [4.8 mm]	Female housing	Black
3 033 03 01	6	4 x [2.8 mm] + 2 x [4.8 mm]	Male housing	Black
3 022 01 01	10	6 x [1.5 mm] + 4 x [2.8 mm]	Female housing	Black
3 032 01 01	10	6 x [1.5 mm] + 4 x [2.8 mm]	Male housing	Black

Coupling connectors

DCS-2 / 4.8 mm

3/6/8/10 way coupling housings for 1.5, 2.8 & 4.8 mm terminals

Dimensional characteristics

3 way housings

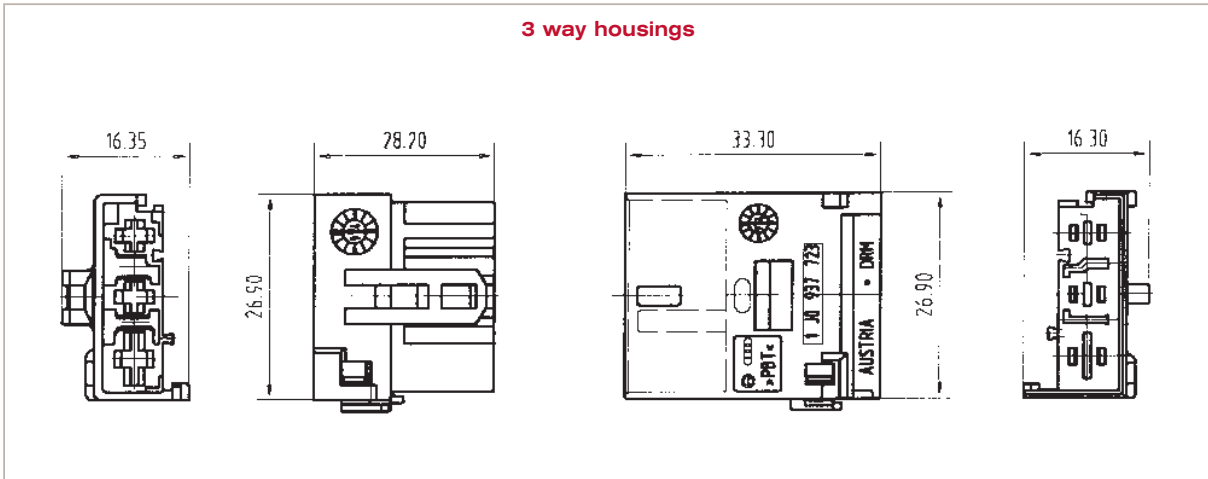

6 way housings

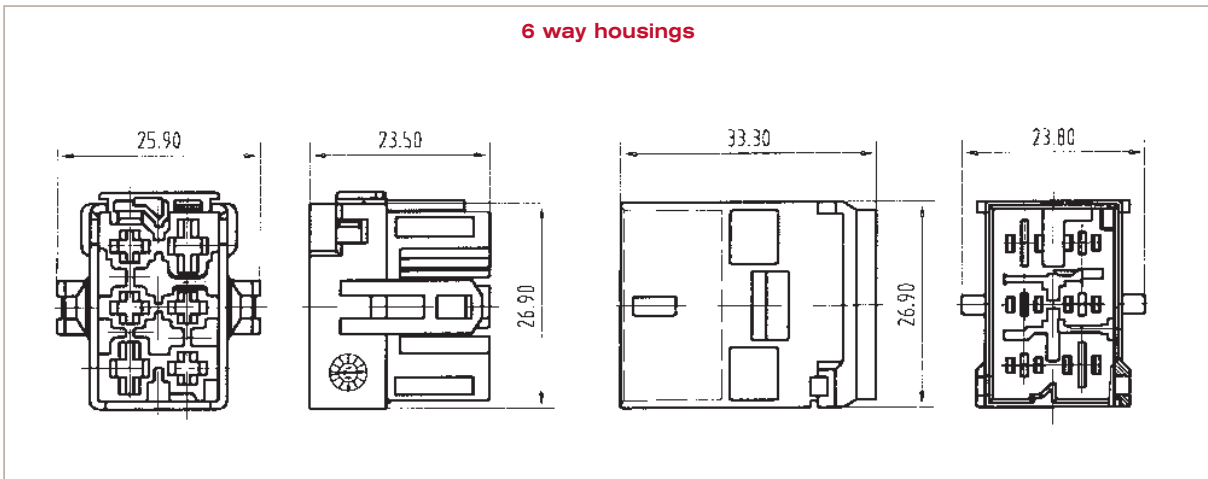

10 way housings

