

SYMBOL DEFINITION		MISSING NUMBERS	
A DIMENSION WITHOUT AN INSPECTION REPORT SYMBOL () DOES NOT REQUIRE INSPECTION. IT MAY BE CONTROLLED ON AN INDIVIDUAL COMPONENT DRAWING.	TOTAL NO. OF SYMBOLS ON DRAWING	7	
	LAST NO. USED	8	

DWG STATUS				REVISION HISTORY				DATE	BY	APP'D	REV
DATE	STG	REV	N/P	CHG	ZONE						
23AP02	R	02	-	-							
30SE04	R	02	AA	-							

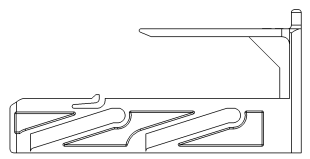

- NOTES
- UNLESS OTHERWISE SPECIFIED AND/OR INDICATED: DIMENSIONS ARE TO FACE OF VIEW SHOWN AND AUTOMATICALLY ROUNDED BY COMPUTER FOR INSPECTION (SEE MATH MODEL FOR PRECISE DIMENSIONS). FOR ALL OTHER DIMENSIONS NOT SHOWN BUT REQUIRED FOR TOOL BUILD, SEE MATH MODEL FOR PRECISE TOOL PATH DATA.
 - MATERIAL RECYCLING CODE ♻️P4666 6F14K PER SAE J1344. (2.11)X(0.11) CHARACTERS AS SHOWN TO BE LOCATED ON ANY EXTERIOR SURFACE. OPTIONAL CONSTRUCTION TO BE NO MATERIAL RECYCLING CODE.
 - THIS PART IS NOT CONTROLLED FOR AUTOMATIC FEEDING.
 - REFERENCE MATING COMPONENTS OR EQUIVALENT: STRAIN RELIEF JS318156 WIRE DRESS COVER 1519159
 - (2.3)X(0.11) DELPHI CORPORATE BRAND TO BE LOCATED ON ANY EXTERIOR SURFACE, PREFERABLY VISIBLE AT FINAL ASSEMBLY. OPTIONAL CONSTRUCTION TO BE "PED" OR NO LOGO.

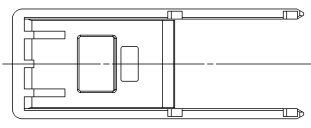
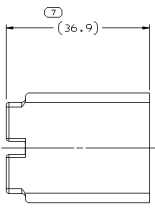
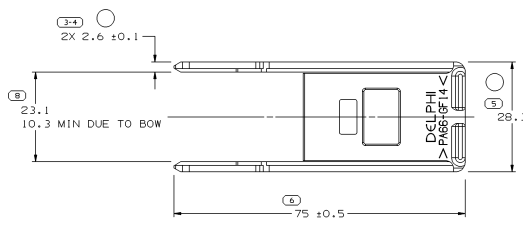
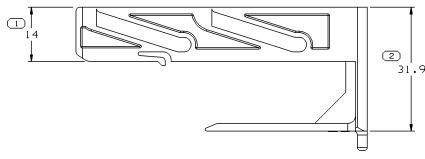
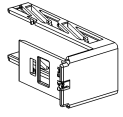

DWG TYPE		PART DRAWING	
STYLE		USER CODE	D
VOLUME (UNIT)	7,632		

UNLESS OTHERWISE SPECIFIED

THIS DRAWING IS TO BE CONSIDERED VALID UNLESS THE FOLLOWING INFORMATION IS PROVIDED: THIS DRAWING IS THE PROPERTY OF DELPHI. IT IS TO BE USED ONLY FOR THE PURPOSES SPECIFIED. IT IS NOT TO BE REPRODUCED OR TRANSMITTED IN ANY FORM OR BY ANY MEANS, ELECTRONIC OR MECHANICAL, INCLUDING PHOTOCOPYING, RECORDING, OR BY ANY INFORMATION STORAGE AND RETRIEVAL SYSTEM, WITHOUT THE WRITTEN PERMISSION OF DELPHI. ALL DIMENSIONS ARE IN MILLIMETERS.

DELPHI
DELPHI PACKAGED ELECTRIC SYSTEMS
WARREN, OH

DR	DATE
DR D. HEBERLEIN	120C98
APPROV D. HEBERLEIN	120C98
APPROV D. HEBERLEIN	120C98
APPROV J.L. CUNNINGHAM	140C98
APPROV	

SUBSTANCES OF CONCERN AND RECYCLED CONTENT PER DELPHI 10949001

MATERIAL: ♻️P4666 P4666 F14K OF 14 HS 1M YEL

DRIVING CODE: LOCK CONN LK HANDLE YEL

DRIVING NUMBER: 15355069

SIZE: A1 SCALE: 2:1 FRAME NO: 1 OF 1 SHEET NO: 1 REV: N/P

DIMENSIONAL RANGE (MM)		TOLERANCE (UNLESS OTHERWISE SPECIFIED)	
FROM	TO	TOLERANCE	PRECISION
> 0	> 25	± 0.1	F1
> 25	> 50	± 0.15	F2
> 50	> 100	± 0.2	F3
> 100	> 150	± 0.25	F4
> 150	> 200	± 0.3	F5
> 200	> 300	± 0.4	F6
> 300	> 500	± 0.5	F7
> 500	> 1000	± 0.7	F8
> 1000	> 1500	± 1.0	F9
> 1500	> 2000	± 1.2	F10

PROCESS SENSITIVE DIMENSION		REFERENCE	
DIMENSIONS ENCLOSED IN () INDICATE DIFFERENCE DIMENSIONS ARE ESTABLISHED		THIRD ANGLE PROJECTION	DO NOT SCALE
		USE MATH DATA	